



Amsterdam Road, London, E14 3UU

£1,700 Per Calendar Month





Amsterdam Road

London, E14 3UU

- IMMACULATE FIRST FLOOR FLAT
- NEWLY FITTED KITCHEN
- AVAILABLE NOW
- PARKING (communal)
- ONE BEDROOM
- BALCONY
- EPC RATING: tbc

Sandra Davidson are pleased to present this IMMACULATELY PRESENTED, first floor purpose built ONE BEDROOM flat within on a sought after private development. This development is a short distance from Canary Wharf and is close to both Crossharbour and South Quay DLR stations, providing easy into the city and City Airport.. The property has been RECENTLY REFURBISHED and benefits from gas central heating, double glazed windows, balcony with river views, communal parking. The property is AVAILABLE IMMEDIATLEY & comprises:-

£1,700 Per Calendar Month



ENTRANCE

KITCHEN/LOUNGE 13'1" x 12'10" (4.00m x 3.90m)

BEDROOM ONE 15'0" x 13'1" (4.56m x 4.00m)

BATHROOM

BALCONY 2'11" x 18'10" (0.90m x 5.73m)



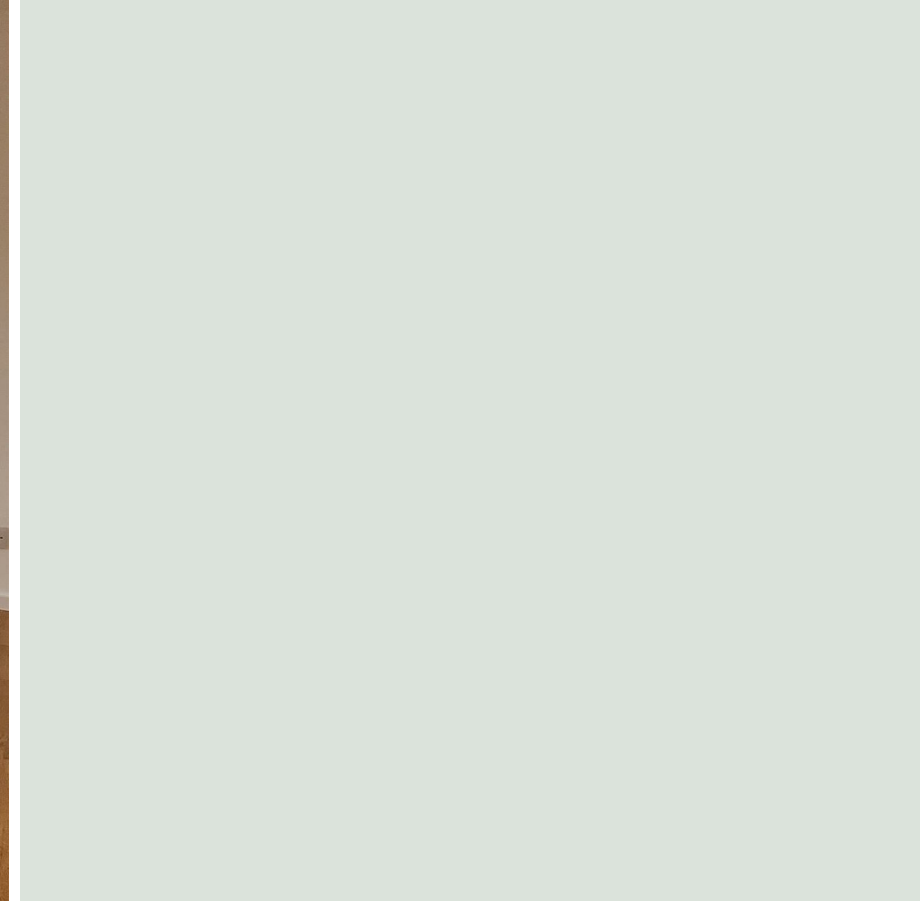

Directions





Floor Plans

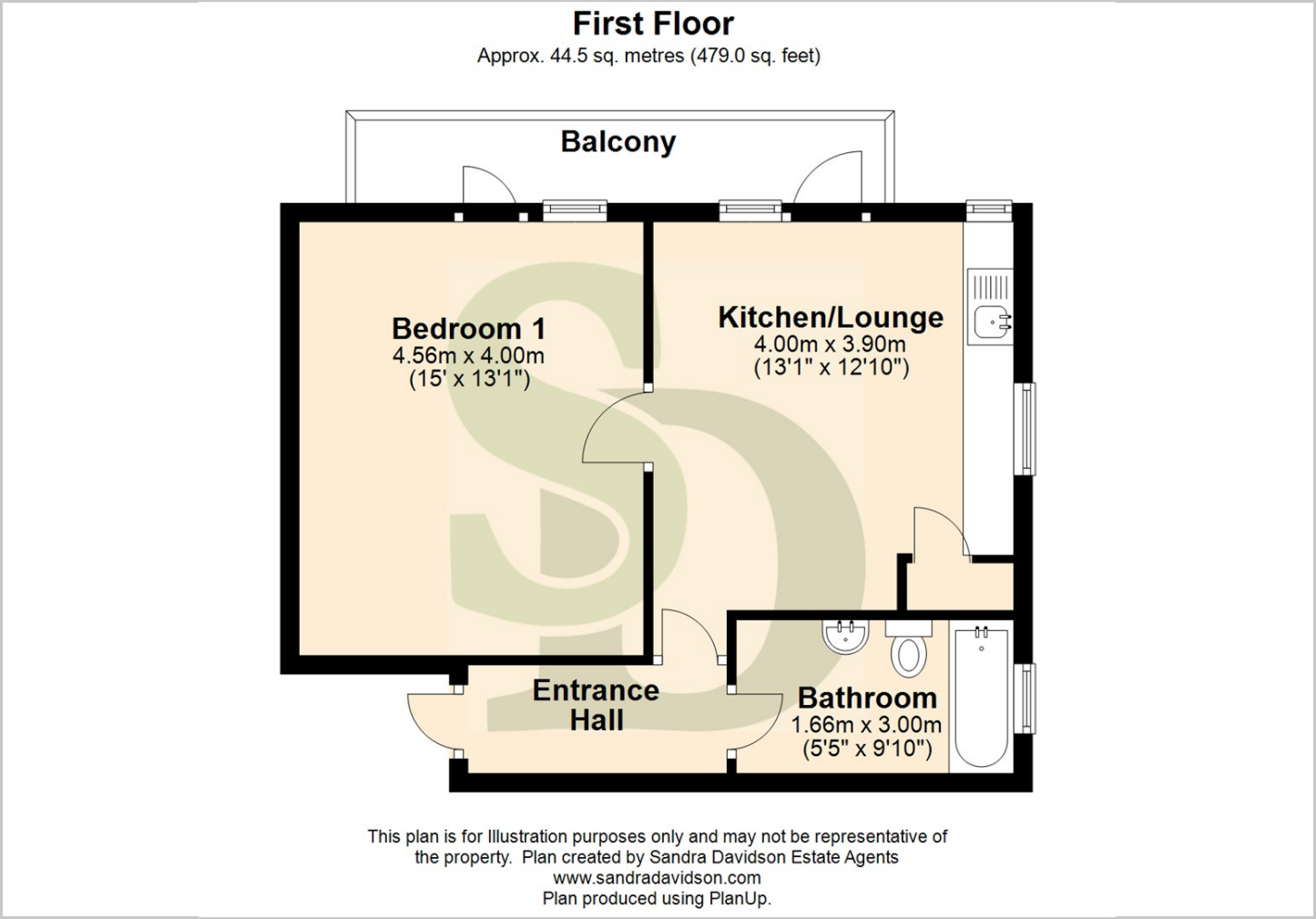

Viewing

Please contact our Redbridge Lettings Office on 020 8551 0211 if you wish to arrange a viewing appointment for this property or require further information.

The particulars are set out as a general outline only for the guidance of intended purchasers or lessees, and do not constitute, any part of a contract. Nothing in these particulars shall be deemed to be a statement that the property is in good structural condition or otherwise nor that any of the services, appliances, equipment or facilities are in good working order. Purchasers should satisfy themselves of this prior to purchasing.

10 Roding Lane South, Essex, IG4 5NX
Tel: 020 8551 0211 Email: redbridge@sandradavidson.com https://www.sandradavidson.com

Location Map

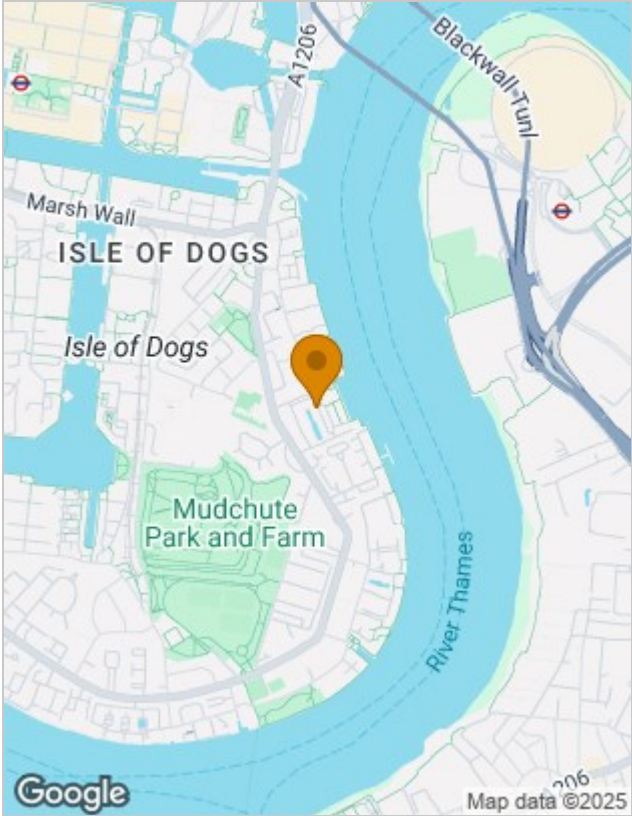

Energy Performance Graph

