



Sphere Apartments, Hainault Road, Romford, RM5 3AL

£1,500 Per Month





Sphere Apartments, Hainault Road

Romford, RM5 3AL

- Secure development
- Built in wardrobes
- Large private balcony
- Council tax band B
- Gated allocated parking bay
- Integrated kitchen appliances
- Communal roof top terrace
- EPC 82B

Sandra Davidson Estate Agents are pleased present this well-presented one bedroom larger than average apartment situated on residential turning in Collier Row, very close to Romford Town Centre.

This larger than average one bedroom apartment has its own balcony area, communal roof terrace, underground/gated parking with allocated bay. The property has been decorated to a high standard and benefits from integrated kitchen appliances.

This property is offered unfurnished and is available immediately.

£1,500 Per Month



Hallway

Bathroom

Lounge Area

Kitchen

Bedroom 1

Balcony

5'4" x 6'4" (1.62m x 1.94m)

23'4" x 10'4" (7.11m x 3.15m)

5'7" x 10'4" (1.69m x 3.15m)

15'8" x 8'10" (4.77m x 2.69m)

4'1" x 9'8" (1.25m x 2.95m)



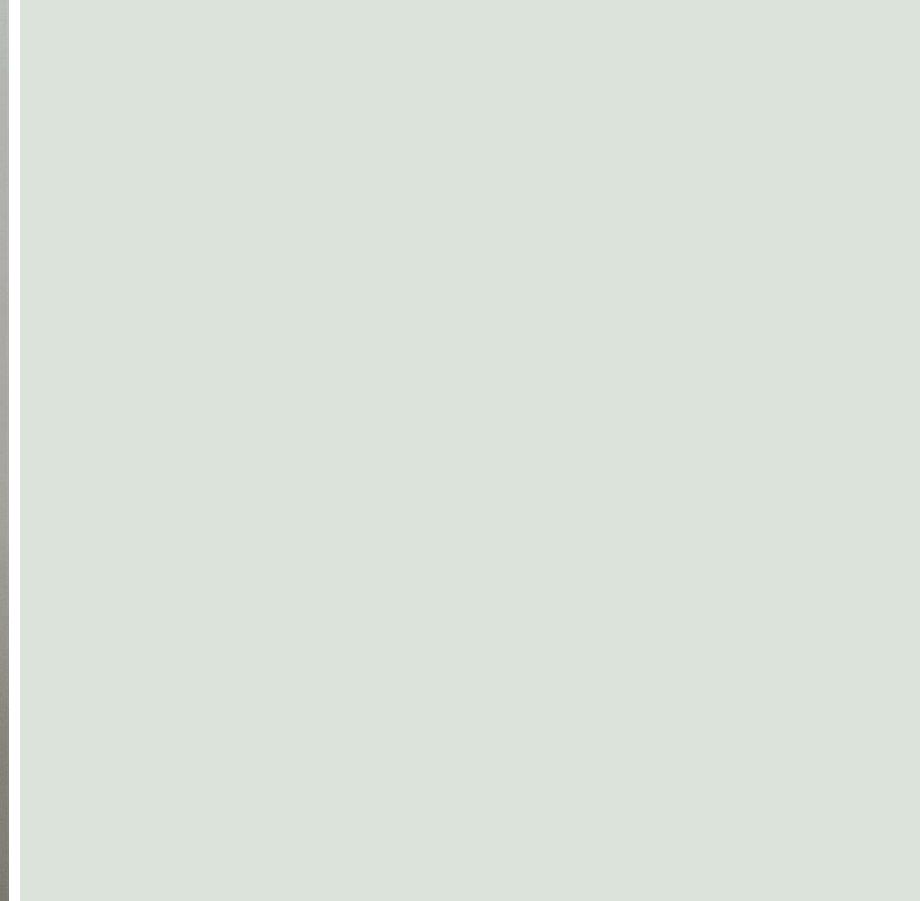

Directions

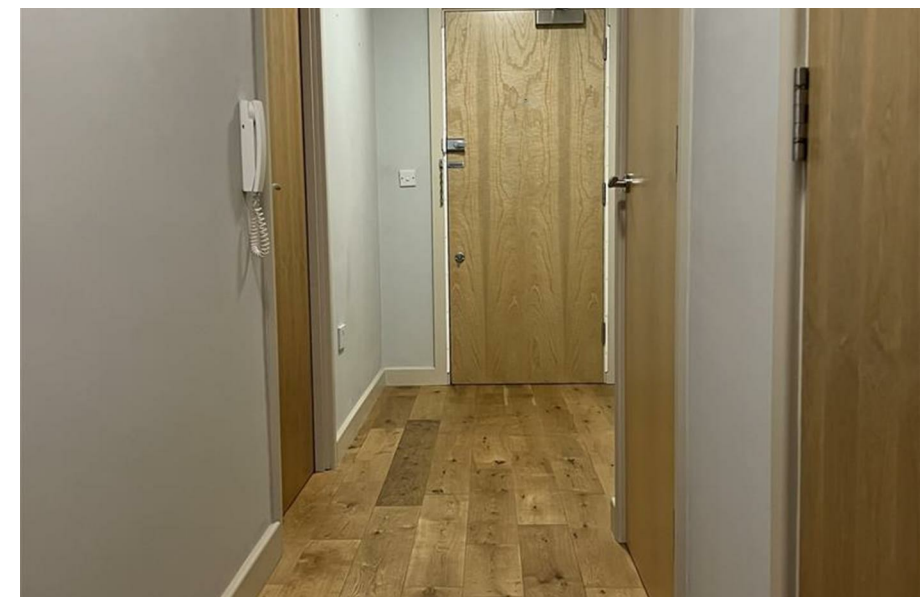



Floor Plans

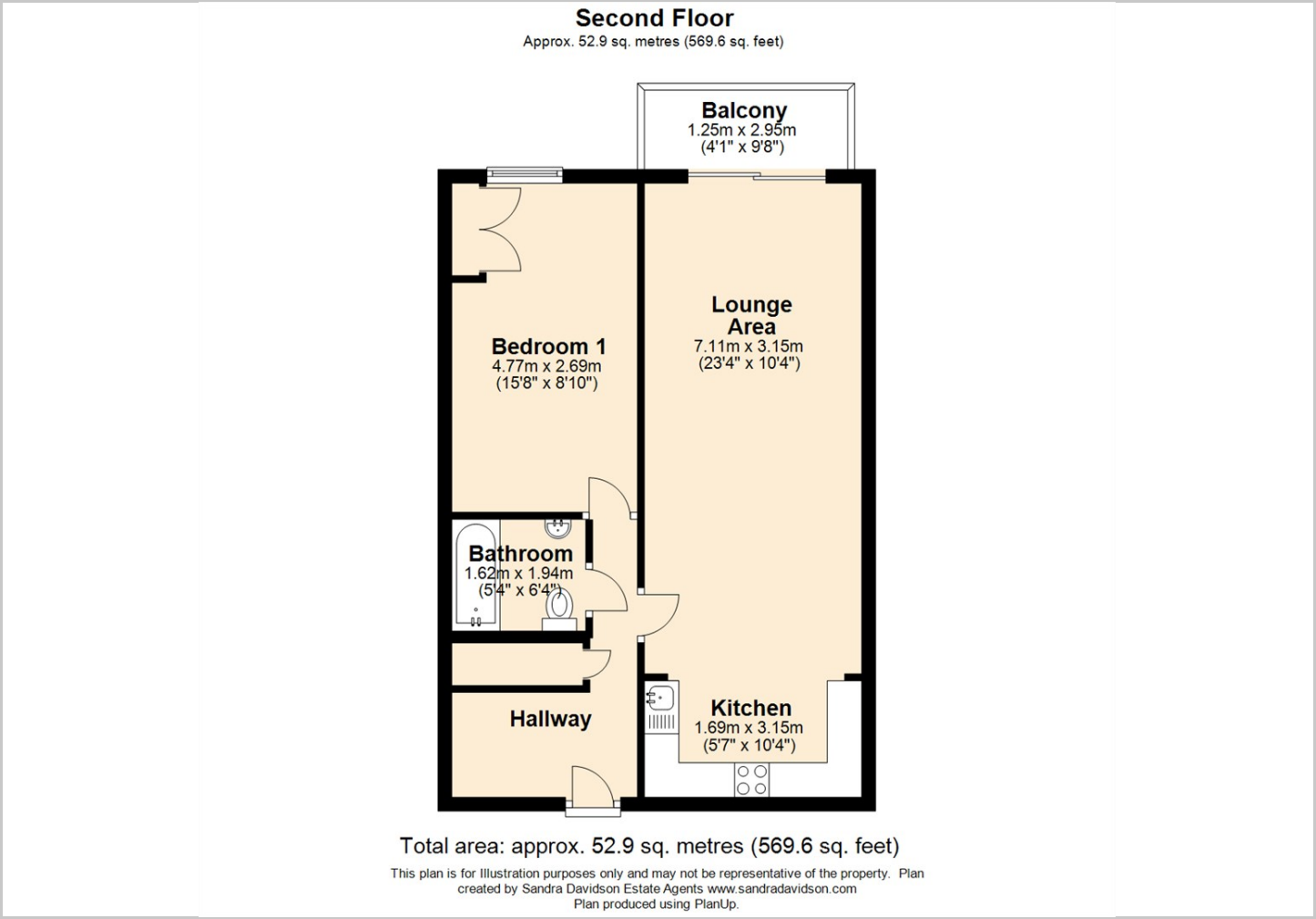

Viewing

Please contact our Redbridge Lettings Office on 020 8551 0211 if you wish to arrange a viewing appointment for this property or require further information.

The particulars are set out as a general outline only for the guidance of intended purchasers or lessees, and do not constitute, any part of a contract. Nothing in these particulars shall be deemed to be a statement that the property is in good structural condition or otherwise nor that any of the services, appliances, equipment or facilities are in good working order. Purchasers should satisfy themselves of this prior to purchasing.

Location Map

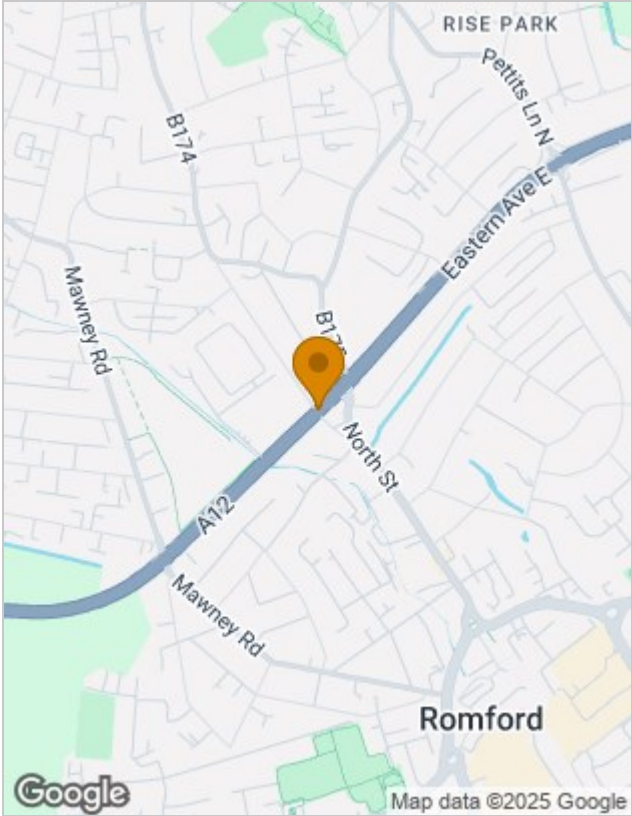

Energy Performance Graph

