



Margaret Way, Redbridge, IG4 5DD

Asking Price £200,000



Margaret Way

Redbridge, IG4 5DD

- Two Bedrooms
- Fitted Kitchen
- Own Garden
- Garage en Bloc
- 38 Year Lease Remaining
- Lounge
- Family Bathroom
- Close to Station
- Sold with Tenants in Situ
- EPC 70C

****INVESTORS AND CASH BUYERS ONLY****

***** SOLD WITH TENANTS*****

***** LOW LEASE - 39 YEARS REMAINING *****

Sandra Davidson are pleased to present an opportunity to acquire a rare two bedroom first floor maisonette situated on a very popular road in Redbridge. The property features two bedrooms, fitted kitchen, detached garage en bloc, own rear garden. The property is within the Beal school catchment area, is close walking distance to Redbridge Central Line station and can only be appreciated by an internal inspection. The property comprises:-



LOUNGE	15'0" x 13'8" (4.57m x 4.17m)
KITCHEN	10'0" x 10'11" (3.06m x 3.33m)
BEDROOM 1	15'0" x 10'6" (4.56m x 3.20m)
BEDROOM 2	11'8" x 7'4" (3.55m x 2.23m)
BATHROOM	
EXTERIOR	
ADDITIONAL INFORMATION	



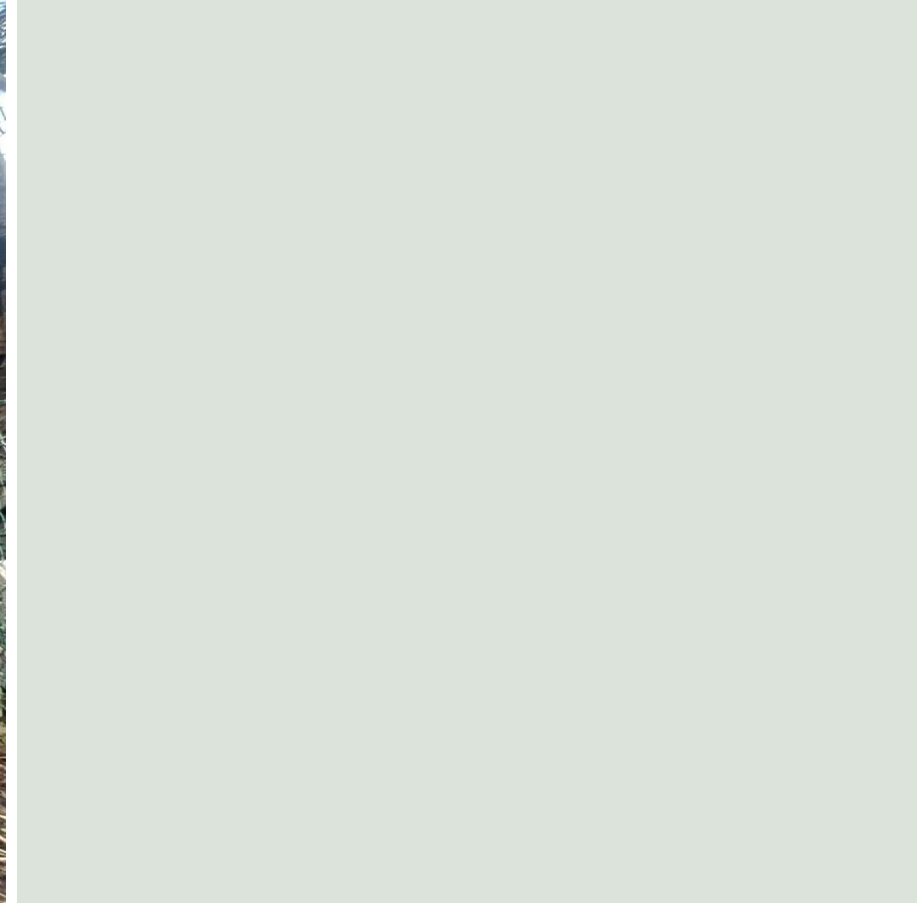

Directions



Floor Plans

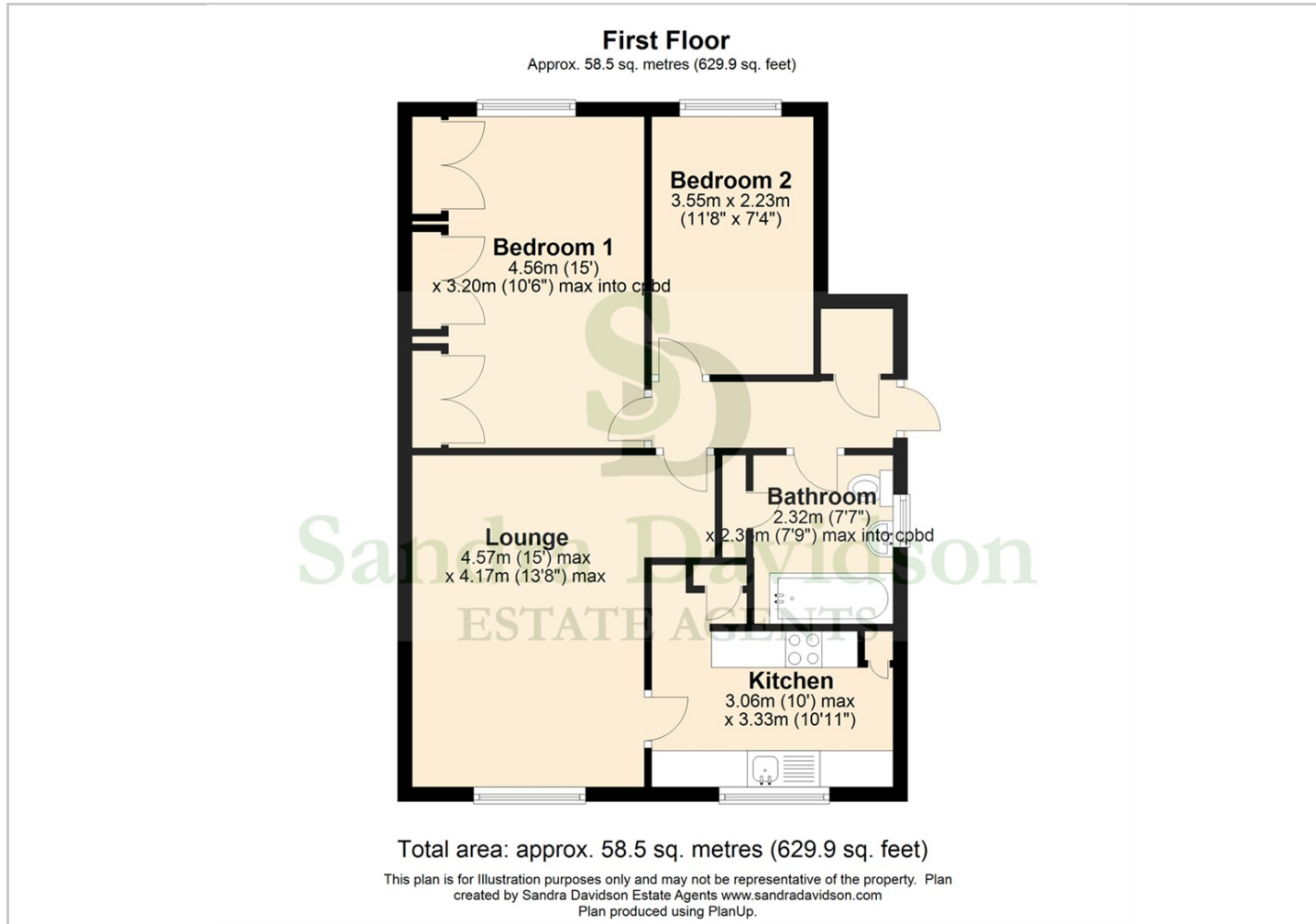

Location Map

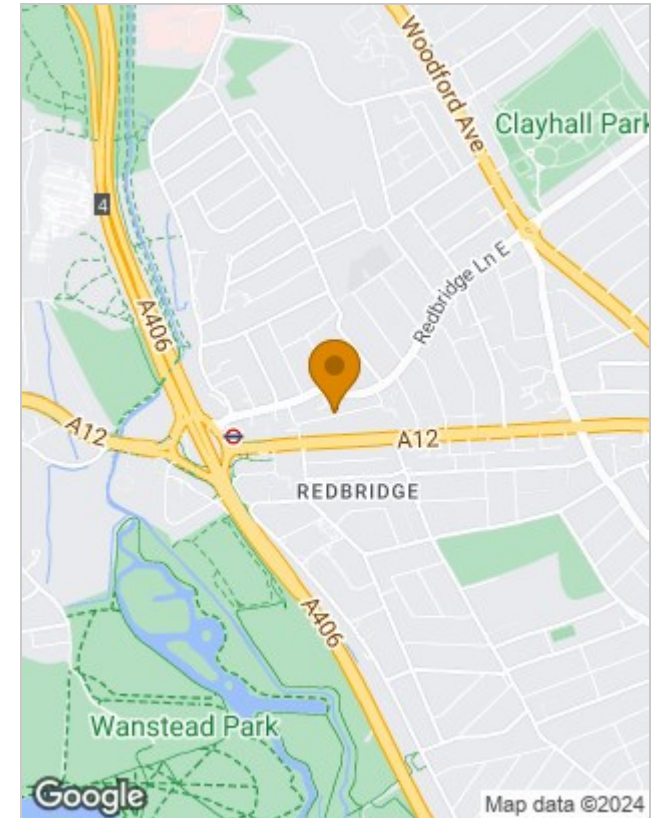

Energy Performance Graph

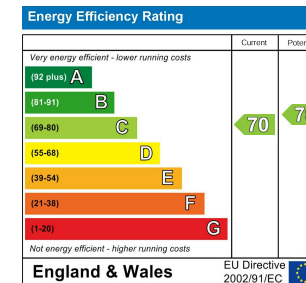

Viewing

Please contact our Redbridge Sales Office on 020 8551 0211 if you wish to arrange a viewing appointment for this property or require further information.

The particulars are set out as a general outline only for the guidance of intended purchasers or lessees, and do not constitute, any part of a contract. Nothing in these particulars shall be deemed to be a statement that the property is in good structural condition or otherwise nor that any of the services, appliances, equipment or facilities are in good working order. Purchasers should satisfy themselves of this prior to purchasing.