



## 2 Ladygate

Beverley, HU17 8BH

**£250 Per month**

A pair of inter-communicating town centre second floor offices extending to approximately 210 square feet, offered to rent including all outgoing.

Ladygate is located in the heart of the historic market town of Beverley close to St Mary's Church and Saturday Market.

The offices benefit from separate staircase access and would ideally suit a small business, beauty therapist, nail technician etc.

### Viewing

Please contact our Q & C Beverley Office on 01482 886200 if you wish to arrange a viewing appointment for this property or require further information.

## Floor Plan

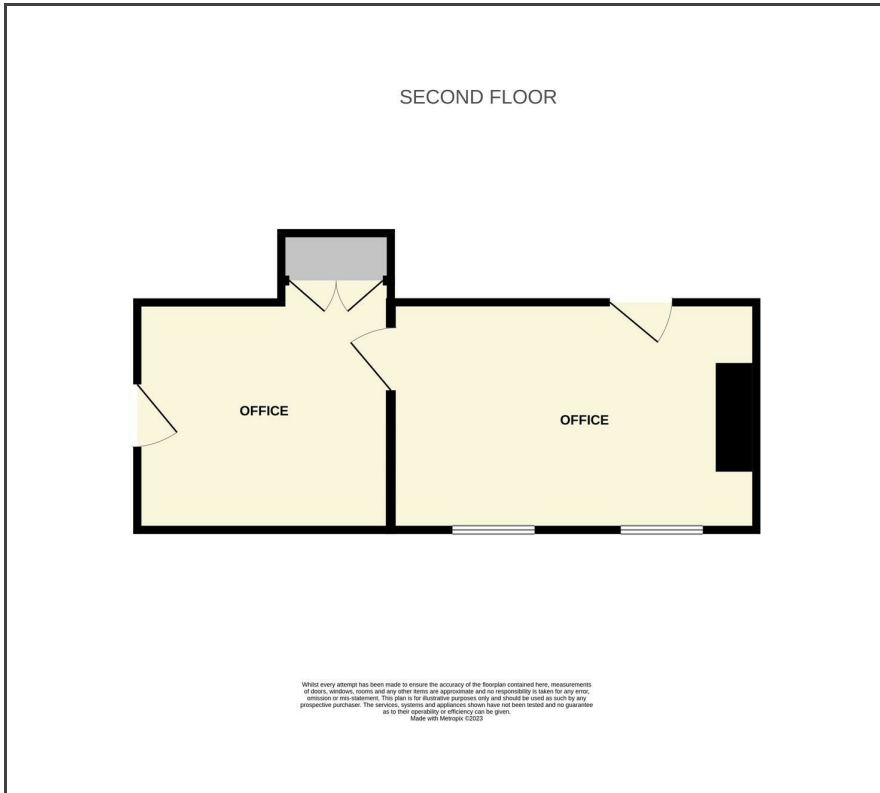

## Area Map



VIEWINGS Strictly by appointment through the Sole Agent's Beverley Office on 01482 886200. The mention of any appliances &/or services within these sales particulars does not imply they are in full and efficient working order. ALL MEASUREMENTS ARE APPROXIMATE & FOR GUIDANCE ONLY We endeavour to make our sale details accurate & reliable, but if there is any point which is of particular importance to you, please contact the office and we will be pleased to check the information. Do so, particularly if contemplating travelling some distance to view the property. NONE OF THE STATEMENTS CONTAINED IN THESE PARTICULARS ARE TO BE RELIED UPON AS STATEMENT OR REPRESENTATION OF FACT. These sales particulars are based on an inspection made at the time of instruction and are intended to give a general description of the property at the time.