





LEVERLAKE COTTAGE , LEVERLAKE ROAD

Widemouth Bay, Bude, Cornwall, EX23 0AB

Price £450,000

- Charming, detached period thatch cottage
- Walking distance of Widemouth Bay beach
- Living room with a wood burner, dining room and kitchen
- Three bedrooms, three bath/shower room
- Beautiful, landscaped gardens and off road parking

Leverlake Cottage is a charming, detached period thatch cottage, located on the edge of Widemouth Bay within walking distance of the beach and rugged coastal walks. Some of the timbers in the cottage are believed to be over 400 years old from a ship washed up on the coast.

The well-maintained accommodation offers a porch and hall, living room with original wooden boards and beam work to the ceiling, wood burning stove, dining room, kitchen, two bedrooms, bathroom, shower room and two useful attic rooms. There is a garden studio which offers the third bedroom and shower room making this the perfect guest suite.

Outside the established landscaped gardens are beautifully maintained and laid mainly to lawn with well stocked flower beds providing year-round colour.





DIRECTIONS

From the centre of town proceed out of Bude along The Strand turning right at the mini roundabout towards Widemouth. Continue along the coastal road until reaching Widemouth Bay, pass the main beach car park and then take the second left turning into Leverlake Road. Leverlake Cottage is found a short distance along on the right-hand side.

PORCH

Entering via a wooden door to the entrance porch with glazed windows to the side and rear elevations, slate tiled flooring and double glazed door opening into:-

HALL

Original wooden boards and beam work to the ceiling, tiled flooring. double glazed door with a top opening section to the rear elevation, cupboard housing the factory lagged hot water cylinder and immersion heater.

SHOWER ROOM

5' 5" x 5' 4" (1.65m x 1.63m) Double glazed window to the front elevation, wooden boards and beam work to the ceiling, aqua board panelling to the walls and tiled flooring, showing closure with mains fed shower over, vanity unit with basin and storage below, push button low flush WC and electric heated towel rail.

LIVING ROOM

14' 11" x 11' 1" (4.55m x 3.38m) Cosy dual aspect room with double glazed windows to the front and rear elevations enjoying views over the rose garden, original wooden boards and beam work to the ceiling tiled flooring, fireplace with a wooden mantle and inset wood burner which sits on a slate hearth, electric radiator and staircase ascending to the first floor.

KITCHEN

9' 10" x 6' 00" (3m x 1.83m) Double glazed window to the front elevation and high ceilings with feature beams. The kitchen is fitted with a range of matching wall and base units with work surface over, inset composite sink and drainer with mixer tap over, integrated electric oven, inset electric hob with pull-out extractor over, integrated fridge and freezer and space and plumbing for washing machine.

DINING ROOM

12' 11" x 9' 10" (3.94m x 3m) Dual aspect dining room with double glazed windows to front and rear elevations enjoying views over the gardens and countryside, high ceilings with feature beams, staircase ascending to the two attic rooms, tiled flooring, electric radiator and night storage heater.

BEDROOM TWO

13' 00" x 10' 00" (3.96m x 3.05m) A bright and spacious dual aspect double bedroom with double glazed windows to the front and side elevations enjoying views of the landscaped gardens and countryside. High ceiling with feature beams, tiled flooring, electric radiator and corner pedestal wash hand basin.

FIRST FLOOR

Door to storage cupboard and doors serve the following rooms:-

BEDROOM ONE

12' 11" x 10' 4" (3.94m x 3.15m) Double glazed window to the rear elevation enjoying views of the rose garden and countryside, window seat, vaulted ceilings with feature beams.

BATHROOM

10' 11" x 5' 9" (3.33m x 1.75m) Double glazed window to the rear elevation with slate windowsill and enjoying views over the rose garden. Panel enclosed bath with telephone mixer attachment over, pedestal wash and basin and WC.

ATTIC ROOM ONE

11' 2" x 7' 2" (3.4m x 2.18m) Vaulted ceiling with feature beams.

ATTIC ROOM TWO

9' 4" x 7' 00" (2.84m x 2.13m) Double glazed window to the side elevation overlooking the gardens and surrounding countryside, vaulted ceiling with feature beams.

GARDEN STUDIO

12' 10" x 8' 7" (3.91m x 2.62m) Entering via a UPVC door to the bedroom with UPVC double glazed window to the front elevation, beams to ceiling, electric radiator and built-in wardrobe. Door two:-

SHOWER ROOM

UPVC obscure double glazed window to the rear elevation, fully tiled walls and tiled flooring, shower enclosure with electric shower over, vanity unit with inset basin and storage below, WC and electric heated towel rail.

OUTSIDE

There is off road parking for two/three vehicles, majority of the landscaped gardens are beautifully maintained with a courtyard to the rear with a raised bed full of rose bushes. A path leads to the side garden which sides onto Leverlake Road and is laid mainly to lawn with established flowerbeds which provide year round colour and

feature gravel garden.

COUNCIL TAX

Band D

SERVICES

Main electricity. Private drainage via a septic tank. Private water via borehole.

TENURE

Freehold



Ground Floor

Approx. 72.8 sq. metres (783.7 sq. feet)



First Floor

Approx. 37.0 sq. metres (397.8 sq. feet)

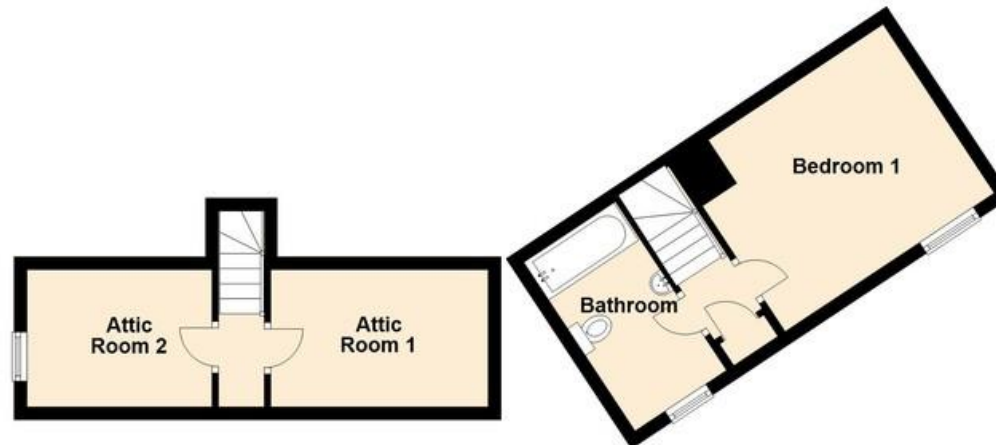

Total area: approx. 109.8 sq. metres (1181.5 sq. feet)

Colwills
Plan produced using PlanUp.





DISCLAIMER: Whilst we as agents endeavour to ensure the accuracy of property details produced and displayed, we have not tested any apparatus, equipment, fixtures and fittings or services and so cannot verify that they are connected, in working order or fit for the purpose. A buyer is advised to obtain verification from their solicitor or surveyor. References to the tenure of the property are based on the information by the seller. The agent has not had sight of the title document. The buyer is advised to obtain verification from their solicitor. Items shown in photographs are NOT included unless specifically mentioned in the sales particulars. They may however be available by separate negotiation. Buyers must check the availability of any property and make an appointment to view before embarking on any journey to see a property.

FLOOR PLANS & MAPS: Please note that if floor plans are displayed they are intended as a general guide

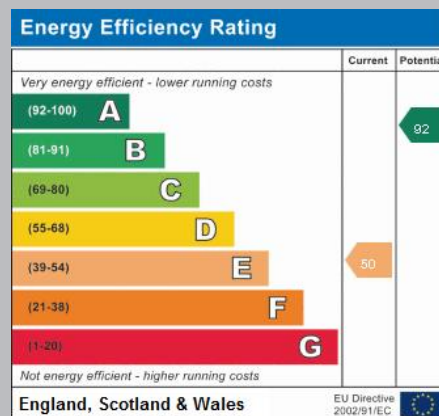

01288 355828
E: bude@colwills.co.uk
www.colwills.co.uk

32 Queen Street
Bude, Cornwall
EX23 8BB

