

20 The Crescent

Bude, Cornwall, EX23 8LE

- Freehold commercial property
- Prime location, opposite Budes tourist information centre
- Ideal investment property or owner occupier

Price £64,995



The property professionals

20 The Crescent, Bude, Cornwall, EX23 8LE

An exciting opportunity to acquire a freehold commercial premiss located on 'The Crescent', opposite Bude's tourist information centre and the main visitor car park for the town. Ideal investment property or for the owner occupier.

Directions

From the centre of town proceed out of Bude along The Strand turning right at the mini roundabout towards Widemouth Bay, the property will be found on the right, opposite the tourist information car park.

RETAIL AREA

14' 5" x 10' 7" (4.39m x 3.23m)

TENURE

Freehold

SERVICES

Mains electricity, mains water and mains drainage.

Ground Floor

Approx. 14.8 sq. metres (159.2 sq. feet)

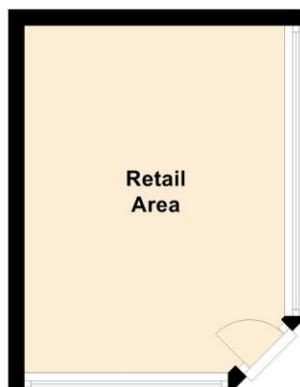

Total area: approx. 14.8 sq. metres (159.2 sq. feet)

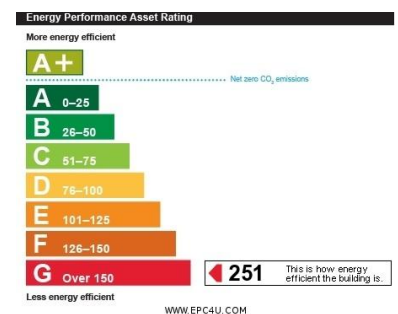

DISCLAIMER: Whilst we as agents endeavour to ensure the accuracy of property details produced and displayed, we have not tested any apparatus, equipment, fixtures and fittings or services and so cannot verify that they are connected, in working order or fit for the purpose. A buyer is advised to obtain verification from their solicitor or surveyor. References to the tenure of the property are based on the information by the seller. The agent has not had sight of the title document. The buyer is advised to obtain verification from their solicitor. Items shown in photographs are NOT included unless specifically mentioned in the sales particulars. They may however be available by separate negotiation. Buyers must check the availability of any property and make an appointment to view before embarking on any journey to see a property.

FLOOR PLANS & MAPS Please note that if floor plans are displayed they are intended as a general guide



01288 355828
E: bude@colwills.co.uk
www.colwills.co.uk

32 Queen Street
Bude, Cornwall
EX23 8BB

