



3 West Down Road, Beacon Park, Plymouth, Devon, PL2 3HF

Price £285,000

Lang town and country are delighted to offer this well-maintained property.

Ideally located within a short stroll of Central Park, highly regarded local schools, and a range of convenient shops, this stunning semi-detached home offers the perfect blend of comfort, style, and practicality. With excellent access to Plymouth city centre, it's perfectly suited for families, professionals, or anyone seeking a well-connected and desirable location.

Step inside to a welcoming hallway that sets the tone for the rest of the property. To the front, a bright and airy lounge features a charming bay window, creating a relaxing space to unwind. The heart of the home lies in the impressive open-plan kitchen and dining area, beautifully appointed with a comprehensive range of modern units and high-quality finishes. Patio doors open directly onto a raised deck, perfect for alfresco dining and entertaining, with steps leading down to a fully enclosed garden ideal for families and pets alike.

Upstairs, the first floor hosts three well-proportioned bedrooms and a stunning contemporary shower room, thoughtfully designed to a high standard.

Outside, a dedicated utility area includes a convenient dog shower – a practical and sought-after feature for pet lovers.

This is a truly exceptional home in a prime location – early viewing is highly recommended.



To view this property call Lang Town & Country Estate Agents on **01752 256000**.



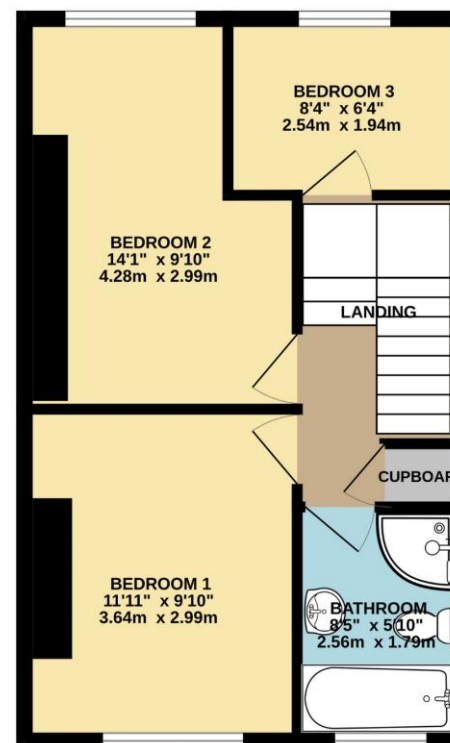
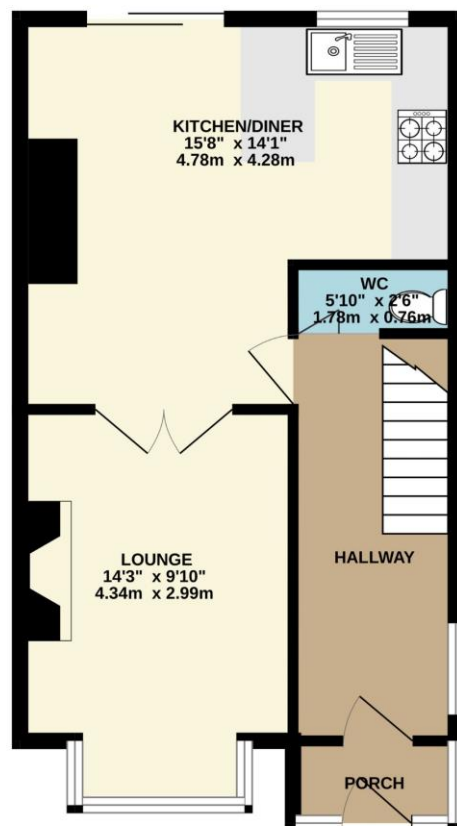

TOTAL FLOOR AREA : 845 sq.ft. (78.5 sq.m.) approx.

Whilst every attempt has been made to ensure the accuracy of the floorplan contained here, measurements of doors, windows, rooms and any other items are approximate and no responsibility is taken for any error, omission or mis-statement. This plan is for illustrative purposes only and should be used as such by any prospective purchaser. The services, systems and appliances shown have not been tested and no guarantee as to their operability or efficiency can be given.
Made with Metropix ©2025



Lang Town & Country
6 Mannamead Road
Plymouth
PL4 7AA

Tel: 01752 456000

Email: property@langtownandcountry.com

www.langtownandcountry.com

Lang Town & Country endeavour to ensure the accuracy of property details produced and displayed, we have not tested any apparatus, equipment, fixtures, fittings or services and so cannot verify that they are connected, in working order or fit for purpose. A buyer must check the availability of any property and make an appointment to view before embarking on any journey to see a property.

