



4 Devon Terrace, Peverell, Plymouth, Devon, PL3 4JD



# Guide Price £300,000

Lang Town and Country are delighted to offer this 3 bedroom family home situated in a prime residential area which overlooks Plymouth College playing fields.

Tucked away in a quiet residential street, this spacious three-bedroom terraced home offers a fantastic opportunity for buyers seeking a property to make their own. Arranged over two floors and boasting a generous floor area, this chain-free property would benefit from some upgrading and modernisation, allowing you to tailor the space to your personal taste and style.

Upon entering through the vestibule, you're welcomed into a central hallway that provides access to a well-proportioned lounge, complete with a bay window that floods the room with natural light. Adjacent to the lounge is a formal dining room, ideal for family meals or entertaining guests.

To the rear of the property, you'll find a large breakfast room leading into the kitchen – a space full of potential to create a modern, open-plan family area. A handy ground floor WC and cupboard complete the downstairs layout.

Upstairs, the property offers three well-sized bedrooms. The expansive principal bedroom spans the full width of the house at the front, with a matching bay window to mirror the lounge below. Bedrooms two and three also provide generous accommodation. The family bathroom is centrally located and accompanied by a separate WC – perfect for busy households.

Externally the property offers a rear enclosed garden which has some well stocked flower beds and a pedestrian gate providing access to the road behind.

With ample room throughout and scope to improve, this property is an excellent blank canvas for anyone with vision. Whether you're a first-time buyer, or a growing family looking to settle in a convenient location, this home has the space and flexibility to meet your needs.

Offered to the market with no onward chain, this is a rare opportunity to secure a sizeable property with great potential. Early viewing is highly recommended.



To view this property call Lang Town & Country Estate Agents on **01752 256000**.





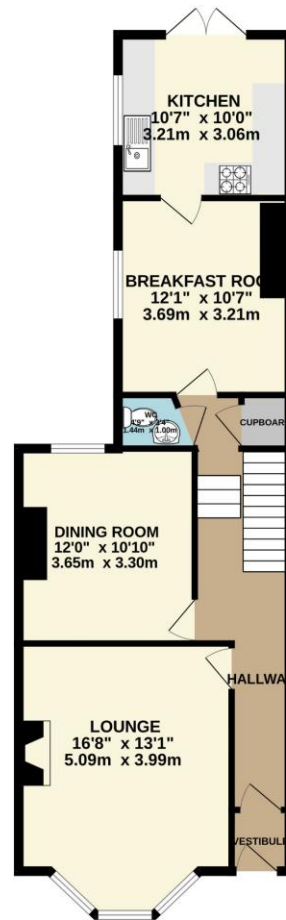

TOTAL FLOOR AREA : 1393 sq.ft. (129.4 sq.m.) approx.  
Whilst every attempt has been made to ensure the accuracy of the floorplan contained here, measurements of doors, windows, rooms and any other items are approximate and no responsibility is taken for any error, omission or mis-statement. This plan is for illustrative purposes only and should be used as such by any prospective purchaser. The services, systems and appliances shown have not been tested and no guarantee as to their operability or efficiency can be given.  
Made with Metropix ©2025



Lang Town & Country  
6 Mannamead Road  
Plymouth  
PL4 7AA  
Tel: 01752 456000  
Email: [property@langtownandcountry.com](mailto:property@langtownandcountry.com)  
[www.langtownandcountry.com](http://www.langtownandcountry.com)

Lang Town & Country endeavour to ensure the accuracy of property details produced and displayed, we have not tested any apparatus, equipment, fixtures, fittings or services and so cannot verify that they are connected, in working order or fit for purpose. A buyer must check the availability of any property and make an appointment to view before embarking on any journey to see a property.

