



68 Jackson Close, St Budeaux, Plymouth, PL5 1AS



**Price £160,000**



Nestled in the charming area of Jackson Close, Plymouth, this delightful semi-detached house offers a perfect blend of comfort and convenience. With a generous living space, the property features two well-proportioned bedrooms, a bathroom, a reception room with access on to the garden and a kitchen making it an ideal choice for small families, couples, or individuals seeking a cosy home.

The property is further enhanced by the added benefit of a garage in a block.



Its location is particularly advantageous, as it is situated close to the A38, offering easy access to nearby amenities and transport links. This makes commuting and exploring the surrounding areas a breeze.

In summary, this semi-detached house in Jackson Close presents an excellent opportunity for those looking to settle in a welcoming community in Plymouth. With its appealing features and prime location, it is a property not to be missed.

To view this property call Lang Town & Country Estate Agents on **01752 256000**

[www.langtownandcountry.com](http://www.langtownandcountry.com)





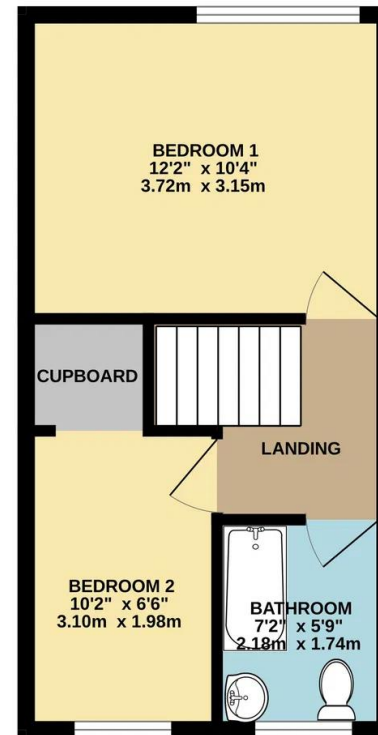
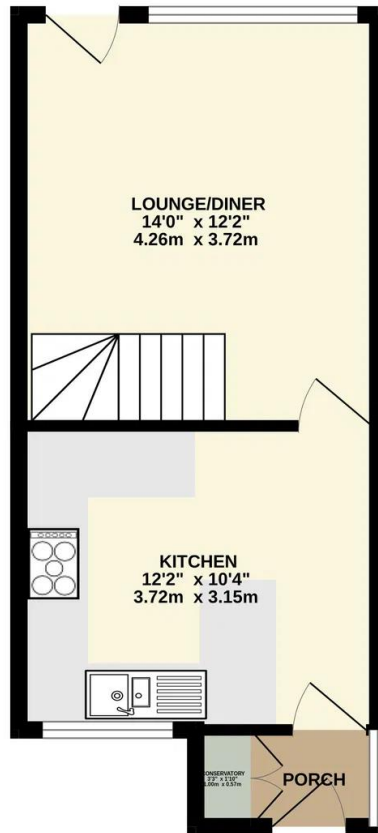

TOTAL FLOOR AREA : 613 sq.ft. (57.0 sq.m.) approx.

Whilst every attempt has been made to ensure the accuracy of the floorplan contained here, measurements of doors, windows, rooms and any other items are approximate and no responsibility is taken for any error, omission or mis-statement. This plan is for illustrative purposes only and should be used as such by any prospective purchaser. The services, systems and appliances shown have not been tested and no guarantee as to their operability or efficiency can be given.  
Made with Metropix ©2025



Lang Town & Country  
6 Mannamead Road  
Plymouth  
PL4 7AA

Tel: 01752 256000

Email: [property@langtownandcountry.com](mailto:property@langtownandcountry.com)

[www.langtownandcountry.com](http://www.langtownandcountry.com)

Lang Town & Country endeavour to ensure the accuracy of property details produced and displayed, we have not tested any apparatus, equipment, fixtures, fittings or services and so cannot verify that they are connected, in working order or fit for purpose. A buyer must check the availability of any property and make an appointment to view before embarking on any journey to see a property.

