



Flat 3, 13 Southside Street, Barbican, Plymouth, Devon, PL1 2LA

# Guide Price £230,000

Lang Town and Country are delighted to offer this stunning first floor modern apartment nestled in a coveted location in the heart of Plymouth's vibrant Barbican waterfront and close to the historic Plymouth Hoe. Comprising six recently developed units, this building boasts a contemporary and opulent aesthetic.

This beautiful apartment would be ideally suited as a luxury home or an ideal investment opportunity, as it is currently generating a substantial income as a holiday rental, due to its prime location.

Featuring two generously sized bedrooms, the two-bedroom apartments offer remarkable versatility, catering to the needs of families, professional sharers, or individuals seeking additional space for a home office or second reception room.

The heart of the apartment is its stunning open-plan kitchen/living area, adorned with high-end appliances and offering ample space for comfortable living. Large windows and patio doors flood the space with natural light while providing enchanting views of the surrounding area.

The accommodation includes two double bedrooms, one of which boasts an exquisite ensuite bathroom, while the second bedroom enjoys exclusive access to the family bathroom, both showcasing impeccable fixtures and fittings to create a serene atmosphere.

Beyond the confines of these exceptional residences lies a vibrant neighbourhood bustling with an array of bars, bistros, boutique shops, and charming coffee houses, all steeped in rich history.

## Lease Information

We understand the apartment is held on Lease with 999 years remaining and subject to a service charge of approximately £1600 per year from \*DATE\* but this is subject to change. The above information is provided in good faith although we would recommend that prospective purchasers consult their own solicitor for formal verification.

To view this property call Lang Town & Country Estate Agents on **01752 200909**





FIRST FLOOR  
723 sq.ft. (67.2 sq.m.) approx.

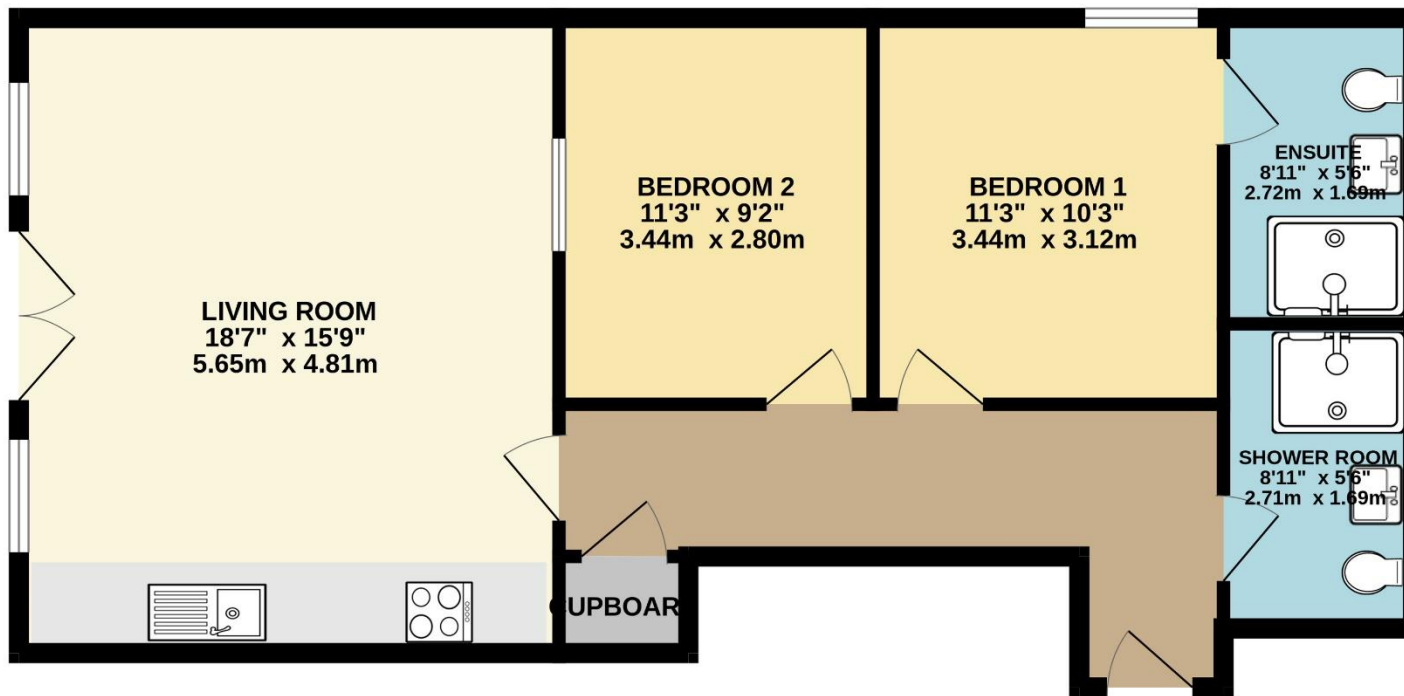

TOTAL FLOOR AREA : 723 sq.ft. (67.2 sq.m.) approx.

Whilst every attempt has been made to ensure the accuracy of the floorplan contained here, measurements of doors, windows, rooms and any other items are approximate and no responsibility is taken for any error, omission or mis-statement. This plan is for illustrative purposes only and should be used as such by any prospective purchaser. The services, systems and appliances shown have not been tested and no guarantee as to their operability or efficiency can be given.  
Made with Metropix ©2025

Lang Town & Country  
6 Mannamead Road  
Plymouth

PL4 7AA

Tel: 01752 200909

Email: [waterside@langtownandcountry.com](mailto:waterside@langtownandcountry.com)

[www.langtownandcountry.com](http://www.langtownandcountry.com)

Lang Town & Country endeavour to ensure the accuracy of property details produced and displayed, we have not tested any apparatus, equipment, fixtures, fittings or services and so cannot verify that they are connected, in working order or fit for purpose. A buyer must check the availability of any property and make an appointment to view before embarking on any journey to see a property.

