

HUNTERS[®]

HERE TO GET *you* THERE



Portmeirion Close

Bristol, BS14 9YA

£1,150 Per Month



Hunters are pleased to bring this modern one-bedroom house to the rental market. This property presents an excellent opportunity for those seeking a long-term rental. The property boasts a well-appointed reception room, providing a welcoming space for relaxation and entertaining.

The bedroom is generously sized, offering a comfortable retreat, while the bathroom is designed with contemporary fixtures, ensuring both style and functionality. One of the standout features of this home is the large rear garden, perfect for enjoying the outdoors.

This property is ideal for individuals or couples looking for a modern living space in a desirable location. With its combination of comfort, style, and outdoor space, this house is sure to appeal to those seeking a long-term residence in Bristol. Don't miss the chance to make this delightful property your new home.

Salary requirements of £34,500

No pets



Area Map



Floor Plans

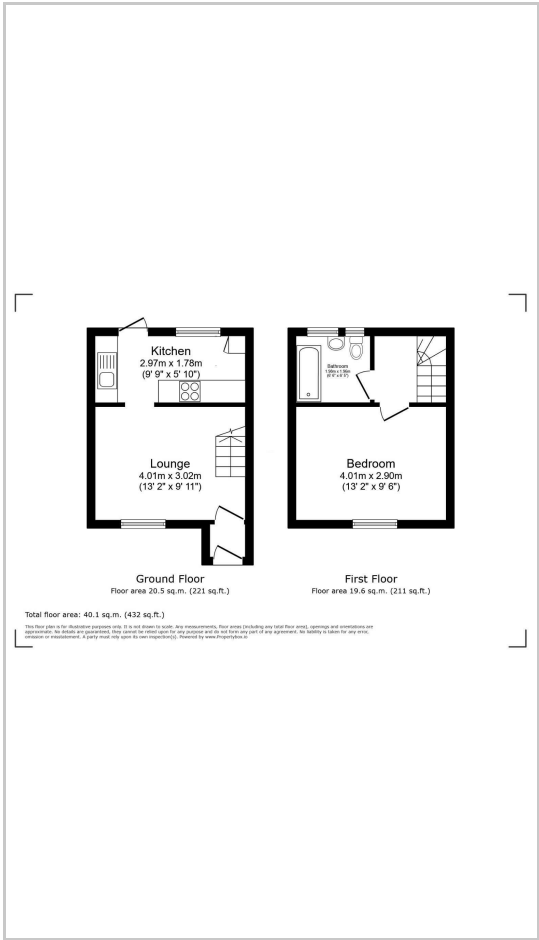

Energy Efficiency Graph

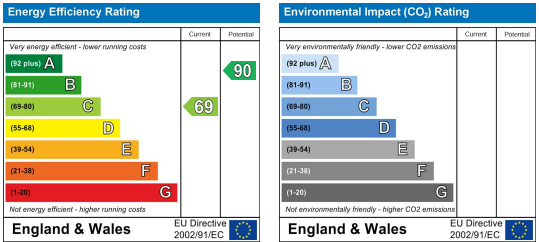

These particulars are intended to give a fair and reliable description of the property but no responsibility for any inaccuracy or error can be accepted and do not constitute an offer or contract. We have not tested any services or appliances (including central heating if fitted) referred to in these particulars and the purchasers are advised to satisfy themselves as to the working order and condition. If a property is unoccupied at any time there may be reconnection charges for any switched off/disconnected or drained services or appliances - All measurements are approximate.

THINKING OF SELLING? If you are thinking of selling your home or just curious to discover the value of your property, Hunters would be pleased to provide free, no obligation sales and marketing advice. Even if your home is outside the area covered by our local offices we can arrange a Market Appraisal through our national network of Hunters estate agents.