

# HUNTERS®

HERE TO GET *you* THERE



## Court Farm Road

Whitchurch, BS14 0EF

£1,500 Per Month



A fantastic semi-detached property, offering an ideal home for families. The residence boasts three generous reception rooms, three bedrooms, a family bathroom, and a kitchen, all designed to cater to modern living needs.

Upon entering the house, you are greeted by a light and airy lounge positioned at the front, a perfect sanctuary for relaxation. The house also benefits from a spacious dining room with a sliding door leading to a conservatory with access to the garden.

The property features a well-appointed kitchen located at the rear of the house, which can be accessed via the dining room. This kitchen is perfect for culinary enthusiasts, offering ample space for meal preparation.

The three double bedrooms are well-sized, ensuring each member of the family has their personal retreat. A family bathroom serves these rooms, offering convenience and practicality.



Area Map



Floor Plans

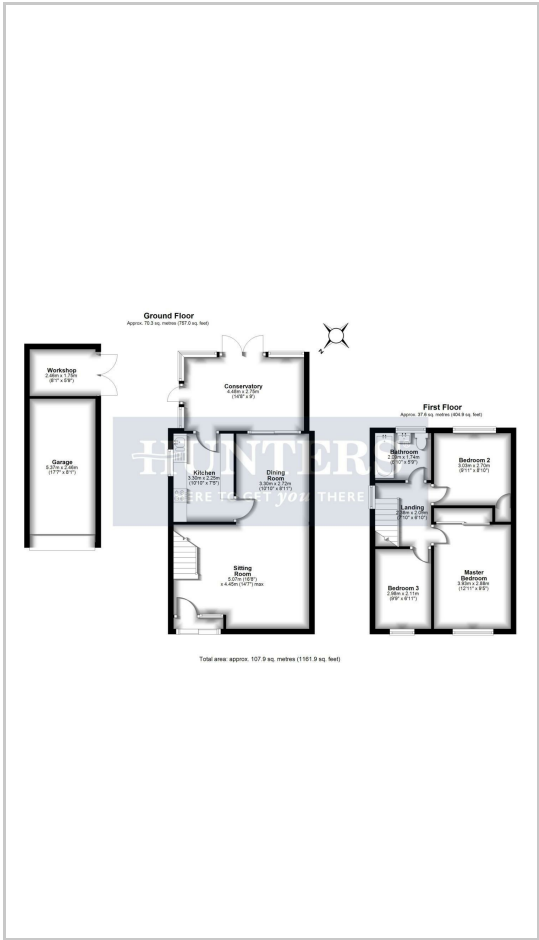

Energy Efficiency Graph

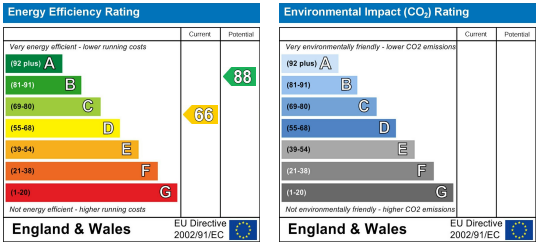

These particulars are intended to give a fair and reliable description of the property but no responsibility for any inaccuracy or error can be accepted and do not constitute an offer or contract. We have not tested any services or appliances (including central heating if fitted) referred to in these particulars and the purchasers are advised to satisfy themselves as to the working order and condition. If a property is unoccupied at any time there may be reconnection charges for any switched off/disconnected or drained services or appliances - All measurements are approximate. **THINKING OF SELLING?** If you are thinking of selling your home or just curious to discover the value of your property, Hunters would be pleased to provide free, no obligation sales and marketing advice. Even if your home is outside the area covered by our local offices we can arrange a Market Appraisal through our national network of Hunters estate agents.