



200 Homington Avenue, Coate

Swindon

£380,000

msforlane

Nestled within the popular Redrow development at Badbury Park, this stunning four bedroom home offers modern living at its finest. Immaculately presented throughout, the property boasts a thoughtfully designed layout spanning three floors. The ground floor features a welcoming entrance hall, a convenient downstairs cloakroom, an integral garage, and a fully fitted rear kitchen with contemporary finishes and patio doors opening onto a beautifully maintained garden, perfect for outdoor dining or relaxing. The first floor hosts the spacious master bedroom complete with built-in wardrobes and a beautiful en suite. A bright and airy living room with balcony access provides a tranquil outside space. On the second floor, you'll find a second en suite bedroom, two additional generous double bedrooms, and a stylish family bathroom, all offering comfort and versatility. With ample driveway parking and easy access to J15 of the M4, the Great Western Hospital, and the vibrant Old Town, this property perfectly combines convenience with modern elegance.





- Four Double Bedrooms
- Two Reception Rooms
- Three Bathrooms
- Accommodation Over Three Floors
- Garage
- Driveway Parking



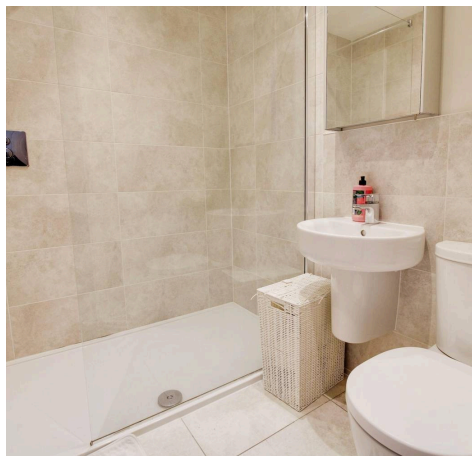

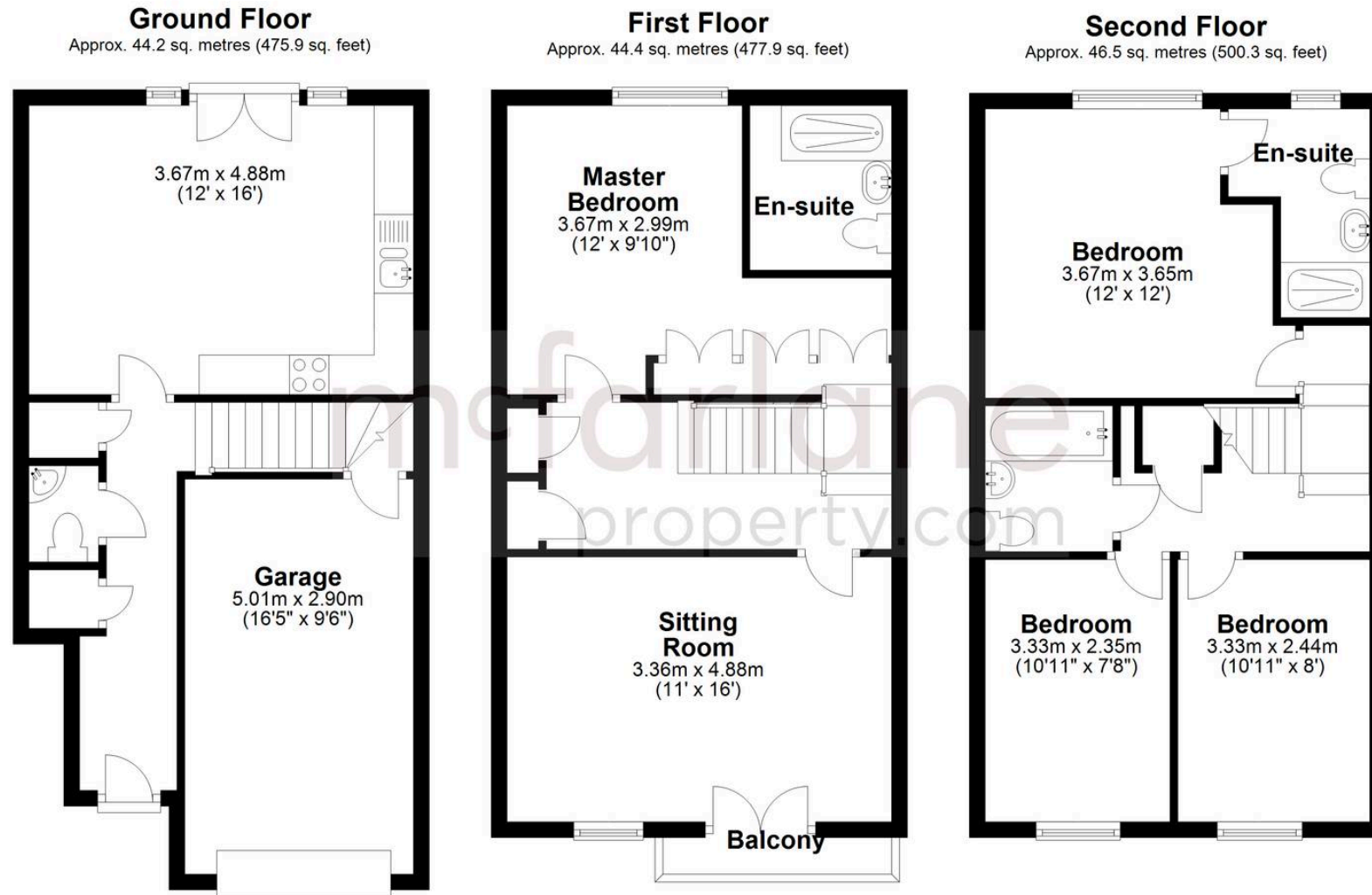

Total area: approx. 135.1 sq. metres (1454.1 sq. feet)

McFarlane Sales & Lettings

McFarlane Sales & Letting Ltd, 28-30 Wood Street – SN1 4AB

01793 296880 • oldtown@mcfarlaneproperty.com • www.mcfarlaneproperty.com/

mcfarlane
property.com