



2 Bedroom Apartment **£150,000**

Flat 2, 6 Coatley Close, Coate, Swindon, SN3 6FL

mcfarlane
property.com

2 Bedroom Apartment Swindon, Coate

-
- GROUND FLOOR APARTMENT
 - TWO DOUBLE BEDROOMS
 - WELL PRESENTED
 - ALLOCATED PARKING
 - SOUGHT AFTER LOCATION
 - MODERN KITCHEN AND BATHROOM
-

A beautifully presented ground floor apartment with open plan kitchen/ living room, two double bedrooms, three piece bathroom and allocated parking. Ideal for first time buyers and investors.



Property description

Ideally located in the sought after Coate this apartment is just a short distance from Coate Water, Great Western Hospital and Junction 16 of the M4. The property has been well maintained throughout and would make an ideal purchase for a first time buyer or investor. The apartment is on the ground floor with a welcoming entrance hall with two storage cupboards, a fitted kitchen open plan to the living room, two double bedrooms and a modern bathroom with three piece suite.



LEASE DETAILS

Lease remaining: 993 years
Annual Ground Rent: £130.00
Annual Service Charge:
£1680.00



Ground Floor

Approx. 47.5 sq. metres (511.8 sq. feet)

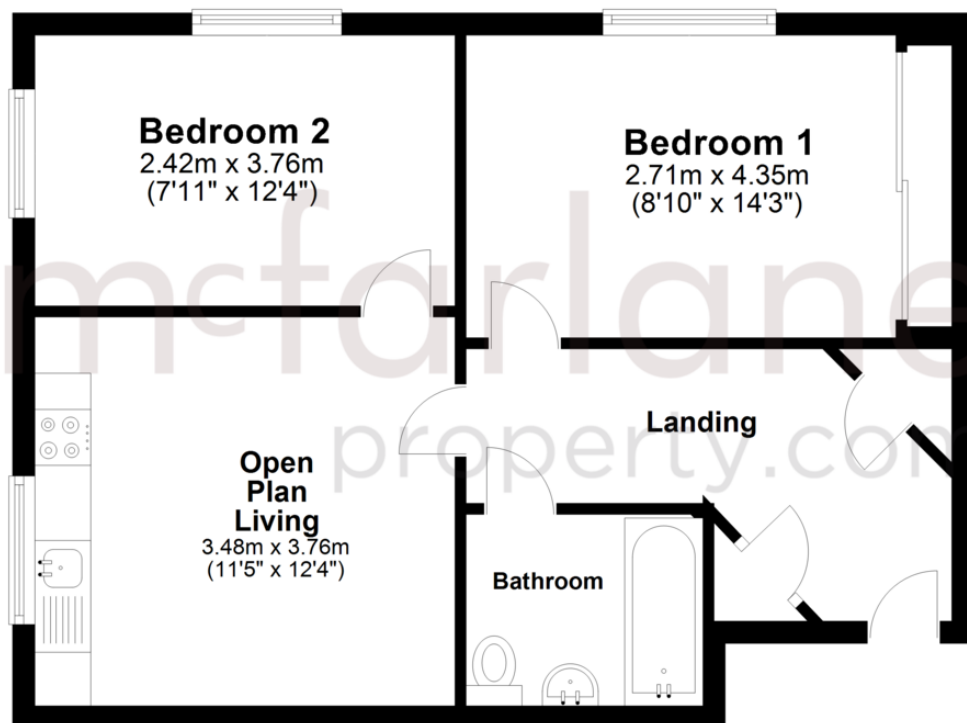

Total area: approx. 47.5 sq. metres (511.8 sq. feet)

We 
where you
LIVE

Our team are friendly, experienced and are all local. They know it better than they do their own living rooms and can help you find what you're looking for because **we love where we live.**

We would be delighted to show you around this property.

**Because every home
needs a personal touch.**

**If you would like to view this
property then please get in touch.**

 01793 296880

 oldtown@mcfarlaneproperty.com

mcfarlaneproperty.com

mcfarlane
property.com

Cricklade.

102 High Street
Cricklade SN6 6AA

 01793 751044

Marlborough.

106 High Street
Marlborough SN8 1LT

 01672 514380

Old Town.

28-30 Wood Street
Swindon SN1 4AB

 01793 296880

Swindon.

The Village Centre,
Redhouse SN25 2FW

 01793 296600

Agents Note: Whilst every care has been taken to prepare these sales particulars, they are for guidance purposes only. All measurements are approximate are for general guidance purposes only and whilst every care has been taken to ensure their accuracy, they should not be relied upon and potential buyers are advised to recheck the measurements