



3 Bedrooms Terraced House £250,000

2 Ashford Road, Swindon, SN1 3NT

mcfarlane
property.com

3 Bedrooms Terraced House
Swindon, Old Town

- NO ONWARD CHAIN
 - THREE RECEPTION ROOMS
 - THREE BEDROOMS
 - WELL PRESENTED
 - DESIRABLE LOCATION
 - REAR PARKING SPACE
 - GARAGE
-



Offered to market with no onward chain is this well presented three-bedroom Victorian terraced property in the desirable Old Town, Swindon with excellent transport links, amenities and local schools.

Accommodation briefly comprises three reception rooms, modern kitchen, three bedrooms, family bathroom, cloakroom and fully enclosed rear garden. Conveniently located with rear alleyway access, a rear parking space and garage.







Ground Floor
Approx. 53.8 sq. metres (578.6 sq. feet)

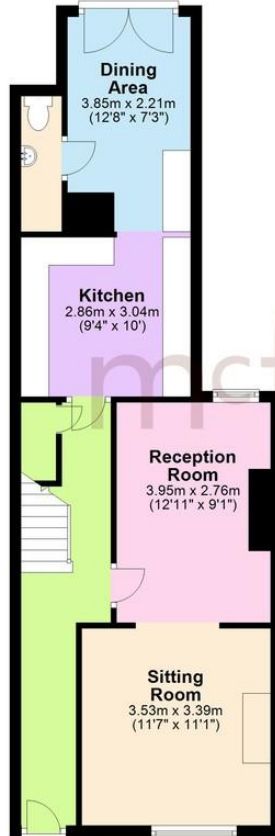

Total area: approx. 97.9 sq. metres (1053.5 sq. feet)

First Floor
Approx. 44.1 sq. metres (474.8 sq. feet)

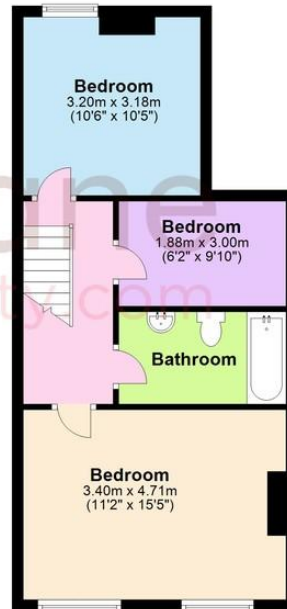

We 
where you
LIVE

Our team are friendly, experienced and are all local. They know it better than they do their own living rooms and can help you find what you're looking for because **we love where we live.**

We would be delighted to show you around this property.

**Because every home
needs a personal touch.**

**If you would like to view this
property then please get in touch.**

 01793 296880

 oldtown@mcfarlaneproperty.com

mcfarlaneproperty.com

mcfarlane
property.com

Cricklade.
102 High Street
Cricklade SN6 6AA
 01793 751044

Marlborough.
106 High Street
Marlborough SN8 1LT
 01672 514380

Old Town.
28-30 Wood Street
Swindon SN1 4AB
 01793 296880

Swindon.
The Village Centre,
Redhouse SN25 2FW
 01793 296600

Agents Note: Whilst every care has been taken to prepare these sales particulars, they are for guidance purposes only. All measurements are approximate are for general guidance purposes only and whilst every care has been taken to ensure their accuracy, they should not be relied upon and potential buyers are advised to recheck the measurements