

LANES

SALES & LETTINGS

Joanna Bufton

Lettings Consultant

LANES

SALES & LETTINGS

Tel: 01908 508037

Email: Joanna@lanesmk.co.uk



19 Rowle Close, Stantonbury, Milton Keynes, Bucks, MK14 6BJ

Lanes are pleased to advertise this two bedroom first floor flat located to the North of Central Milton Keynes in Stantonbury. The property briefly consist of: living room, Modern kitchen with white goods, two bedrooms and a bathroom. Available Beginning of August *Professionals Only* Council Tax Band A

- Two Bedrooms
- Close to Central MK
- Council Tax Band A
- First Floor Apartment
- Available Beginning of August
- Located in Stantonbury
- Modern Kitchen
- Professionals Only

£950 PCM

19 Rowle Close, Stantonbury, Milton Keynes, Bucks, MK14 6BJ
 14355621
 £950 PCM

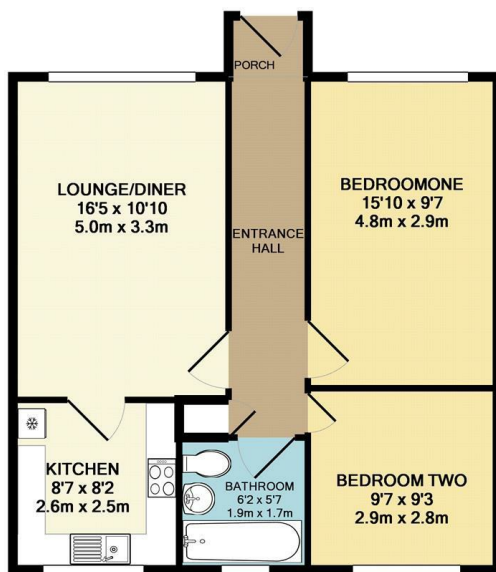

ROWLE CLOSE

Whilst every attempt has been made to ensure the accuracy of the floor plan contained here, measurements of doors, windows, rooms and any other items are approximate and no responsibility is taken for any error, omission, or mis-statement. This plan is for illustrative purposes only and should be used as such by any prospective purchaser. The services, systems and appliances shown have not been tested and no guarantee as to their operability or efficiency can be given.
 Made with Metropix ©2010

