

**LANES**

SALES & LETTINGS

Laura Hughes  
Lettings Consultant

**LANES**

SALES & LETTINGS

Tel: 01908 508032

Email: [laura@lanesmk.co.uk](mailto:laura@lanesmk.co.uk)



## 73 Quinton Drive, Bradwell Village, Milton Keynes, Buckinghamshire, MK13 9HP

Lanes are pleased to offer for rent this two bedroom mid terrace home located in Bradwell Village. The property in brief: Entrance Hall, modern Kitchen with White Goods, Living room, two Bedrooms and modern bathroom. Outside the property offers both front and rear gardens, off road parking space and single garage. Available Mid July. \*Professionals Only\* Council Tax Band B

- Two Bedrooms
- Modern Kitchen
- Located in Bradwell Village
- Single Garage
- White Goods
- Mid Terrace House
- Available Mid July
- Modern Bathroom
- Front & Rear Gardens
- Off Road Parking Space

**£1,195 PCM**

73 Quinton Drive, Bradwell Village, Milton Keynes, Buckinghamshire, MK13 9HP  
 14356219  
 £1,195 PCM

**Ground Floor**

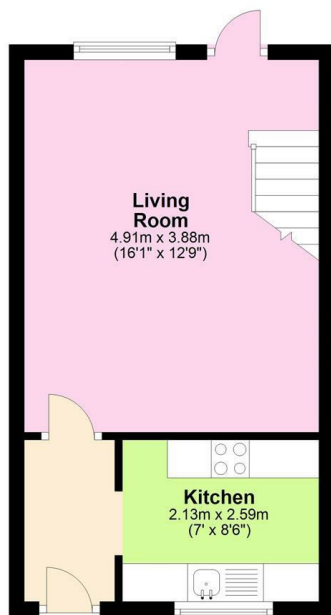

**First Floor**

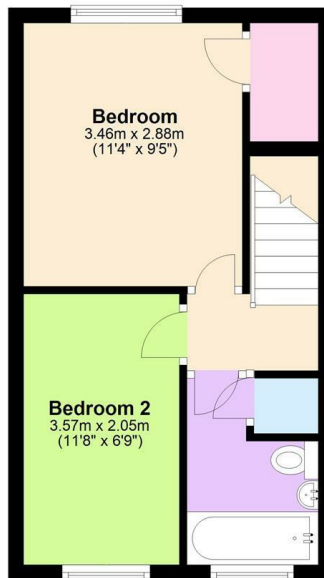

Total area: approx. 55.2 sq. metres (594.2 sq. feet)

**Ground Floor**

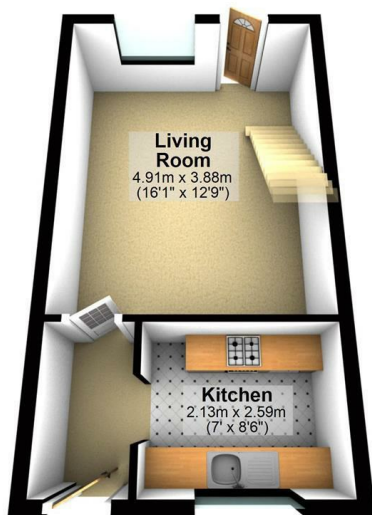

**First Floor**



Total area: approx. 55.2 sq. metres (594.2 sq. feet)

Energy Efficiency Rating	
Current	Potential
Very energy efficient - lower running costs	
(92 plus) <b>A</b>	
(81-91) <b>B</b>	
(69-80) <b>C</b>	
(55-68) <b>D</b>	
(39-54) <b>E</b>	
(21-38) <b>F</b>	
(1-20) <b>G</b>	
Not energy efficient - higher running costs	
<b>60</b>	<b>91</b>
England & Wales	
EU Directive 2002/91/EC	

Environmental Impact (CO <sub>2</sub> ) Rating	
Current	Potential
Very environmentally friendly - lower CO <sub>2</sub> emissions	
(92 plus) <b>A</b>	
(81-91) <b>B</b>	
(69-80) <b>C</b>	
(55-68) <b>D</b>	
(39-54) <b>E</b>	
(21-38) <b>F</b>	
(1-20) <b>G</b>	
Not environmentally friendly - higher CO <sub>2</sub> emissions	
<b>56</b>	<b>92</b>
England & Wales	
EU Directive 2002/91/EC	