

LANES



64 Pettingrew Close, Walnut Tree, Milton Keynes, Buckinghamshire, MK7 7LL

Lanes are delighted to offer for rent this well presented two bedroom end of Terrace House located in Walnut Tree, with private rear garden and allocated parking.

Briefly the property consists of modern kitchen/diner with oven only, living room, two double bedrooms and family bathroom. Local shops and amenities within walking distance along with fantastic local schools. Professionals Only available Mid June. Council Tax Band B

- Two Bedrooms
- Oven Only
- Rear Spacious Garden
- Council Tax Band B
- End Of Terrace House
- Allocated Parking
- Available Mid June
- Modern Kitchen
- Located In Walnut Tree
- Professionals Only

£1,250

64 Pettingrew Close, Walnut Tree, Milton Keynes, Buckinghamshire,

MK7 7LL

Marketing information

Lanes Sales and Lettings are a member of The Property Ombudsman Redress Scheme. Contact 01722 333306

Tenants deposit are registered with the Tenants Deposit Scheme. Contact 0300 037 1000





Ground Floor

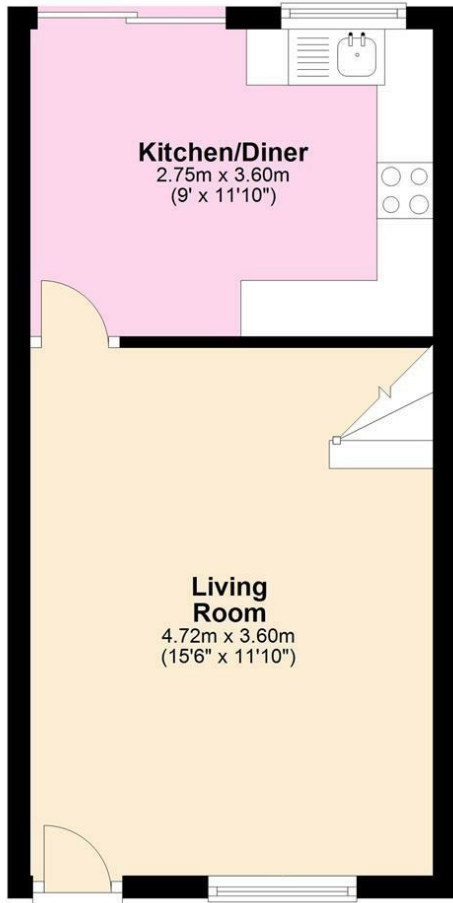

First Floor

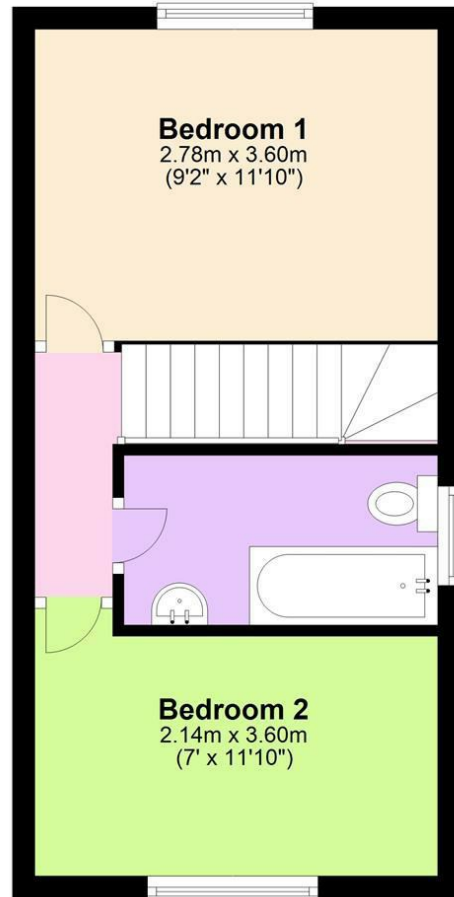

Energy Efficiency Rating		Current	Potential
Very energy efficient - lower running costs			
(92 plus) A			88
(81-91) B			
(69-80) C			
(55-68) D			
(39-54) E		42	
(21-38) F			
(1-20) G			
Not energy efficient - higher running costs			
England & Wales		EU Directive 2002/91/EC	

Environmental Impact (CO ₂) Rating		Current	Potential
Very environmentally friendly - lower CO ₂ emissions			
(92 plus) A			
(81-91) B			
(69-80) C			
(55-68) D			
(39-54) E			
(21-38) F			
(1-20) G			
Not environmentally friendly - higher CO ₂ emissions			
England & Wales		EU Directive 2002/91/EC	