



Whittington Road, Bowes Park, N22

Guide Price £495,000



Whittington Road, Bowes Park, N22



Description

****INVESTORS ONLY**** Homelink are pleased to present this lovely two bedroom ground floor garden flat set within a converted period residence.

The property comprises of a separate reception room, two bedrooms, fitted kitchen/breakfast room, tiled bathroom suite and direct access to own rear garden and patio. Other benefits include wooden flooring, double glazing, gas central heating throughout and off street parking.

The property is to be sold with the tenants in situ. Speak to one of our sales team for more information including current monthly rental.

To arrange an internal inspection, call and speak to one of friendly sales team.

Tenure: New 999 Year Lease

Ground Rent: Zero

Service Charge: c. £1,500

Haringey C/Tax Band - C

****AGENTS NOTE:** Photos shown were taken before current tenants occupation.

- Investors Only
- Ground Floor 2 Bed Flat
- D/Glazing & Gas C/Heating
- Own Rear Garden
- Great Road & Transport Links
- One Off Street Parking Space
- No Service Charge or G. Rent
- New 999 Year Lease





Floor Plan

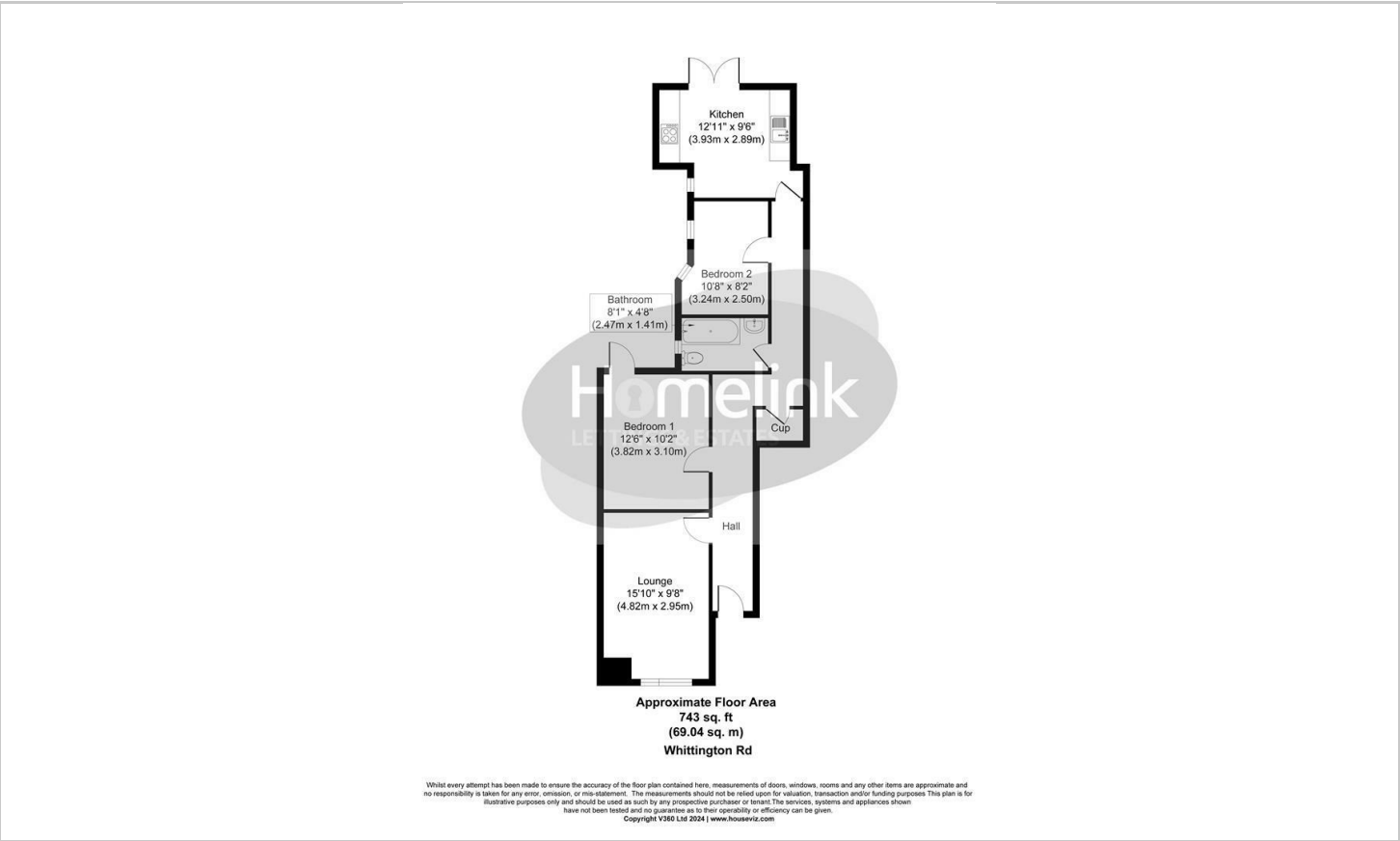

Area Map

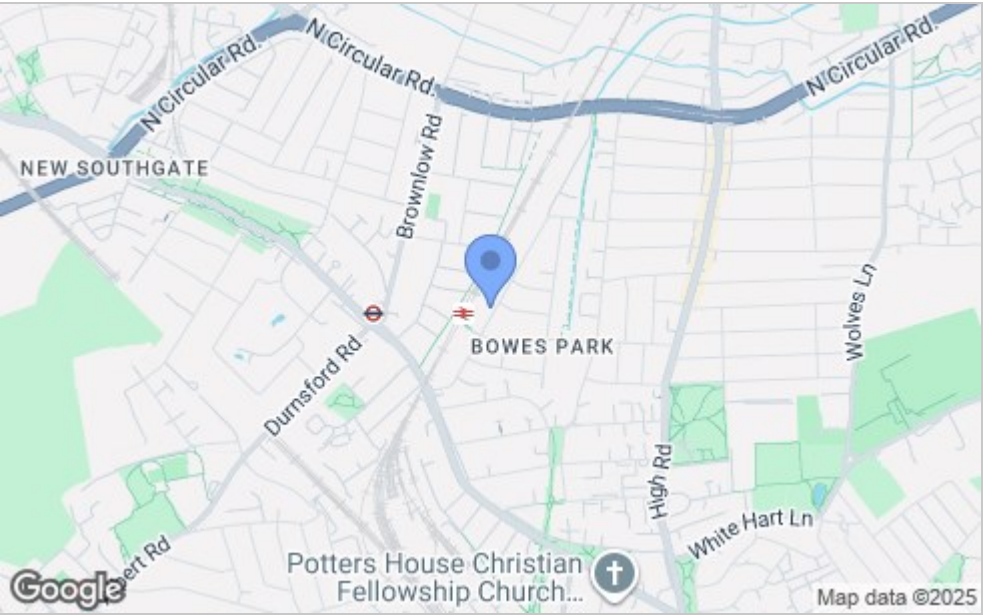

Viewing

Please contact our Homelink Lettings & Estates Office on 0208 882 2112 if you wish to arrange a viewing appointment for this property or require further information.

These particulars, whilst believed to be accurate are set out as a general outline only for guidance and do not constitute any part of an offer or contract. Intending purchasers should not rely on them as statements of representation of fact, but must satisfy themselves by inspection or otherwise as to their accuracy. No person in this firms employment has the authority to make or give any representation or warranty in respect of the property.

Energy Efficiency Graph

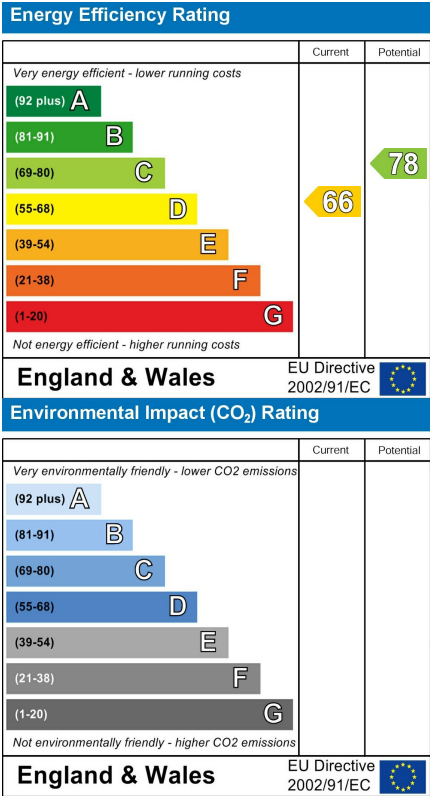

Homelink Lettings and Estates
62 Chase Side, London N14 5PA
0208 882 2112 homelink.co.uk

