



Urban House, Chase Side, Southgate, N14

£1,850 Per Month

2 2 1 D

Floor Plan

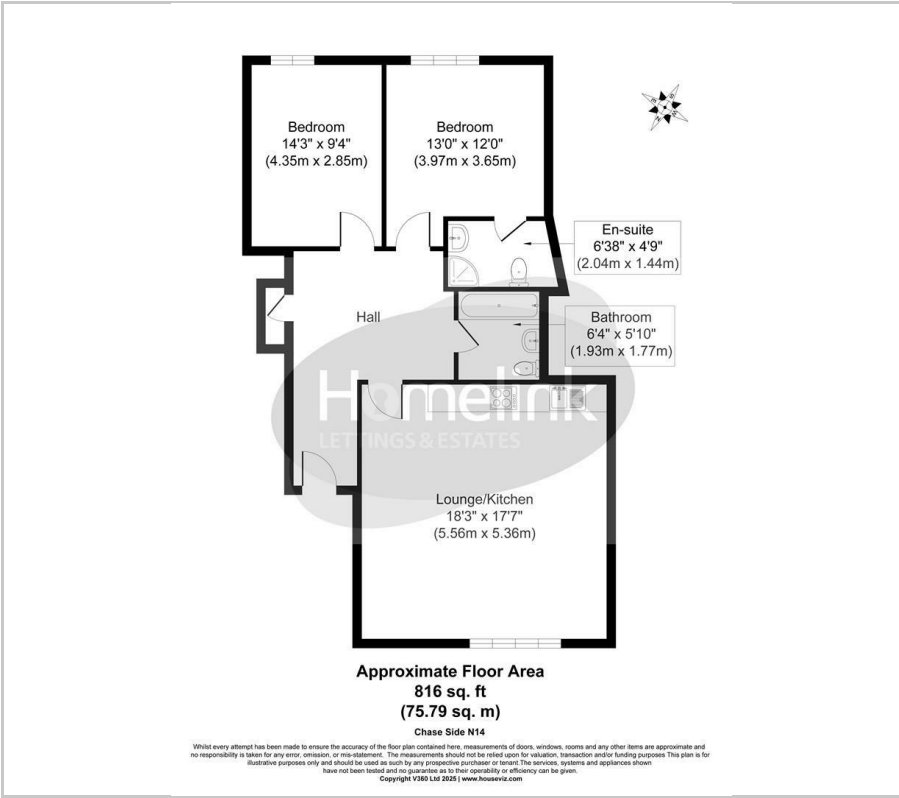

Area Map



Energy Efficiency Graph

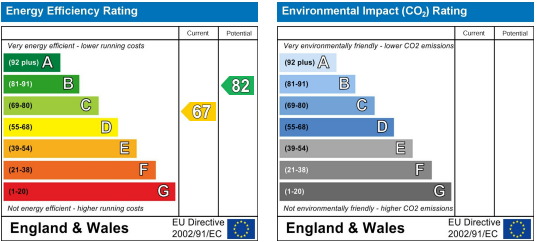

Viewing

Please contact our Homelink Lettings & Estates Office on 0208 882 2112 if you wish to arrange a viewing appointment for this property or require further information.

- Two bedroom Property
- Close to Southgate tube station
- Fully fitted kitchen including white goods
- Furnished
- En-Suite in master bedroom
- Second floor flat
- Ideal for working professionals
- Available from the beginning of July 2025
- Wifi & Water included!
- Enfield council tax band E - £2,644.91

****WIFI & WATER INCLUDED**** Welcome to this charming two-bedroom flat located on the second floor of 7 Chase Side Urban House in the desirable area of Southgate, London. This property is perfect for working professionals seeking a comfortable and convenient living space.

As you enter the flat, you will find a spacious reception room that offers a warm and inviting atmosphere, ideal for relaxation or entertaining guests. The flat boasts two well-proportioned bedrooms, with the master bedroom featuring an en-suite bathroom, providing added privacy and convenience. The second bathroom serves the rest of the flat, ensuring that all residents have easy access to facilities.

One of the standout features of this property is its prime location. Situated close to Southgate station, residents will benefit from excellent transport links, making commuting to central London and beyond a breeze. The surrounding area offers a variety of local amenities, including shops, restaurants, and parks, enhancing the overall living experience.

This flat is an excellent choice for those looking for a modern and comfortable home in a vibrant community. With its appealing layout and convenient location, it is sure to attract interest from professionals seeking a stylish and practical living space. Do not miss the opportunity to make this delightful flat your new home.



These particulars, whilst believed to be accurate are set out as a general outline only for guidance and do not constitute any part of an offer or contract. Intending purchasers should not rely on them as statements of representation of fact, but must satisfy themselves by inspection or otherwise as to their accuracy. No person in this firm's employment has the authority to make or give any representation or warranty in respect of the property.

Homelink Lettings and Estates
62 Chase Side, London N14 5PA
0208 882 2112 homelink.co.uk

