



Lyndum Court, Lordship Lane, N22

Offers In The Region Of £399,995



Floor Plan

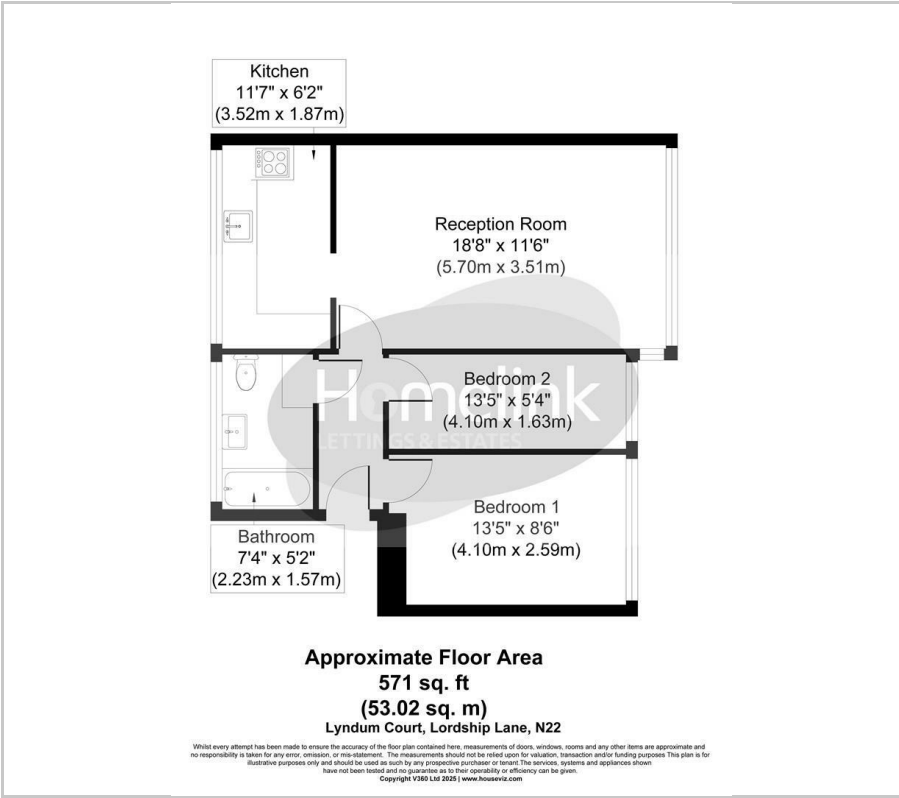

Area Map

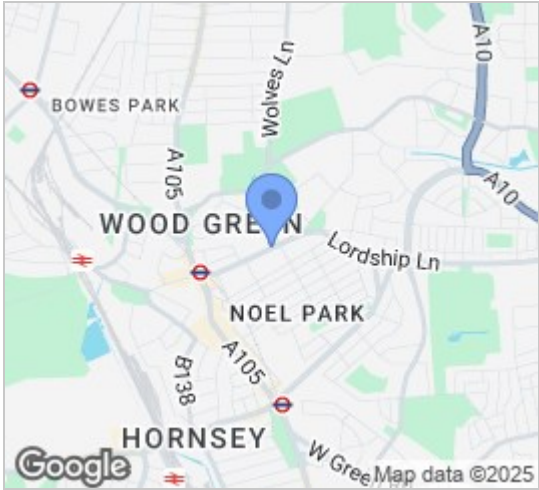

Energy Efficiency Graph

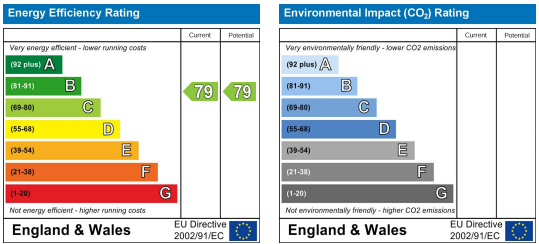

Viewing

Please contact our Homelink Lettings & Estates Office on 0208 882 2112 if you wish to arrange a viewing appointment for this property or require further information.

- 2 BEDROOM FLAT
- NEWLY REDECORATED
- FITTED KITCHEN
- BRIGHT AND AIRY
- MUST BE SEEN
- SET ON SECOND FLOOR
- LARGE LOUNGE/DINER
- SPACIOUS BATHROOM
- LONG LEASE
- CHAIN FREE

**\*\*CLOSE TO STATION\*\*** Homelink are pleased to offer for sale this newly decorated second floor two bedroom flat set just moments away from Wood Green underground station (Piccadilly line) and plentiful local amenities including a Tesco Express.

This impressive two bedroom flat benefits from a large reception room, modern fitted kitchen with white goods, 2 bedrooms and lovely 3 piece white bathrooms suite. Other benefits include gas central heating and full width windows in each and every room.

The property is being offered chain free and would suit both first time buyers and investors due to its location and proximity to great public transport, parks, schools and local Shopping Mall.

Tenure: Leasehold  
Lease: 115 Years unexpired  
Ground Rent: Currently £125 pa - from Sep £250p/a  
Service Charge £1041.26 p/a  
Haringey C/Tax Band - E



These particulars, whilst believed to be accurate are set out as a general outline only for guidance and do not constitute any part of an offer or contract. Intending purchasers should not rely on them as statements of representation of fact, but must satisfy themselves by inspection or otherwise as to their accuracy. No person in this firms employment has the authority to make or give any representation or warranty in respect of the property.

Homelink Lettings and Estates  
62 Chase Side, London N14 5PA  
0208 882 2112 [homelink.co.uk](http://homelink.co.uk)

