

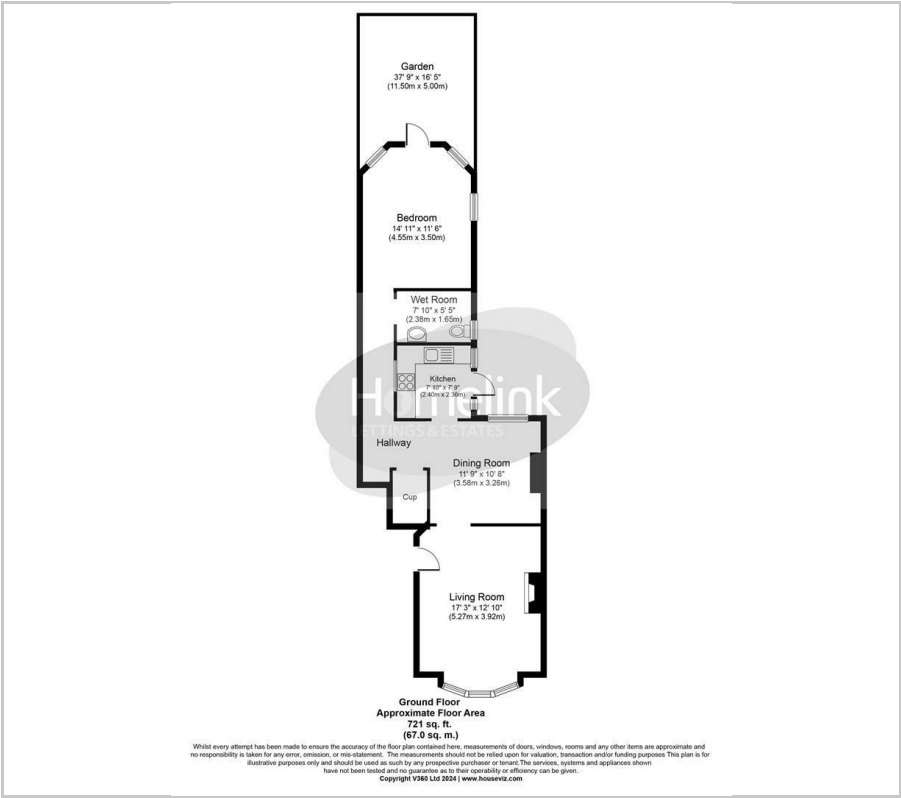

Conway Road, London, N14

£1,750 Per Month

Floor Plan



Area Map



Energy Efficiency Graph

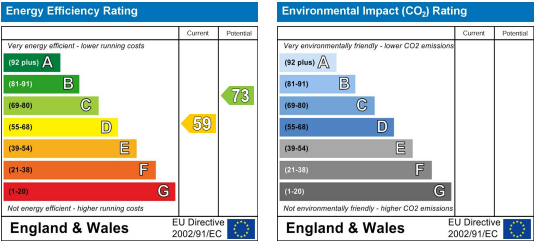

Viewing

Please contact our Homelink Lettings & Estates Office on 0208 882 2112 if you wish to arrange a viewing appointment for this property or require further information.

- One bedroom property
- Private rear garden
- Fully fitted kitchen including all white goods
- Ideal for working professionals
- Double glazed throughout
- Ground Floor
- Close to Palmers Green Station
- Available from the End of May 2025
- Council tax band - D - Enfield Council - £2,164.02
- Must see!



Nestled on the charming Conway Road in London, this delightful one-bedroom ground floor flat offers a perfect blend of comfort and convenience. The property features two spacious reception rooms, providing ample space for relaxation and entertaining. The well-appointed bedroom ensures a peaceful retreat, while the modern bathroom caters to all your daily needs.

One of the standout features of this flat is the beautiful rear garden, a serene outdoor space ideal for enjoying a morning coffee or unwinding after a long day. The garden adds a touch of nature to urban living, making it a rare find in the city.

Situated in close proximity to Palmers Green station, this property is perfectly suited for working professionals seeking easy access to transport links for commuting. The vibrant local area offers a variety of amenities, ensuring that all your daily requirements are within reach.

Available for rent from the end of May, this flat presents an excellent opportunity for those looking to settle in a welcoming community while enjoying the comforts of a well-designed home. Do not miss the chance to make this charming flat your new residence.

Council tax band - D - Enfield Council - £2,164.02



These particulars, whilst believed to be accurate are set out as a general outline only for guidance and do not constitute any part of an offer or contract. Intending purchasers should not rely on them as statements of representation of fact, but must satisfy themselves by inspection or otherwise as to their accuracy. No person in this firms employment has the authority to make or give any representation or warranty in respect of the property.

Homelink Lettings and Estates
62 Chase Side, London N14 5PA
0208 882 2112 [homelink.co.uk](https://www.homelink.co.uk)

