

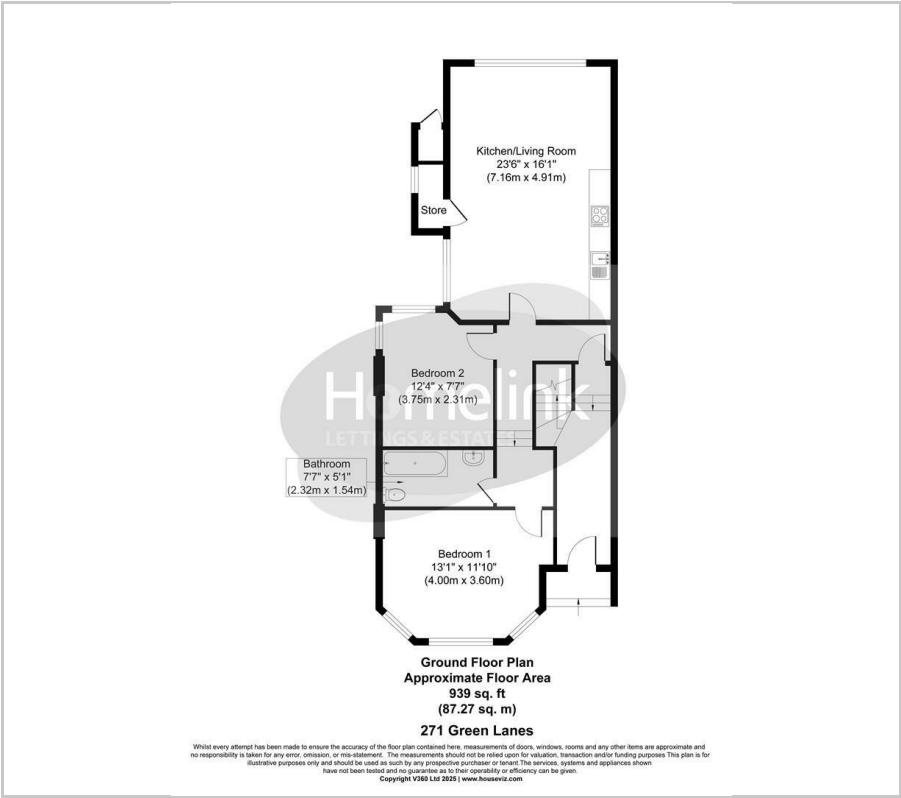

Green Lanes, Palmers Green, N13

£2,100 Per Calendar Month

Floor Plan



Area Map



Energy Efficiency Graph

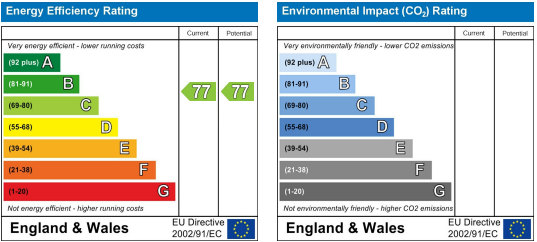

Viewing

Please contact our Homelink Lettings & Estates Office on 0208 882 2112 if you wish to arrange a viewing appointment for this property or require further information.

- Newly refurbished throughout
- Newly installed kitchen
- Newly fitted fully tiled bathroom
- Private rear garden
- Allocated off street parking
- Gas central heating
- Double glazed throghout
- Available now
- Must see
- Ideal for working professtonals.

Nestled in the desirable area of Green Lanes, Palmers Green, this exquisite two-bedroom ground floor flat presents a rare opportunity for those seeking a stylish and comfortable living space. Boasting an impressive high-end finish, this property is perfect for individuals or small families looking for a modern home.

Upon entering, you will be greeted by a welcoming reception room that offers a warm and inviting atmosphere, ideal for relaxation or entertaining guests. The flat features two well-proportioned bedrooms, providing ample space for rest and personalisation. The contemporary bathroom is designed with both functionality and elegance in mind, ensuring a pleasant experience for all residents.

One of the standout features of this property is the allocated off-street parking, a valuable asset in this bustling area. Additionally, the private rear garden space offers a tranquil retreat, perfect for enjoying the outdoors, whether it be for gardening, hosting barbecues, or simply unwinding after a long day.

This flat is not just a home; it is a lifestyle choice, combining modern living with the convenience of local amenities and transport links. With its remarkable finish and desirable features, this property is sure to attract interest. Do not miss out on this exceptional opportunity to secure a beautiful flat in Palmers Green.

Council tax band - TBC - Enfield council.



These particulars, whilst believed to be accurate are set out as a general outline only for guidance and do not constitute any part of an offer or contract. Intending purchasers should not rely on them as statements of representation of fact, but must satisfy themselves by inspection or otherwise as to their accuracy. No person in this firms employment has the authority to make or give any representation or warranty in respect of the property.

Homelink Lettings and Estates
62 Chase Side, London N14 5PA
0208 882 2112 homelink.co.uk

