



Mornington Place, Camden, NW1

Guide Price £450,000



1



1



1



B

# Mornington Place, Camden, NW1



## Description

**\*\*PRICED TO SELL\*\*** Homelink are delighted to offer for this well presented one double bedroom floor flat located just minutes from Mornington Crescent underground station (Northern Line, zone 2).

The apartment is set on the second floor and benefits from having an open plan lounge and modern fitted kitchen with integrated appliances, double bedroom and a tiled shower room. Further benefits include a storage area, gas central heating, wood flooring, double glazed sash windows throughout and access to the communal garden.

This highly desirable development is well located for access to Camden Town, Mornington Crescent, Primrose Hill, Regents Park and Euston. This is a great opportunity for buyers who need to be close to Central London and the surrounding areas or could suit an investor and even used as a pied-à-terre

To arrange a viewing, call and speak to one of our friendly sales team. Viewing highly recommended.

Tenure: LEASEHOLD

Lease: 242 Years

Service Charge : £1,300 p.a. approx.

Ground Rent: NIL

Camden C/Tax Band - E

- One Bedroom Flat
- Modern Fitted Kitchen
- Integrated Appliances
- Modern Tiled Shower Room
- Gas C/H + D/Glazing
- Ideal for City Worker
- Great Transport & Road Links
- Must Be Seen
- New Long Lease
- Chain Free







Floor Plan

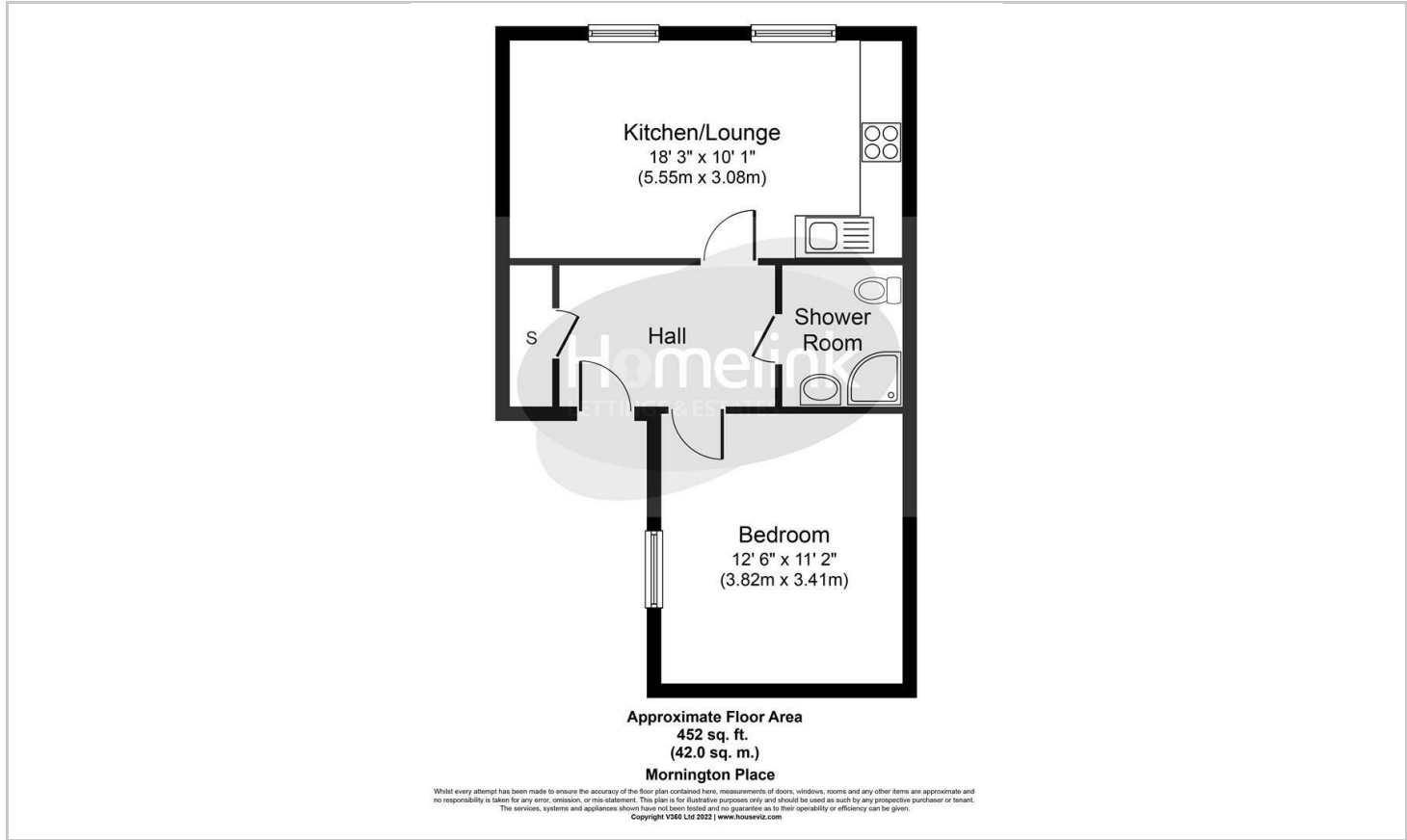

Area Map

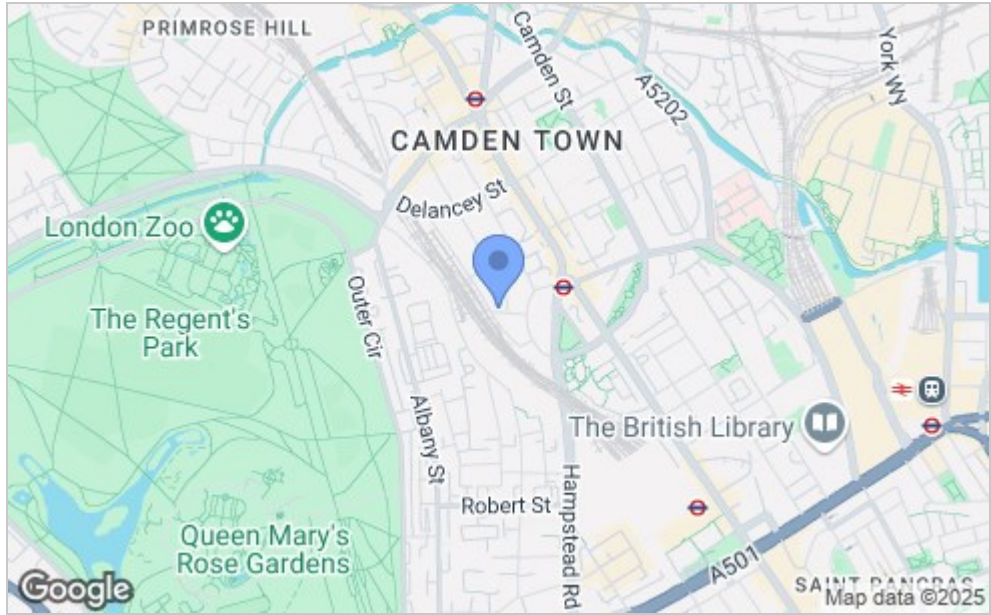

Viewing

Please contact our Homelink Lettings & Estates Office on 0208 882 2112 if you wish to arrange a viewing appointment for this property or require further information.

These particulars, whilst believed to be accurate are set out as a general outline only for guidance and do not constitute any part of an offer or contract. Intending purchasers should not rely on them as statements of representation of fact, but must satisfy themselves by inspection or otherwise as to their accuracy. No person in this firm's employment has the authority to make or give any representation or warranty in respect of the property.

Energy Efficiency Graph

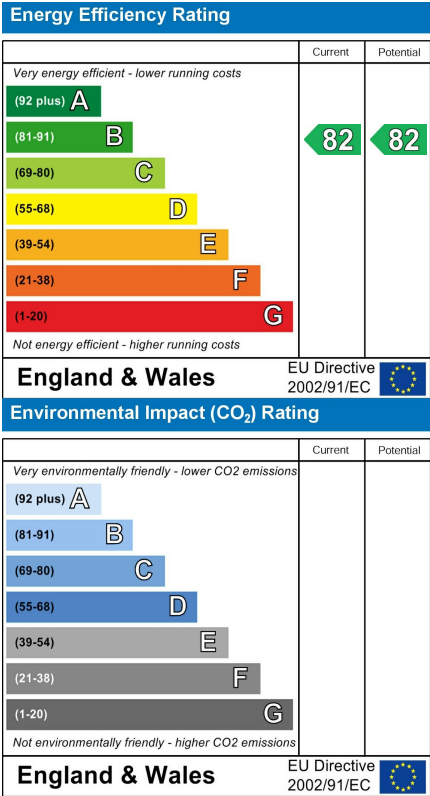

Homelink Lettings and Estates  
62 Chase Side, London N14 5PA  
0208 882 2112 [homelink.co.uk](http://homelink.co.uk)

