

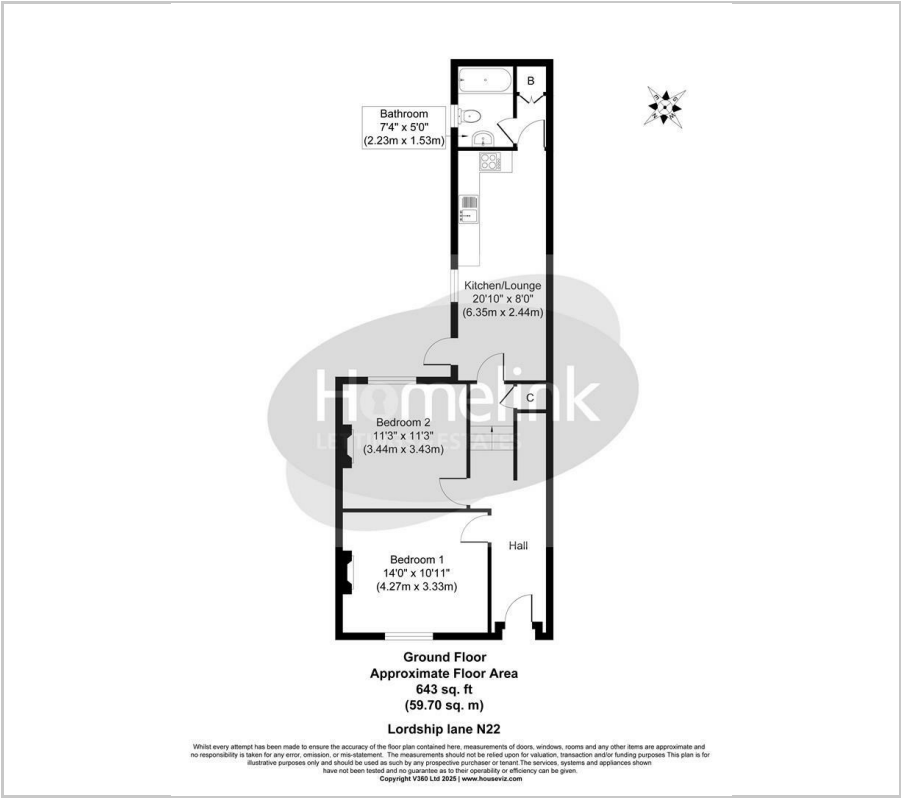

Lordship Lane, Wood Green, N22

£1,700 PCM

Floor Plan



Area Map



Energy Efficiency Graph

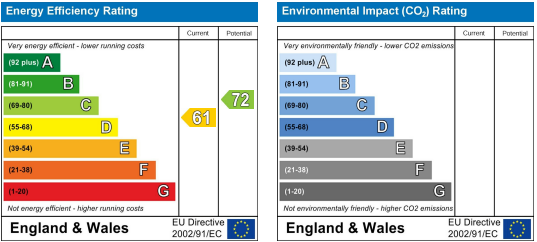

Viewing

Please contact our Homelink Lettings & Estates Office on 0208 882 2112 if you wish to arrange a viewing appointment for this property or require further information.

- Two Double Bedrooms
- Own Section of Rear Garden
- Modern Kitchen with White Goods
- Great Road and Bus Links
- Ideal for Professional Couple
- Open Plan Kitchen/Lounge
- Part Furnished
- Close to Local Shops + Tesco
- Underground Station just Minutes Away
- Available Now

****GROUND FLOOR FLAT**** Homelink are pleased to offer for rent this lovely two double bedroom ground floor flat set in a period house conversion just a few minutes from Wood Green underground station. The property is ideal for a small family as it is close to good local schools.

The property benefits from large rear garden, gas central heating, double glazing, wood flooring and ample shopping amenities on the doorstep including Tesco Express. It comprises of 2 good sized bedrooms, open plan kitchen/lounge/diner and storage cupboards and comes part furnished.

Lordship Lane N22 is ideally located close to the amenities of Wood Green, as well as the transport links via Wood Green tube (Piccadilly Line, zone 3). Available now.

Haringey C/Tax Band 'C'
2025/26 C/Tax - £1,962.61



These particulars, whilst believed to be accurate are set out as a general outline only for guidance and do not constitute any part of an offer or contract. Intending purchasers should not rely on them as statements of representation of fact, but must satisfy themselves by inspection or otherwise as to their accuracy. No person in this firm's employment has the authority to make or give any representation or warranty in respect of the property.

Homelink Lettings and Estates
62 Chase Side, London N14 5PA
0208 882 2112 [homelink.co.uk](https://www.homelink.co.uk)

