



Dugdale Hill Lane, Potters Bar, EN6

Guide Price £580,000

 3  1  1  D



# Dugdale Hill Lane, Potters Bar, EN6



## Description

**\*\*CATCHMENT of DAME ALICE OWEN\*\***

This three-bedroom semi-detached home in the heart of Potters Bar is bursting with charm and ready for its next chapter.

Inside, you'll find a cosy separate lounge, a well-sized kitchen/diner, and a convenient ground floor bathroom. Upstairs, there are three generous bedrooms, offering plenty of space for family life, guests or a home office.

The sunny south-facing garden is ideal for relaxing or entertaining, and there's also a driveway and garage, with scope to extend (STPP) for those looking to grow.

And let's not forget location – just a short distance from the highly regarded Dame Alice Owen's School, plus local shops, transport links and green spaces all close by.

Don't miss your chance – book your viewing today!

Tenure: Freehold  
Hertsmere C/Tax Band - D

In accordance with the Estate Agents Act 1979: Please note the seller or seller company is directly related or employed by Homelink Residential Ltd, the selling agent

- 3 Bedroom Semi Detached
- Comes with Planning
- Spacious Lounge
- Fitted Kitchen/Breakfast Room
- Ground Floor Bathroom
- Own Drive to Side Garage
- South Facing Rear Garden
- Ideal for First Time Buyers
- Close to Dame Alice Own
- Chain Free







## Floor Plan

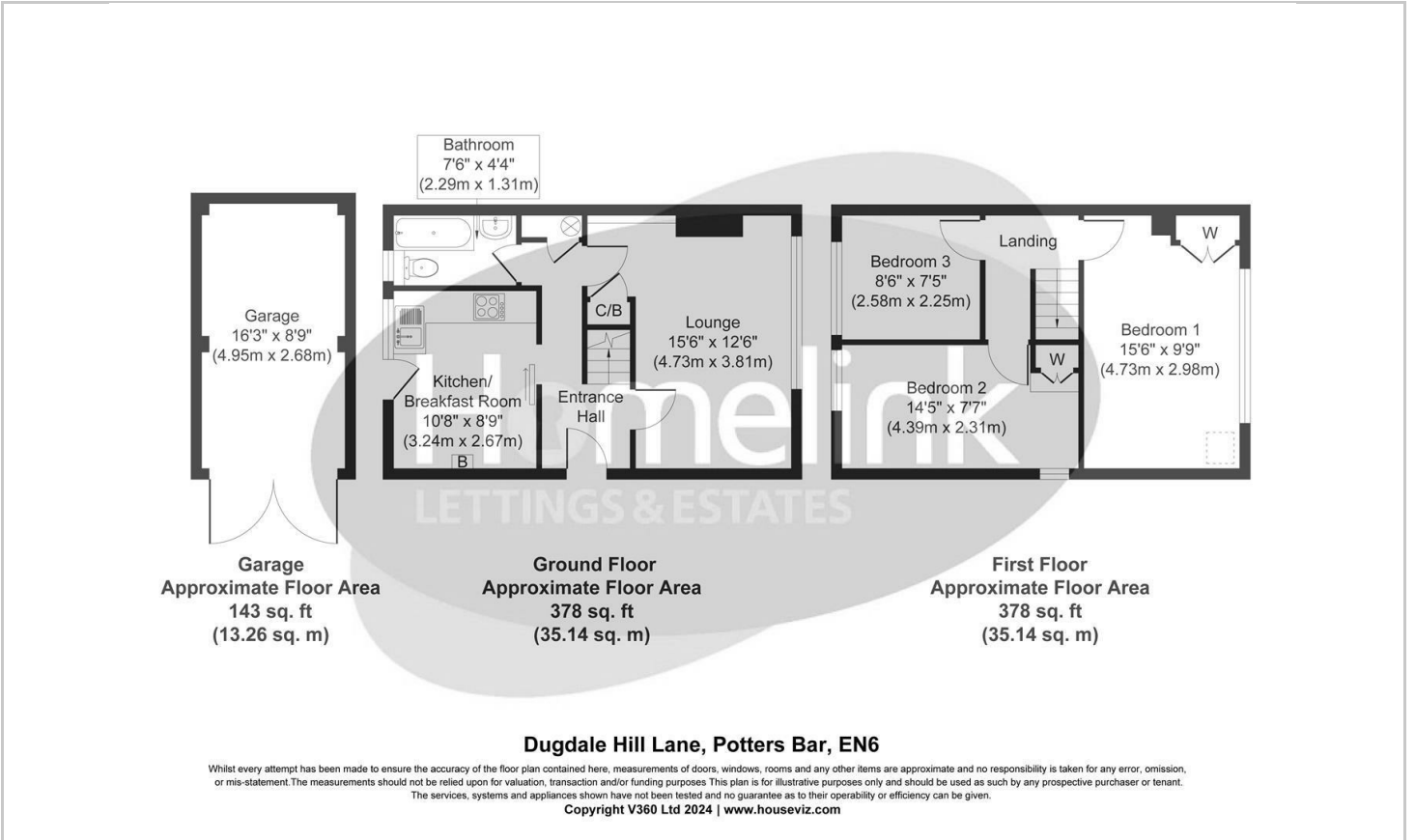

## Area Map

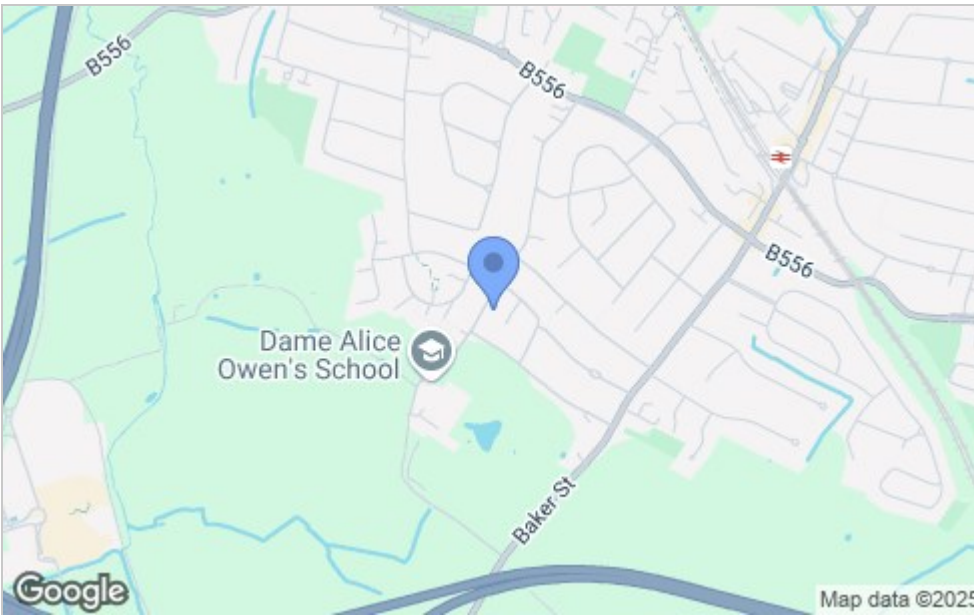

## Viewing

Please contact our Homelink Lettings & Estates Office on 0208 882 2112 if you wish to arrange a viewing appointment for this property or require further information.

These particulars, whilst believed to be accurate are set out as a general outline only for guidance and do not constitute any part of an offer or contract. Intending purchasers should not rely on them as statements of representation of fact, but must satisfy themselves by inspection or otherwise as to their accuracy. No person in this firm's employment has the authority to make or give any representation or warranty in respect of the property.

## Energy Efficiency Graph

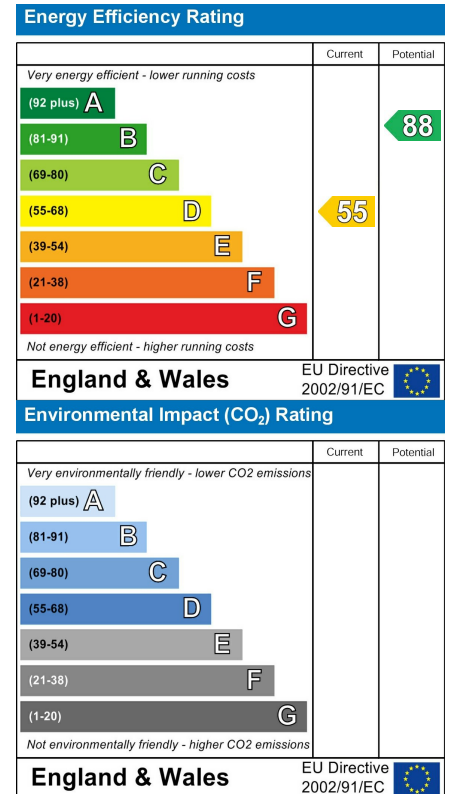

Homelink Lettings and Estates  
62 Chase Side, London N14 5PA  
0208 882 2112 [homelink.co.uk](http://homelink.co.uk)

