

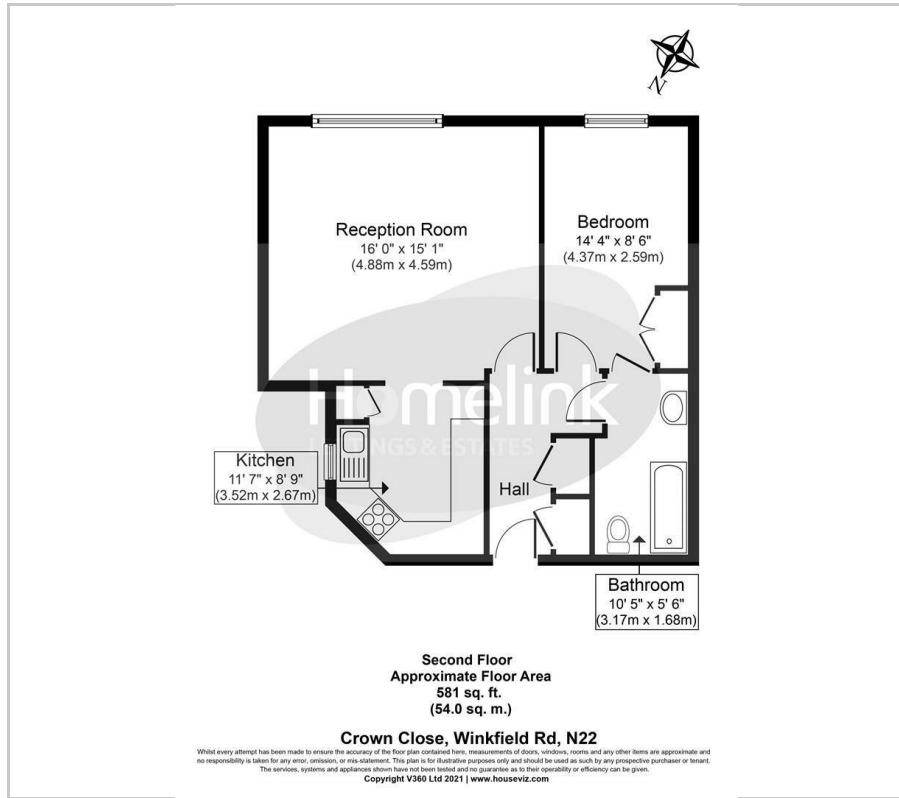

Crown Close, Wood Green, N22

£1,700 PCM

Floor Plan



Area Map



Energy Efficiency Graph

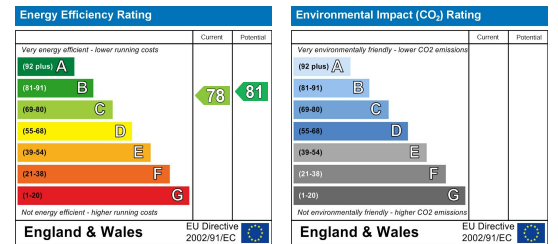

Viewing

Please contact our Homelink Lettings & Estates Office on 0208 882 2112 if you wish to arrange a viewing appointment for this property or require further information.

- One Bedroom Apartment
- Larger than Average Lounge
- Modern Tiled Bathroom
- Lift to All Floors + CCTV
- Ideal For Professionals
- Gated Development
- Fully Fitted Kitchen
- Lots of Storage
- Council Tax Band 'C'
- Close to Transport Links

****STUNNING FLAT**** Homelink are delighted to bring to the rental market a truly scrumptious one double bedroom apartment set on the second floor of a modern private gated development.

This truly luxury property has been refurbished to an exceptional standard by the current owners. The property has a large bright reception room, fully fitted kitchen, newly installed modern fully tiled three piece white bathroom suite, new hardwood flooring and benefits from gas central heating, double glazing, lift access to all floors and CCTV.

Crown Close is situated just a short walk from Wood Green underground station (Piccadilly Line, zone 3) and within very easy reach of many local shops, bars and restaurants of Wood Green and the local parks including Alexandra Palace.

This is an ideal opportunity for a professional couple who want to be close to transport and shopping amenities as well as having space to work from home.

To arrange a viewing, call and speak to one of our friendly lettings team. Viewings highly recommended.

Council Tax: Band 'C'
2024/25: £1,873.18

These particulars, whilst believed to be accurate are set out as a general outline only for guidance and do not constitute any part of an offer or contract. Intending purchasers should not rely on them as statements of representation of fact, but must satisfy themselves by inspection or otherwise as to their accuracy. No person in this firm's employment has the authority to make or give any representation or warranty in respect of the property.

