

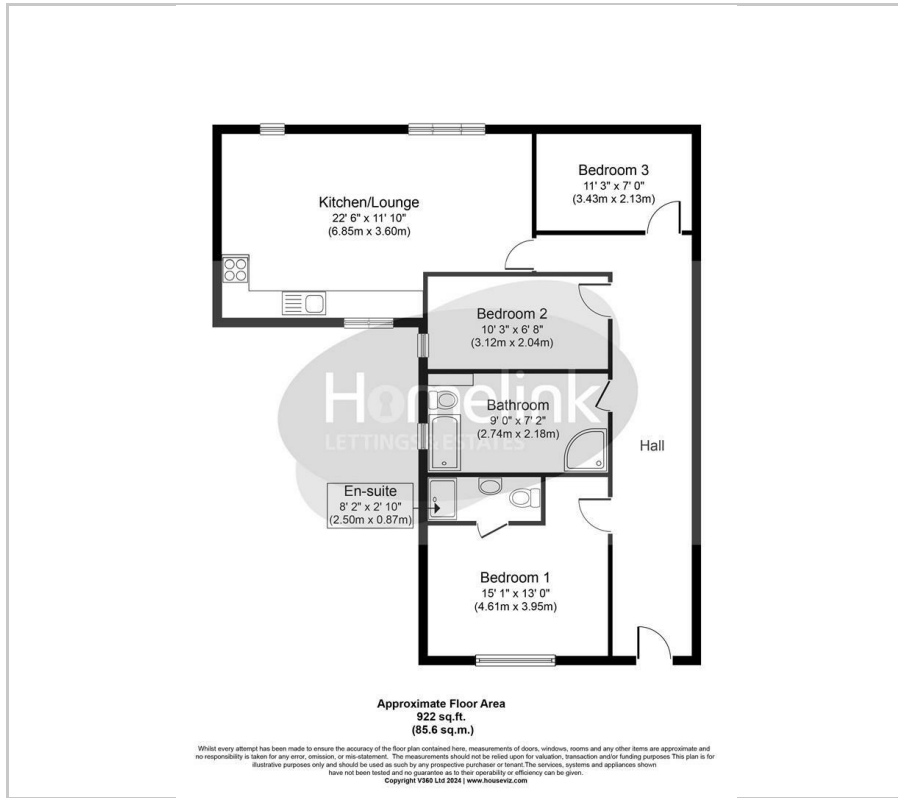

London Road, Enfield, EN2

£1,700 Per Calendar Month

## Floor Plan



## Area Map



## Energy Efficiency Graph

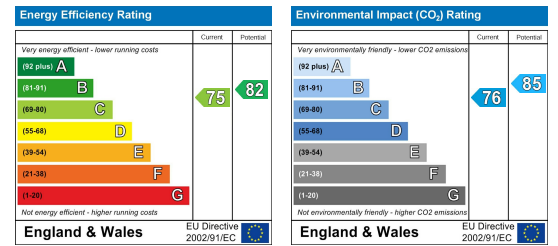

## Viewing

Please contact our Homelink Lettings & Estates Office on 0208 882 2112 if you wish to arrange a viewing appointment for this property or require further information.

- Three bedroom flat
- Modern kitchen including all white goods
- Ensuite in Master bedroom
- Gas central heating
- Close to Enfield Town shops
- First floor property
- Four piece family bathroom
- Unfurnished.
- Double glazing throughout
- Close to Enfield Town over ground station.



Homelink Lettings & Estates are delighted to offer for rent this well presented three bedroom property in the heart of Enfield. The property benefits from the following, three bedroom, modern & large kitchen lounge area, four piece family bathroom, wooden flooring throughout, gas central heating, double glazed throughout and will be offered on an unfurnished basis.

Great location as the property is situation close to Enfield Town over ground station. As well as various bus routes towards Bush Hill Park, Winchmore Hill & Edmonton. Fantastic local amenities near by as Enfield town shopping centre is a stones throw away from the property.

Please call Homelink Lettings & Estates today and speak with one of our friendly lettings team members today. Early viewings recommend to avoid disappointment.

Council tax band - D - Enfield council - £1,952.44



These particulars, whilst believed to be accurate are set out as a general outline only for guidance and do not constitute any part of an offer or contract. Intending purchasers should not rely on them as statements of representation of fact, but must satisfy themselves by inspection or otherwise as to their accuracy. No person in this firms employment has the authority to make or give any representation or warranty in respect of the property.

Homelink Lettings and Estates  
62 Chase Side, London N14 5PA  
0208 882 2112 [homelink.co.uk](http://homelink.co.uk)

