



Elysium Court, Waverley Road, Enfield, EN2

Offers In The Region Of £600,000

A row of four icons representing property features: a bed icon with the number '2', a bathtub icon with the number '2', a sofa icon with the number '1', and a menu icon with the letter 'B'.



# Elysium Court, Waverley Road, Enfield, EN2



## Description

**\*\*LUXURY & BEYOND\*\*** The property has an amazing finish and attention to details throughout and you will marvel at the latest technology including ceiling speakers in all rooms, Italian floor tiles, under floor heating and bespoke Italian cabinetry in the wonderfully appointed kitchen.

The property is part of just 9 exclusive flats set in a beautiful location and offer amazing space throughout. This first floor flat has not 1, but 2 spacious balconies with far reaching views of the London skyline.

The property is located moments away from the heart of Enfield Town in North London and is within a short walk to Enfield Golf Club. Further amenities include entertainment as well local gyms and green areas. With direct links from both Enfield Chase and Enfield Town stations direct to Moorgate and Liverpool Street Stations into the city for as well as great road links with the M25, A10 and A406 are all within easy reach too.

Tenure: Leasehold

Lease: 120 Years

Ground Rent: £350 p.a.

Service Charge: £2,000 p.a.

Enfield Council Tax: Band 'F'

- Luxury New Build
- 2 Bedrooms set on First Floor
- En-suite + Separate Shower Room
- Stunning Bespoke Kitchen
- Attention to Detail Throughout
- 2 Balconies
- Integrated Appliances
- Ample Storage Inside & Outside
- Allocated Underground Parking
- Chain Free + 120 Year Lease







## Floor Plan

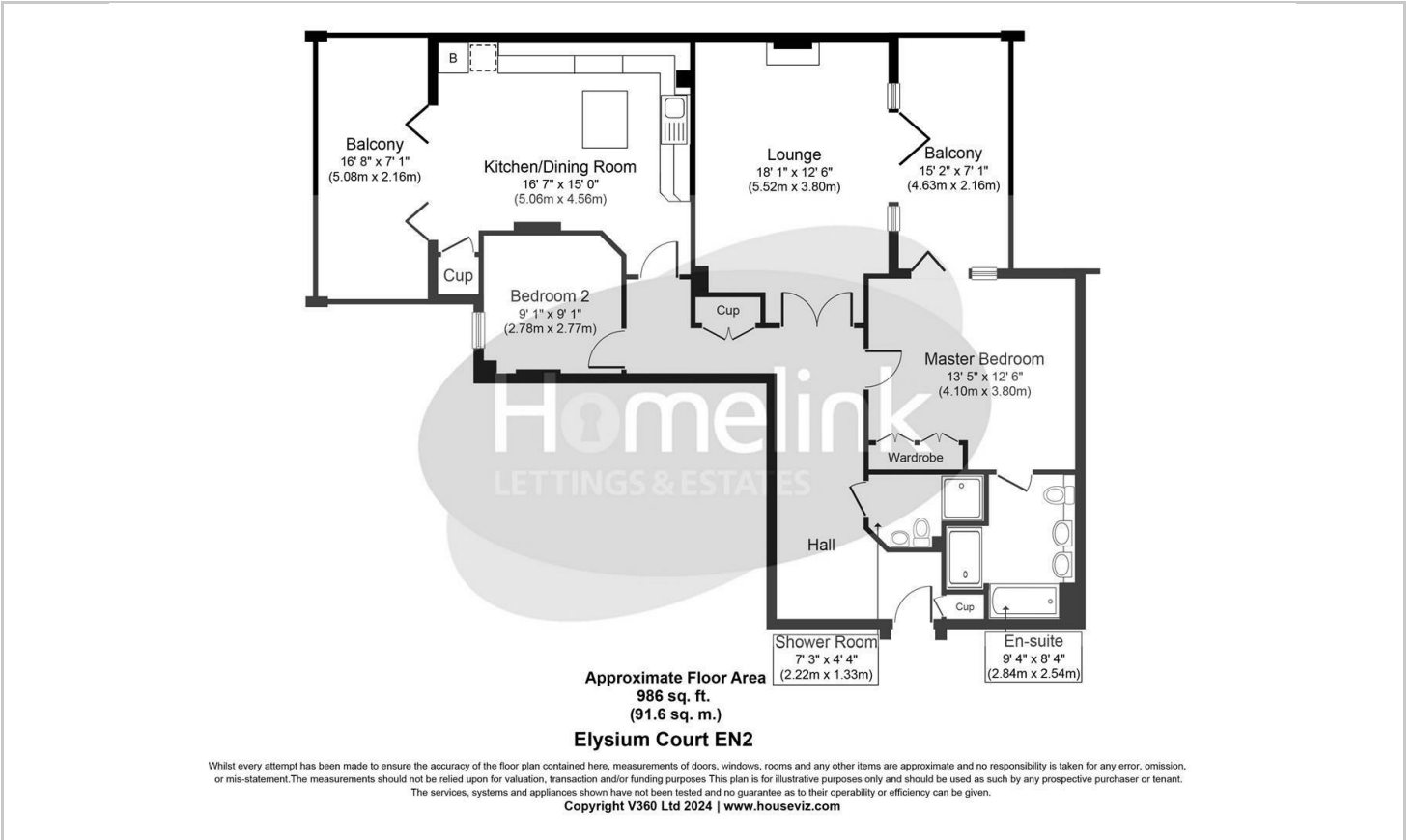

## Area Map

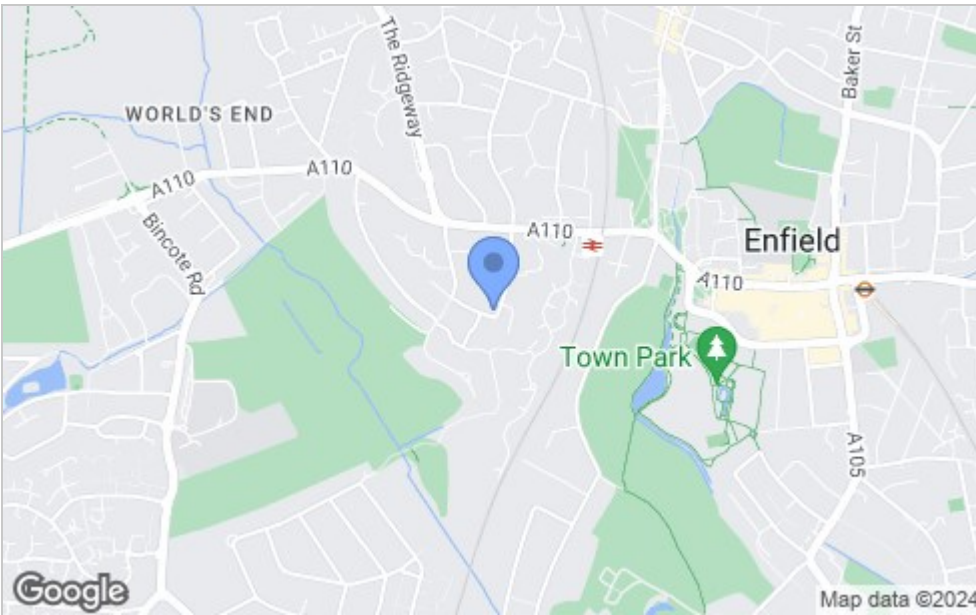

## Energy Efficiency Graph

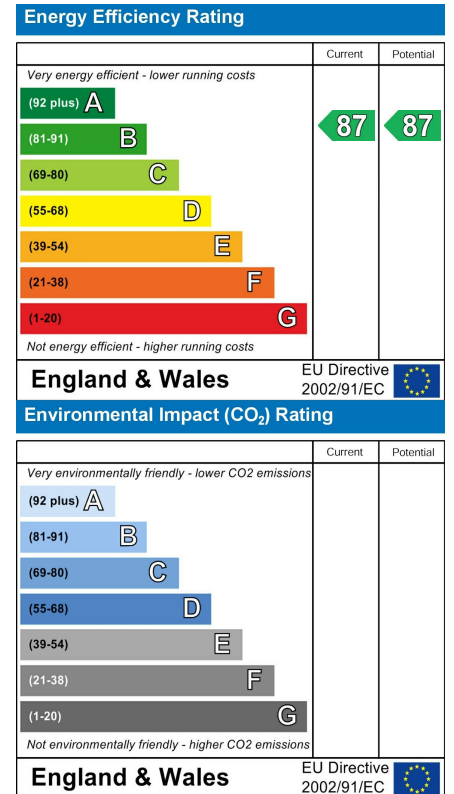

## Viewing

Please contact our Homelink Lettings & Estates Office on 0208 882 2112 if you wish to arrange a viewing appointment for this property or require further information.

These particulars, whilst believed to be accurate are set out as a general outline only for guidance and do not constitute any part of an offer or contract. Intending purchasers should not rely on them as statements of representation of fact, but must satisfy themselves by inspection or otherwise as to their accuracy. No person in this firm's employment has the authority to make or give any representation or warranty in respect of the property.

Homelink Lettings and Estates  
 62 Chase Side, London N14 5PA  
 0208 882 2112 [homelink.co.uk](http://homelink.co.uk)

