



Clarendon Crescent

Twickenham, TW2

£1,800 per month
(£415.38 per week)

Two bedroom apartment within walking distance to Fulwell Station. The apartment boasts a newly fitted kitchen along with two good sized bedrooms. Offered furnished and available at the start of August.

CHESTERTONS

**Clarendon Crescent,
Twickenham, TW2**

Approximate gross internal area
53.97 sq m / 581 sq ft

Key :
CH - Ceiling Height

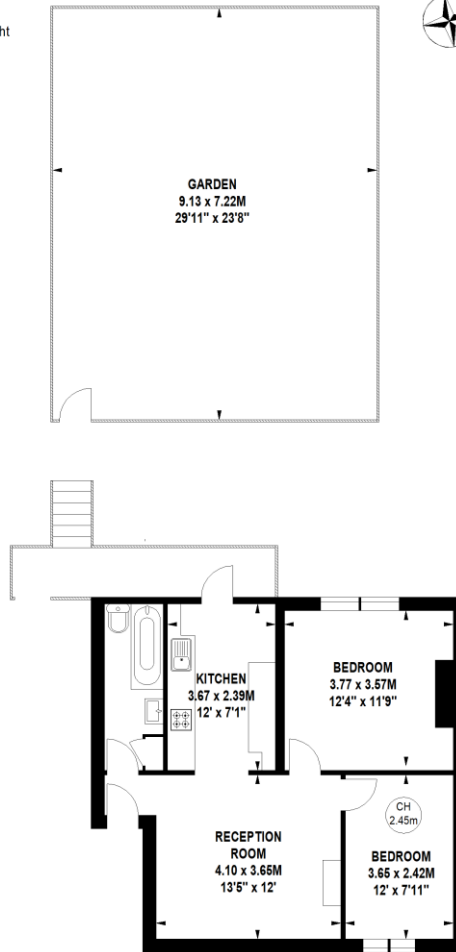

First Floor

Not to scale, for guidance only and must not be relied upon as a statement of fact.
All measurements and areas are approximate only

Minimum Term: 12 months
Deposit Required: £2,076.92
Local Authority: London Borough Of Richmond Upon Thames
Council Tax Band: C
EPC Rating: C

Energy Efficiency Rating		
	Current	Potential
Very energy efficient - lower running costs		
(92+) A		
(81-91) B		
(69-80) C	74	79
(55-68) D		
(38-54) E		
(21-38) F		
(1-20) G		
Not energy efficient - higher running costs		
EU Directive 2002/91/EC		
England, Scotland & Wales		

Chestertons Richmond Lettings

23a Friars Stile Road
Richmond
Surrey
TW10 6NH
lettings.richmond@chestertons.co.uk
02037583333

Additional tenant charges apply (fees apply to non-AST tenancies only)

Tenancy Agreement Fee: £300

References per Tenant/Guarantor: £60

Inventory check (approx. £100 – £250 inc. VAT)

chestertons.co.uk/property-to-rent/applicable-fees

Chesterton Global Ltd trading as Chestertons for themselves and for the vendor of this property whose agents they are, give notice that (i) these particulars do not constitute any part of an offer or contract, (ii) all statements contained within these particulars are made without responsibility on the part of Chestertons or the vendor, (iii) whilst made in good faith, none of the statements contained within these particulars are to be relied upon as a statement or representation of fact, (iv) any intending purchasers must satisfy themselves by inspection or otherwise as to the correctness of each of the statements contained within these particulars, (v) the vendor does not make or give either Chestertons or any person in their employment any authority to make or give representation or warranty whatsoever in relation to this property. Wide angle lenses may be used. ©Copyright Chestertons | Chesterton Global Ltd | Registered Office 40 Connaught Street, Hyde Park, London W2 2AB Registered Company Number 05334580.



This paper is
100% recyclable