



Kingsworthy Close

Kingston Upon Thames, KT1

£1,600 per month
(£369.23 per week)

An exceptionally well presented and appointed, purpose built one bedroom apartment with allocated parking, located within a secure, gated development.



Kingsworthy Close

Kingston Upon Thames, KT1

- One bedroom purpose built apartment
- Allocated parking
- Secure, gated development
- Immacuately presented throughout
- 0.7 miles (15 minute walk) of the railway station
- Convenient for Kingston town centre



This immaculately presented purpose-built one-bedroom apartment boasts a high standard of finish and contemporary style throughout. Situated within a secure, and gated development, this apartment offers a blend of comfort, privacy, and convenience. The property includes the added benefit of an allocated parking space. The development itself is well-maintained, offering residents a sense of safety, while the apartment itself features modern, high-quality fittings and a spacious living area.

THE PROPERTY

An exceptionally well presented and appointed, purpose built one bedroom apartment with allocated parking, located within a secure, gated development. Situated on the second floor, the property is presented beautifully throughout and comprises generous proportions throughout incorporating a double bedroom, bathroom and reception dining room with open plan kitchen with breakfast bar. The development itself is also provided with an allocated parking space as well as visitor parking for guests.

Minimum Term: 12 months
Deposit Required: Five weeks
Local Authority: Kingston Upon Thames
Council Tax Band: C
EPC Rating: C
Unfurnished

Energy Efficiency Rating		
	Current	Potential
Very energy efficient - lower running costs		
(92-100) A		
(81-91) B		
(69-80) C	70	73
(55-68) D		
(39-54) E		
(21-38) F		
(1-20) G		
Not energy efficient - higher running costs		
England, Scotland & Wales		EU Directive 2002/91/EC

Chestertons Richmond Lettings

23a Friars Stile Road
 Richmond
 Surrey
 TW10 6NH
richmondlettingsusers@chestertons.co.uk
 02037583333
chestertons.co.uk

Kingsworthy Close, Kingston upon Thames KT1

Approximate Gross Internal Area | 483 sq ft / 448.8 sq m

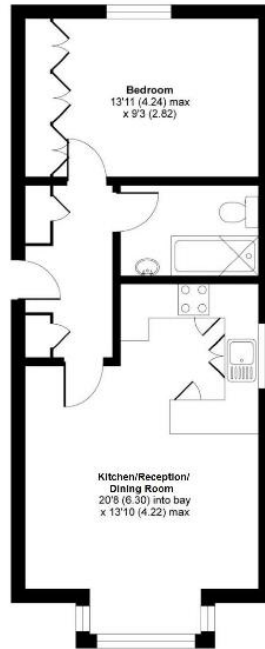

Every attempt is made to assure accuracy, however measurements are approximate and for illustrative purposes only. Not to scale. (ID551856)

