



Richmond Hill Court

Richmond, TW10

Asking Price £799,950

Chestertons Richmond are delighted to bring this three bedroom mansion block apartment to the sales market, with no onward chain, private garage and a share of the freehold.

The property is located on the 1st floor with a fabulous flow and overlooks the Richmond Hill Court tennis courts. The property is presented to the market in great condition and has a modern and contemporary feel. Comprising: two large double bedrooms and a further bedroom. Having a third bedroom makes this a rare find within Richmond Hill Court and would provide the additional benefit to homeworkers, by not losing a bedroom for office space. The property further benefits from a private garage which can be used for extra storage or for a vehicle and has electricity in there.

The current owners are selling the property with no onward chain and with a very long lease.



Richmond Hill Court

Richmond, TW10

- Three bedrooms
- Private garage
- Additional residents parking (first come first served)
- Tennis court
- On-site porter
- Lift
- No onward chain



Richmond Hill Court is ideally located for the amenities of both Richmond Hill and Richmond town centre.

Richmond Hill is a small community with a beautiful village at its heart, with the world famous Richmond Park on its doorstep. The village perfectly balances city and country living thanks to the spacious green spaces and easy London transport links. An ideal location for families, Richmond Hill has outstanding state and private school options, including The Vineyard, King's House, Old Vicarage and Marshgate Primary School to name a few.

You'll find everyday amenities such as dry cleaning, smaller supermarkets and coffee spots on your doorstep alongside a selection of pubs, cafes and restaurants. Local favourites include the Richmond Hill Bakery, The Marlborough pub and La Luna di Luca restaurant. Duck Pond Market, on the scenic riverside, sells ethically-sourced local food, art and crafts every weekend.

Richmond town centre offers a wider range of shops, from independent boutiques in cobbled lanes to leading High Street brands, along with a Whole Foods Market and large Waitrose supermarket.

Tenure: Share of Freehold – lease expires December 2984

Service Charge: £4645 pa for the property for the period April 23 – March 24 includes 24-hour onsite porter, central heating, hot water
£158 pa for the garage for the period April 23 – March 24

Ground Rent: £45 pa for the property, £5pa for the garage

Local Authority: London Borough Of Richmond Upon Thames

Council Tax Band: F

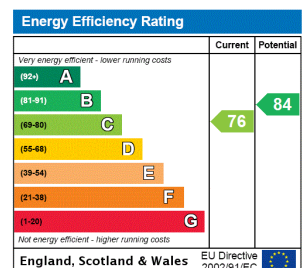

Chestertons Richmond Sales

23a Friars Stile Road
Richmond
Surrey
TW10 6NH
richmond@chestertons.co.uk
020 3758 3222
chestertons.co.uk

Richmond Hill Court,
Richmond,
Surrey, TW10



○ - Ceiling Height

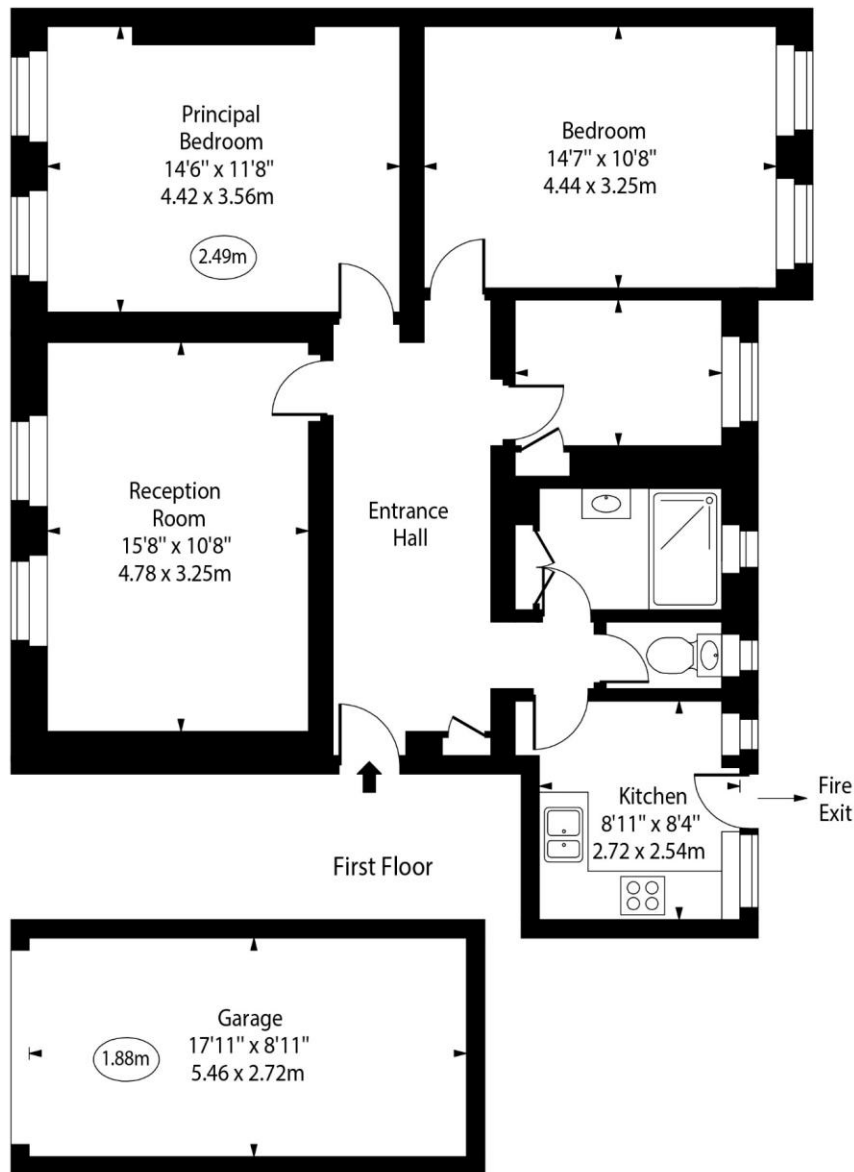

First Floor

Ground Floor

Approx Gross Internal Area 900 Sq Ft - 83.61 Sq M
(Excluding Garage)

Garage Area 162 Sq Ft - 15.05 Sq M

For Illustration Purposes Only - Not To Scale

www.goldlens.co.uk

Ref. No. 023569E

