

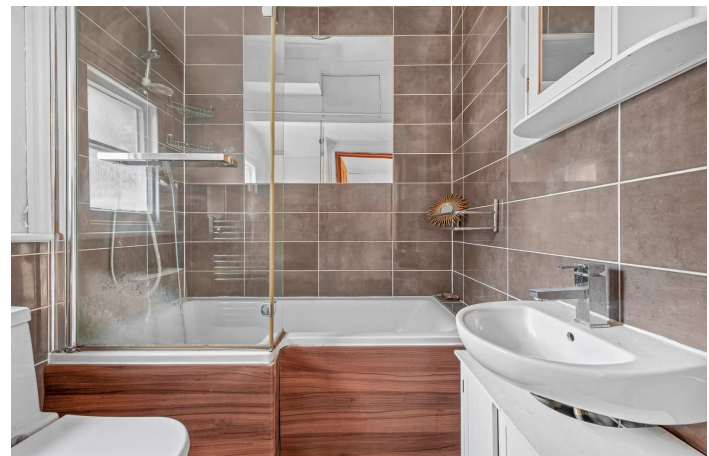

Queens Road  
Twickenham, TW1

CHESTERTONS





Nestled in the vibrant heart of central Twickenham, this stylish 1-bedroom, 1-bathroom freehold apartment offers a rare opportunity to own a contemporary home in one of South West London's most sought-after locations. Finished to a high standard throughout, the property features a bright open-plan living space, a sleek modern kitchen with integrated appliances, and a spacious double bedroom with ample storage. The elegant bathroom completes the home with modern fittings and a clean, minimalist design.

Situated just moments from Twickenham Station, the apartment offers fast direct trains to London Waterloo in under 25 minutes, making it ideal for professionals and commuters. A wide range of local amenities are right on your doorstep, including independent cafés, restaurants, boutiques, and major supermarkets. Twickenham Riverside, historic pubs, and scenic walks along the Thames are also within easy reach, offering a perfect balance of city living and suburban charm.

Whether you're a first-time buyer, investor, or looking for a pied-à-terre, this well-located and low-maintenance home is a must-see.

- Freehold apartment (no ground rent or lease issues)
- Modern interiors with high-quality finishes
- Excellent transport links – under 25 minutes to London Waterloo
- Prime central Twickenham location
- Close to shops, cafes, restaurants & green spaces

Asking Price £425,000

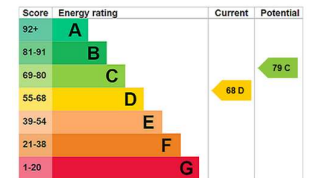

**Tenure:** Freehold

**Service Charge:** £2570

**Ground Rent:** £0

**Local Authority:** London Borough of Richmond upon Thames

**Council Tax Band:** D

**Chestertons Richmond Sales**

23a Friars Stile Road

Richmond

Surrey

TW10 6NH

richmond@chestertons.co.uk

020 3758 3222

Queens Road,  
Twickenham, TW1

Kitchen  
7'11" x 7'7"  
2.41 x 2.31m

○ - Ceiling Height

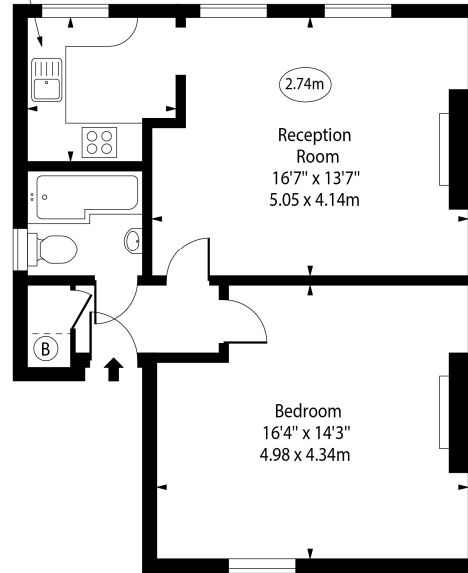

First Floor

Approx Gross Internal Area 580 Sq Ft - 53.88 Sq M

Every attempt has been made to ensure the accuracy of the floor plan shown. However, all measurements, fixtures, fittings, and data shown are approximate interpretations and for illustrative purposes only. Measured according to the RICS. Not To Scale.

[www.goldlens.co.uk](http://www.goldlens.co.uk)

Ref. No. 029371E

