



Moor Mead Road

St Margaret's, TW1

Asking Price £700,000

An immaculate and beautifully presented two double bedroom maisonette overlooking Moor Mead Park. Comprising entrance hall, bright and spacious reception room, modern fully fitted kitchen and family bathroom and a detached garage.

CHESTERTONS



Moor Mead Road

St Margaret's, TW1

- Overlooking Moormead Park
- No onward chain
- St Margarets Village
- Scope to extend (STPP)
- Private Balcony



This delightful two-bedroom, one-bathroom flat on the first floor in St Margarets effortlessly combines modern living with an unbeatable location. The property features a spacious, contemporary interior with stylish finishes and a bright, airy ambiance. Additionally, it offers the added benefit of a detached garage, perfect for parking or extra storage space.

The flat overlooks the beautiful Moor Mead Park, providing stunning views and offering a peaceful setting right on your doorstep.

St Margarets Station is just a short walk away, offering excellent transport links into central London, while the nearby towns of Twickenham and Richmond provide a variety of shops, cafes, and restaurants. Whether you're commuting or enjoying the surrounding area, this property is ideally located to enjoy the best of both worlds.

This modern flat is an ideal choice for those seeking a stylish, low-maintenance home in a vibrant and well-connected area.

Tenure: Leasehold – 135 years

Ground Rent: £28.85

Local Authority: London Borough of Richmond upon Thames

Council Tax Band: E

Energy Efficiency Rating		
	Current	Potential
Very energy efficient - lower running costs		
(92-100) A		
(81-91) B		
(69-80) C		
(55-68) D		
(39-54) E		
(21-28) F		
(1-10) G		
Not energy efficient - higher running costs		
69		78
England, Scotland & Wales		
EU Directive 2002/91/EC		

Chestertons Richmond Sales

23a Friars Stile Road

Richmond

Surrey

TW10 6NH

richmond@chestertons.co.uk

020 3758 3222

chestertons.co.uk

Moor Mead Road,
Twickenham, TW1

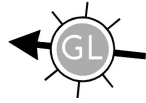

○ - Ceiling Height

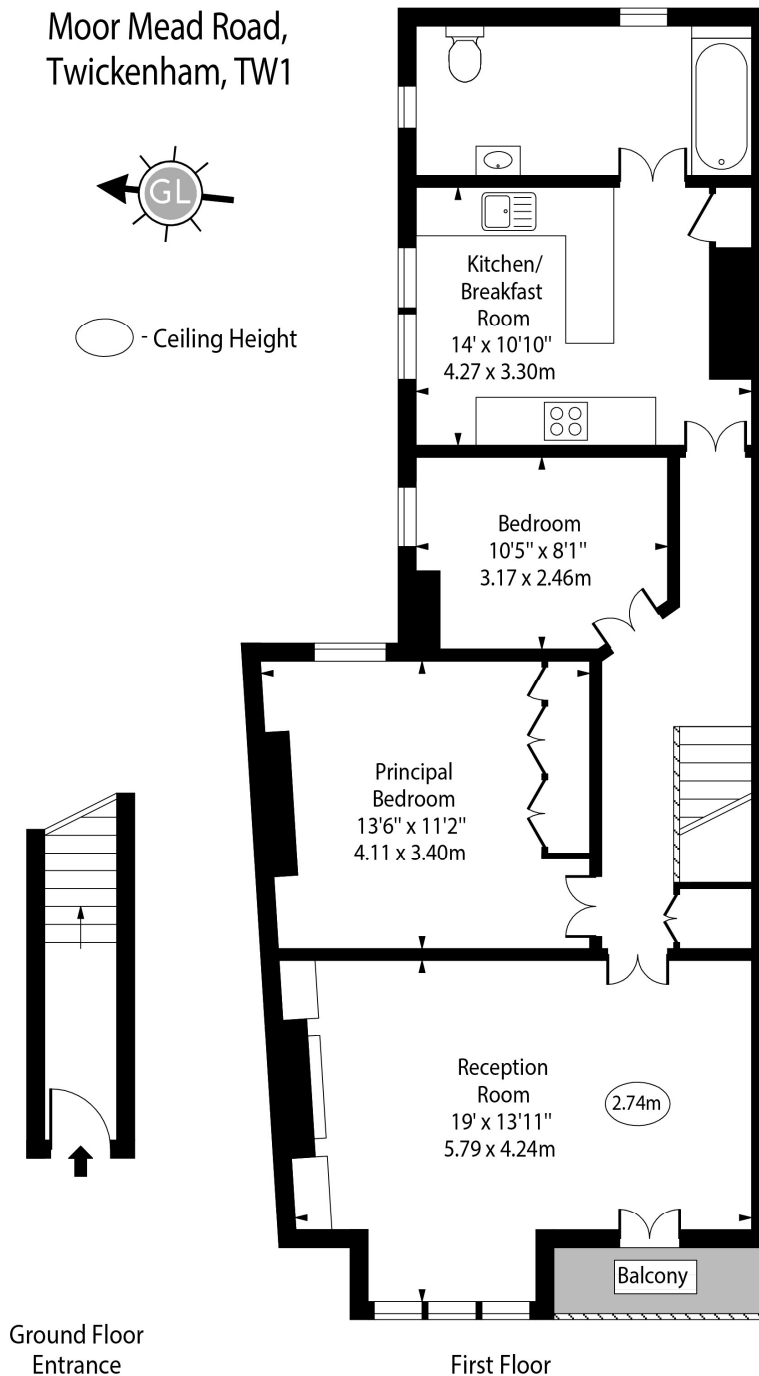

Approx Gross Internal Area 902 Sq Ft - 83.80 Sq M

For Illustration Purposes Only - Not To Scale
www.goldlens.co.uk
Ref. No. 026864E

