



Richmond Hill Court

Richmond, TW10

Asking Price £775,000

Located in the prestigious Richmond Hill Court, this stunning two-bedroom, top-floor apartment offers an exceptional standard of living. The apartment features a top-of-the-range kitchen, complete with luxurious fittings and a James Bond-style wine fridge, perfect for entertaining and impressing guests.

The apartment has large windows offering sweeping views from Twickenham to Wembley Stadium. The apartment has been recently fitted with double glazing throughout and also features lift access.

CHESTERTONS



Richmond Hill Court

Richmond, TW10

- Private Gardens
- Tennis Court
- Onsite Concierge/ Estate Management
- 2 Spacious Double Bedrooms
- Long Lease
- Extremely Bright with Panoramic Views
- Recently Double Glazed Throughout
- Top Floor with Lift Access



Residents of Richmond Hill Court benefit from the convenience of a resident porter/estate management, providing security and assistance, as well as access to exclusive amenities, including private tennis courts. The property also comes with a private garage, offering secure parking and additional storage.

Richmond Hill Court is superbly positioned with excellent transport links. Richmond Station is within easy reach, providing swift access to London via the District Line and National Rail services. The area is also well-served by various bus routes, making commuting and exploring London convenient and effortless.

Service Charge: £6218.26 - £4756 SC and £1462.24 reserve fund

Ground Rent: £45

Local Authority: London Borough of Richmond upon Thames

Council Tax Band: F

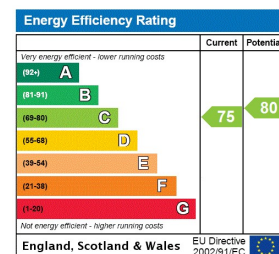

Chestertons Richmond Sales

23a Friars Stile Road
 Richmond
 Surrey
 TW10 6NH
 richmond@chestertons.co.uk
 020 3758 3222
 chestertons.co.uk

Richmond Hill Court, TW10

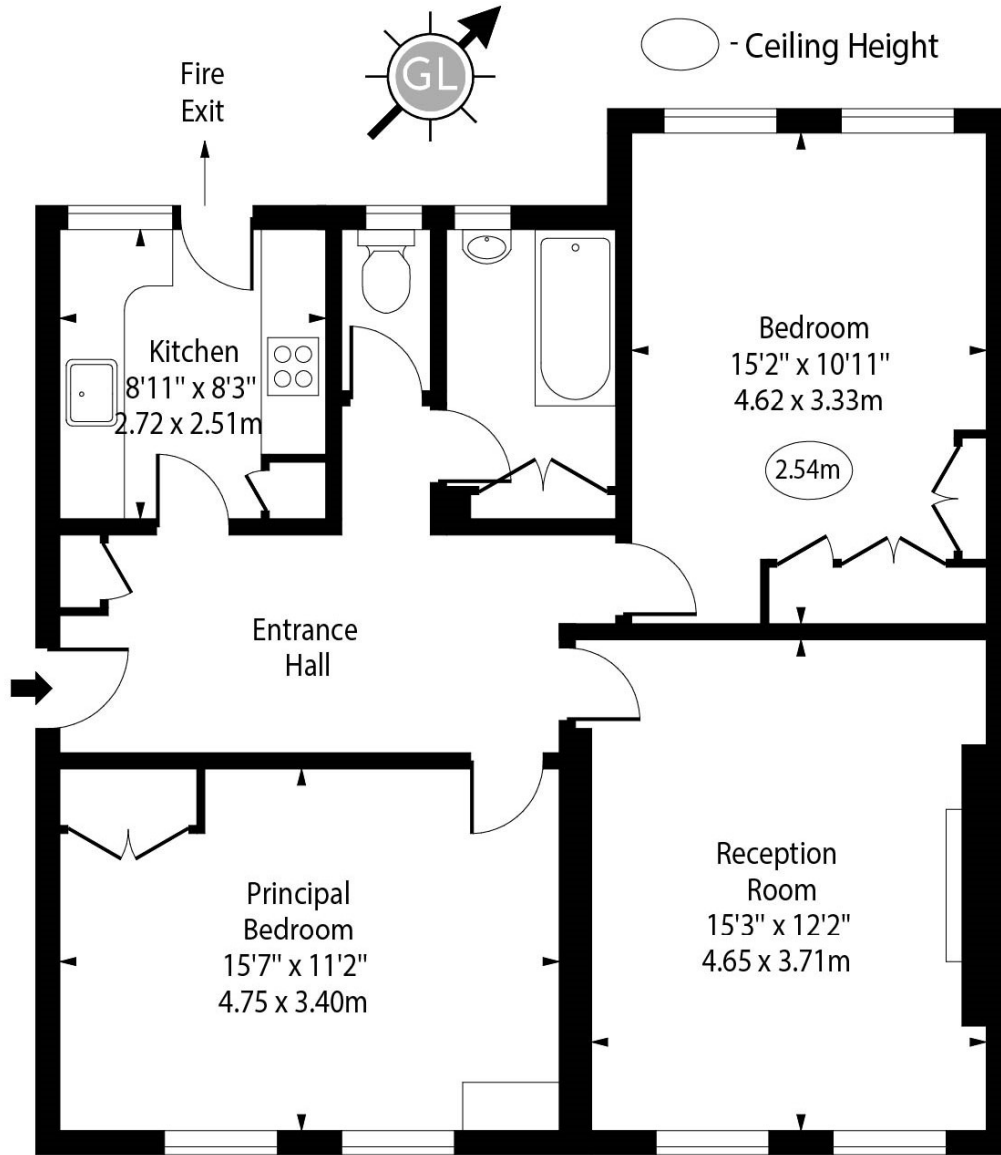

Fifth Floor

Approx Gross Internal Area 840 Sq Ft - 78.04 Sq M

For Illustration Purposes Only - Not To Scale

www.goldlens.co.uk

Ref. No. 025527E

