



Richmond Hill Court

Richmond, TW10

Asking Price £625,000

This charming two-bedroom, first-floor apartment, measuring 797 square feet, is located in the popular development of Richmond Hill Court.

The apartment features a spacious living area filled with natural light and a practical kitchen perfect for daily use and entertaining.

Both bedrooms offer plenty of room, ensuring comfortable living with ample storage space. This wonderful development has the benefit of a newly upgrade tennis court for residents to enjoy

CHESTERTONS



Richmond Hill Court

Richmond, TW10

- No onward chain
- Tennis court
- On site concierge
- Permit parking
- Short walk to Richmond Hill Village
- Very well maintained



Richmond Hill Court is ideally situated for those looking for excellent transport links. Richmond Station is a short walk away, providing National Rail and District Line services to Central London and beyond.

Multiple bus routes connect the development to nearby areas like Twickenham, Kew, and Kingston, while the A316 and M3 offer easy access by car to the city and the surrounding countryside.

The location also offers a range of local amenities, including shops, restaurants, and the beautiful Richmond Park, providing a perfect balance of city living with green spaces. This apartment is a great choice for anyone looking to enjoy all that Richmond has to offer.

Tenure: Leasehold 177 years 11 months

Service Charge: £4,428

Ground Rent: £1,362

Local Authority: London Borough of Richmond upon Thames

Council Tax Band: E

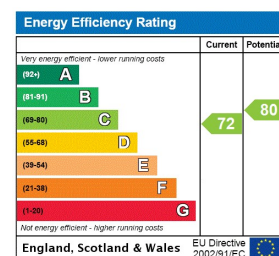

Chestertons Richmond Sales

23a Friars Stile Road

Richmond

Surrey

TW10 6NH

richmond@chestertons.co.uk

020 3758 3222

chestertons.co.uk

Richmond Hill Court,
Richmond,
Surrey, TW10

○ - Ceiling Height

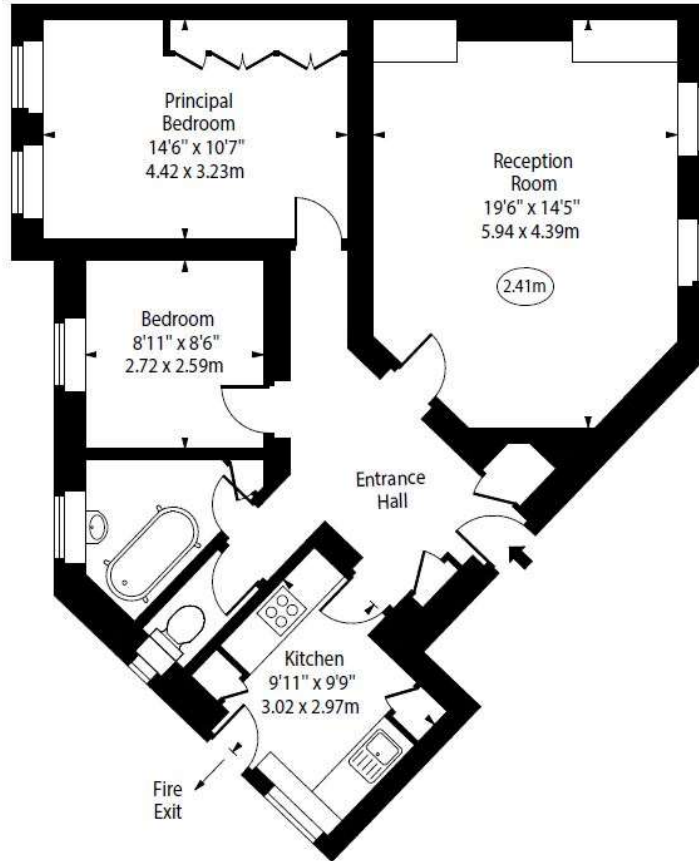

First Floor

Approx Gross Internal Area 822 Sq Ft - 76.36 Sq M

For Illustration Purposes Only - Not To Scale
www.goldlens.co.uk
Ref. No. 025147E

