

A recently built and modern two double bedroom apartment.

Crompton Street, London, W2 1ND

 2  1  1

Guide £3,683 p/m, plus fees may apply



A recently built and modern two double bedroom apartment.

Crompton Street, London, W2 1ND

 2  1  1

Guide £3,683 p/m, plus fees may apply



A recently built and modern two double bedroom apartment.

Crompton Street, London, W2 1ND



Guide £3,683 p/m, plus fees may apply



About this property

This modern and recently built apartment has two double bedrooms plus a study room, and located on the first floor with lift access. Further benefits include family bathroom, and its own private balcony, which is accessed from the reception room. There is a light and secure entry to the building, and access to communal gardens.



A recently built and modern two double bedroom apartment.

Crompton Street, London, W2 1ND

2 1 1

Guide £3,683 p/m, plus fees may apply



Plans

Approx. gross internal floor area
767 sqft

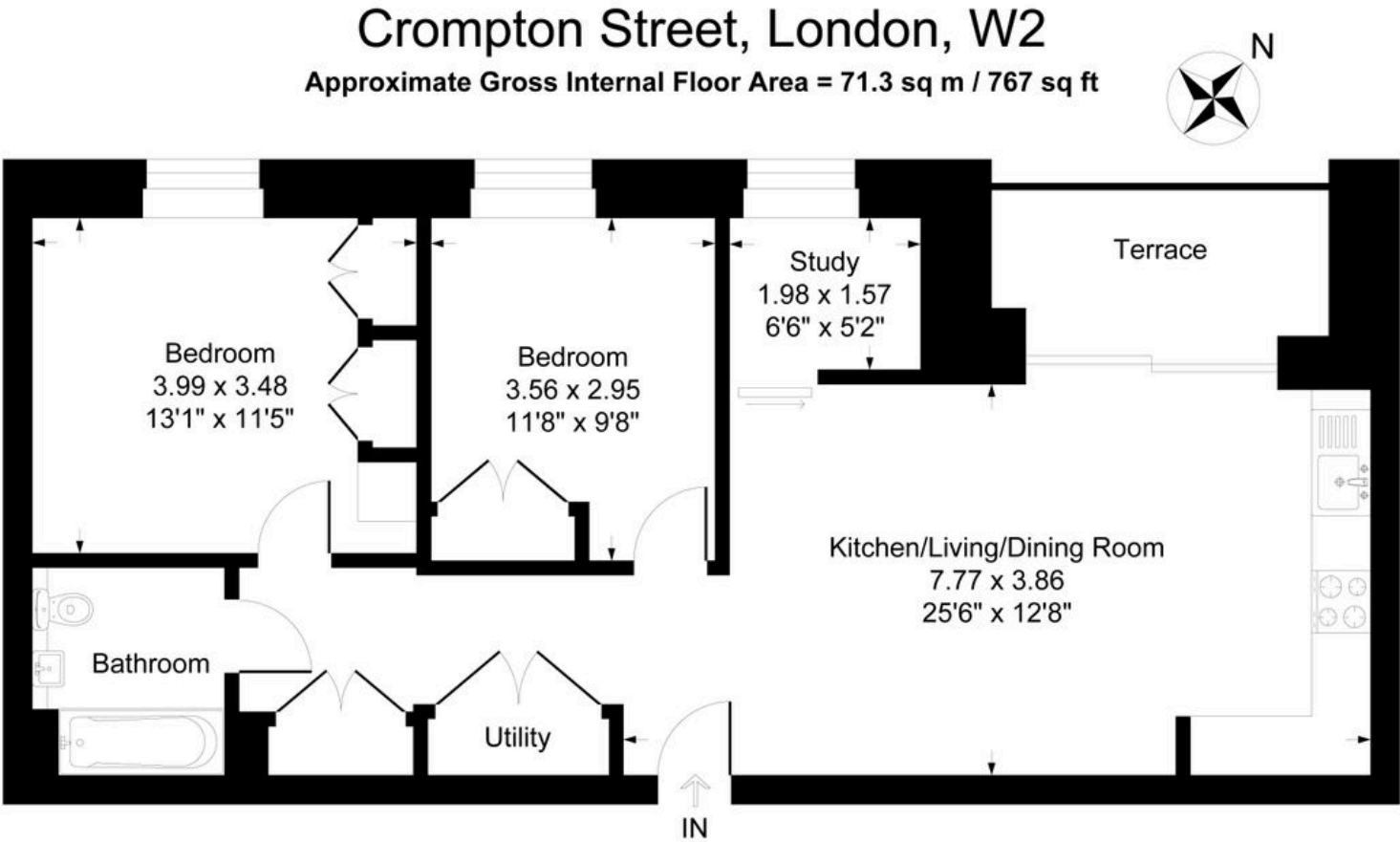

Illustration for identification purposes only, measurements are approximate, not to scale.

A recently built and modern two double bedroom apartment.

Crompton Street, London, W2 1ND

2 1 1

Guide £3,683 p/m, plus fees may apply



Key Information

Local Authority
Westminster City Council

Council Tax
Band = F

Furnishing
Furnished

Available From
10/07/2025

Additional Payments
Deposit: £4,250
Holding Deposit: £850.00

Rent must be paid
monthly in advance

Services & Additional Information

EPC
EPC Rating = B

PROPERTY

| Score | Energy rating | Current | Potential |
|-------|---------------|---------|-----------|
| 92+ | A | | |
| 81-91 | B | 85 B | 85 B |
| 69-80 | C | | |
| 55-68 | D | | |
| 39-54 | E | | |
| 21-38 | F | | |
| 1-20 | G | | |

A recently built and modern two double bedroom apartment.

Crompton Street, London, W2 1ND



2



1



1

Guide £3,683 p/m, plus fees may apply



Enquire



Marian Mohamed

Maida Vale & Little Venice Lettings

+44 (0) 20 3425 5601

marian.mohamed@savills.com

More Information



View on website



View Digital Brochure



Property Search

Viewing strictly by appointment

Published: May 2025

Property Ref: CLV250508

powered by
FluxPro

Important Notice: Savills, their clients and any joint agents give notice that: 1. They are not authorised to make or give any representations or warranties in relation to the property either here or elsewhere, either on their own behalf or on behalf of their client or otherwise. They assume no responsibility for any statement that may be made in these particulars. These particulars do not form part of any offer or contract and must not be relied upon as statements or representations of fact. 2. Any areas, measurements or distances are approximate. The text, images and plans are for guidance only and are not necessarily comprehensive. It should not be assumed that the property has all necessary planning, building regulation or other consents and Savills have not tested any services, equipment or facilities. Prospective tenants must satisfy themselves by inspection or otherwise. Please note that the local area may be affected by aircraft noise, you should make your own enquiries regarding any noise within the area before you make any offer.

*There are different rules and fees for different tenancy types. For details of our fees and charges please go to Savills.co.uk/tenant-fees. For more detailed information read our applicant guide at savills.co.uk/applicant-guide.