



**13 WESTFIELD AVENUE**  
**GOOLE, DN14 6JX**

**£100,000**  
**FREEHOLD**

COMMERCIAL PREMISES FOR SALE OR TO RENT - Ground floor commercial premises extending to approx. 100sqm having a variety of uses subject to the relevant planning being obtained. Immediate vacant possession available.

**EPC:**



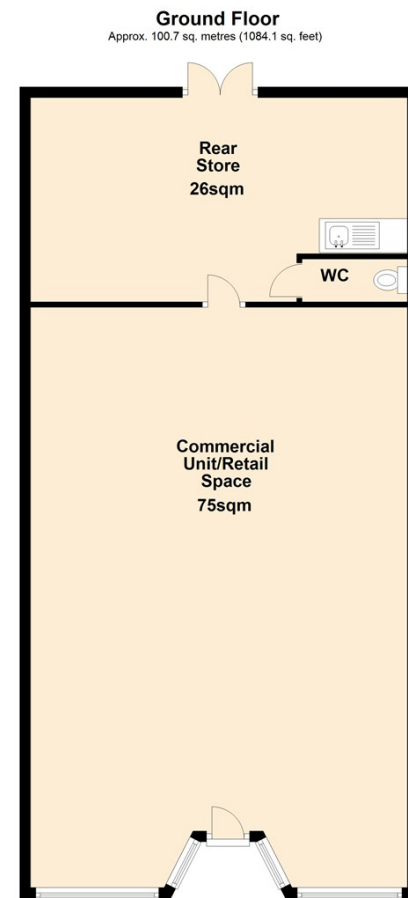

Energy Efficiency Rating		
	Current	Potential
Very energy efficient - lower running costs		
(92 plus) <b>A</b>		
(81-91) <b>B</b>		
(69-80) <b>C</b>		
(55-68) <b>D</b>		
(39-54) <b>E</b>		
(21-38) <b>F</b>		
(1-20) <b>G</b>		
Not energy efficient - higher running costs		
<b>England &amp; Wales</b>	EU Directive 2002/91/EC	

Agents Note: Whilst every care has been taken to prepare these particulars, they are for guidance purposes only. All measurements are approximate and are for general guidance purposes only and whilst every care has been taken to ensure their accuracy, they should not be relied upon and potential buyers/tenants are advised to recheck the measurements

Thorne Commercial  
94 King Street  
Thorne  
Doncaster  
South Yorkshire  
DN8 5BA

01405 816893  
thorne@screetons.co.uk  
www.screetons.co.uk

