

St. Marys Road, Evesham, WR11 4EG
Evesham

Guide Price
£215,000

Bedrooms: 2

Bathrooms: 1

Receptions: 1

Offered with no onward chain, this attractive two-bedroom semi-detached home is situated on St Marys Road, Evesham, within easy reach of local amenities and transport links. The property provides an ideal opportunity for first-time buyers, downsizers, or investors looking for a well-presented home in a sought-after location.

The accommodation is thoughtfully arranged and includes a welcoming sitting room, together with a kitchen/diner that offers plenty of room for family meals and entertaining. Upstairs, there are two generous double bedrooms, complemented by a modern family bathroom.



Externally, the property boasts off-road parking to the front, providing convenient private parking. The front garden is neatly presented and adds to the home's kerb appeal, giving a warm and welcoming first impression. To the rear, a good-sized private garden provides a wonderful outdoor area, ideal for children to play, for gardening enthusiasts, or for hosting summer barbecues and dining alfresco.

With its well-balanced accommodation, private outdoor space, and excellent location, this chain-free home offers real versatility and value. It is ideally suited for anyone seeking a well-presented property in the heart of Evesham—a historic riverside town with a thriving community, great schools, and strong transport links to Worcester, Cheltenham, and beyond.



GROUND FLOOR
297 sq.ft. (27.6 sq.m.) approx.

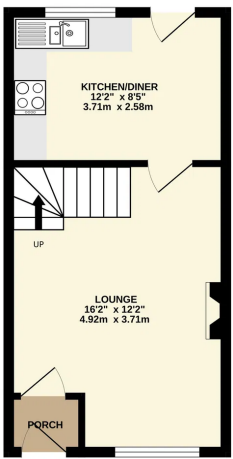

1ST FLOOR
300 sq.ft. (27.8 sq.m.) approx.

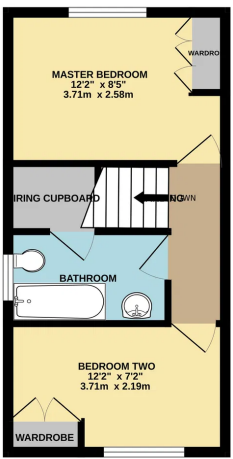

TOTAL FLOOR AREA: 597 sq.ft. (55.4 sq.m.) approx.
Whilst every effort has been made to ensure the accuracy of the floorplans contained herein, measurements of plots, rooms, rooms etc. may vary from the above and are approximate and not intended to be relied upon for any purpose other than a general guide. The services, systems and appliances shown have not been tested and no guarantee as to their operability or efficiency can be given.
Made with Hoxby 02/25