



CHATTERTON

ESTATE AGENTS LTD

2 Broadway Close, Fladbury

£500,000

3 1 2



Upon entering the home, you'll find a well-organised and spacious interior. The kitchen-diner, equipped with modern appliances, ample counter and storage space provides a comfortable area for family meals and entertaining. The bright living room with large window to the front has a log burner and French doors to the rear.

This home offers three large double bedrooms, each designed for comfort and effortlessly combines character features with modern energy efficiency. The solar panels and thermally heated water plus the log burner mean that the bills are kept to a minimum. The family bathroom features modern fixtures and fittings.

Situated on a large plot, the house enjoys ample outdoor space. A large garage and dedicated parking areas add to the convenience.



A picturesque village situated on the banks of the River Avon, Fladbury offers a range of excellent amenities from a Primary School to a Shop, a Church, an excellent Butchers renowned for award winning pies, two Public Houses and a social sporting calendar involving cricket, tennis and canoeing/bell boating. Fladbury is well situated between the market towns of Pershore and Evesham which provide everyday shopping whilst broader shopping and services are available in Worcester, Stratford-upon-Avon and Cheltenham. Evesham Railway station is close by with excellent train links and there are good links to the M5, M40 and M42 networks.



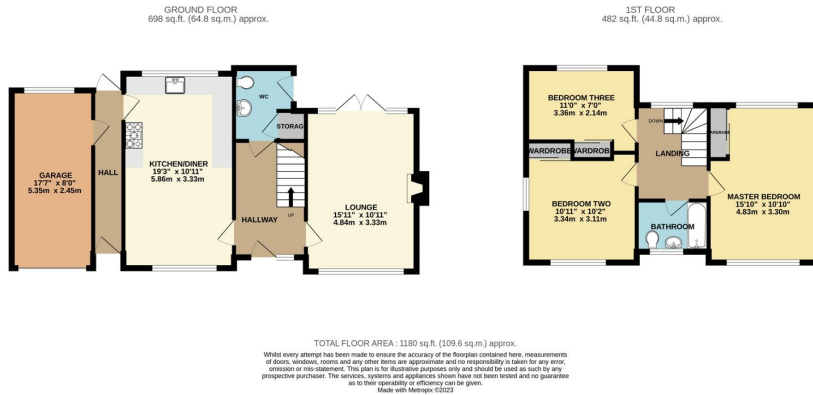

- Fladbury's charming location provides a peaceful and picturesque setting
- Living room with doors to garden
- Family bathroom
- Double-glazed windows contribute to energy efficiency
- The property sits on a generous plot
- Superb modern kitchen diner provides a peaceful and picturesque setting
- Three large double bedrooms
- Central heating, ensuring year-round comfort
- The large garage offers ample space for parking vehicles and additional storage or workshop space

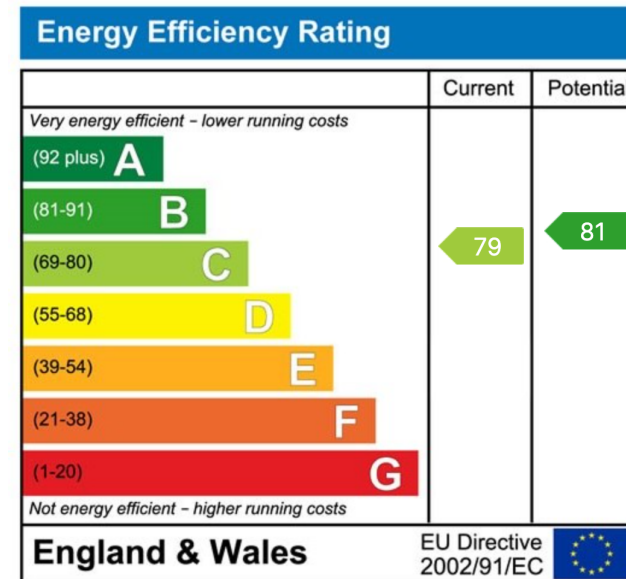

Sunnydale, 34 Weston Road, Bretforton, Worcestershire WR11 7HW

Telephone: 01386 833969 ■ Email: joe@chattertonestates.co.uk ■ www.chattertonestates.co.uk