

£230,000

6 Plover Drive, March, PE15 9HY



To arrange a viewing call us now on 01354 701000

Boasting a fabulous amount of parking for multiple vehicles plus a lovely south west facing garden this home is all about the outside space! Accommodation comprises a good size kitchen/diner, dual aspect lounge, ground floor WC, three bedrooms and bathroom. Viewing is a must on this home being offered with no chain! EPC C

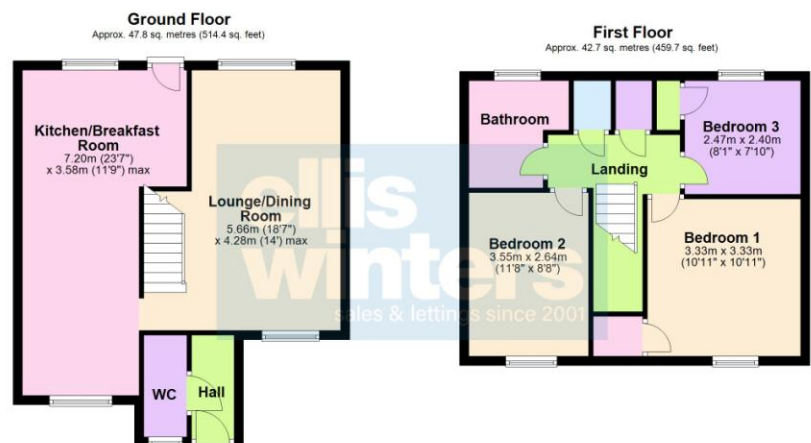

Total area: approx. 90.5 sq. metres (974.0 sq. feet)

£230,000

6 Plover Drive, March, PE15 9HY



Boasting a fabulous amount of parking for multiple vehicles plus a lovely south west facing garden this home is all about the outside space! Accommodation comprises a good size kitchen/diner, dual aspect lounge, ground floor WC, three bedrooms and bathroom. Viewing is a must on this home being offered with no chain!

Ground Floor

Hall
Radiator.

WC
Fitted with wash hand basin and WC, window to front, radiator.

Lounge/Dining Room
5.66m (18'7") x 4.28m (14') max
Window to front and rear, two radiators, stairs to first floor and landing.



Kitchen/Breakfast Room
7.20m (23'7") x 3.58m (11'9") max
Wall and base units with integral oven, hob and hood, plumbing for washing machine, one and half bowl sink unit with mixer tap, window to front and rear, two radiators, door to garden.



First Floor & Landing
Storage cupboard, further cupboard housing gas fired boiler.

Bedroom 1
3.33m (10'11") x 3.33m (10'11")
Window to front, radiator, cupboard/wardrobe.



Bedroom 2
3.55m (11'8") x 2.64m (8'8")
Window to front, radiator.

Bedroom 3
2.47m (8'1") x 2.40m (7'10")
Window to rear, radiator, cupboard/wardrobe.



Bathroom

Fitted with a three piece suite comprising bath with mixer tap shower, wash hand basin and WC, window to rear, radiator.

Outside

To the front of the property the triple width driveway is laid mainly to gravel and provides off road parking. The south west facing rear garden is laid to patio and lawn with flower and shrub borders with garden shed.

Freehold

Council tax band B

Ellis Winters has not tested any apparatus, equipment fitting or services and so cannot verify that they are in working order. The buyer is advised to obtain verification from their solicitor or surveyor. Floor plans are for representational purposes only and are not to scale.

Ellis Winters & Co 52 High Street, March, Cambridgeshire, PE15 9JR
Tel: 01354 701000 Email: info@elliswinters.co.uk www.elliswinters.co.uk