

£215,000

30 Russell Avenue, March, PE15 8EN



To arrange a viewing call us now on 01354 701000

Offered with no chain, this good size family home has much to offer including lounge with open fire, generous kitchen/diner, utility room & WC, three bedrooms and first floor bathroom. Outside there is off road parking and a pretty garden. Viewing is a must for anyone looking for that extra space! EPC D

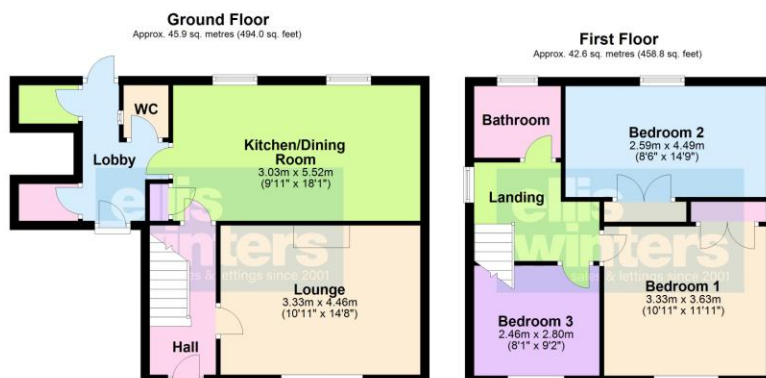

£215,000

30 Russell Avenue, March, PE15 8EN



Ground Floor

Hall

Stairs to first floor and landing, radiator, window to side.

Lounge

4.46m (14'8") x 3.33m (10'11")

Window to front, brick built open fireplace, radiator, polished floorboards.

Outside

To the front and side there is ample parking which is laid to gravel. The rear garden is laid to patio and lawn with flower and shrub borders.

Freehold

Council tax band A



Kitchen/Dining Room

5.52m (18'1") x 3.03m (9'11")

Fitted with wall and base units with sink unit and double drainer, plumbing for dishwasher, electric cooker point, gas fired boiler, two windows to rear, radiator, pantry cupboard.

Ellis Winters has not tested any apparatus, equipment fitting or services and so cannot verify that they are in working order. The buyer is advised to obtain verification from their solicitor or surveyor. Floor plans are for representational purposes only and are not to scale.

Lobby

Door to cupboard, utility cupboard with plumbing for washing machine, door to front and rear.



WC

Window, WC, radiator.

First Floor & Landing

Window to side, radiator, access to loft with light, airing cupboard housing hot water tank and shelving.

Bedroom 1

3.63m (11'11") x 3.33m (10'11")

Window to front, double door wardrobe, radiator.



Bedroom 2

4.49m (14'9") x 2.59m (8'6")

Window to rear, radiator, double door wardrobe.

Bedroom 3

2.80m (9'2") x 2.46m (8'1")

Window to front, radiator, over stairs cupboard.



Bathroom

Fitted with a three piece suite comprising bath with electric shower over, WC and wash hand basin, radiator, window to rear.

Ellis Winters & Co 52 High Street, March, Cambridgeshire, PE15 9JR

Tel: 01354 701000 Email: info@elliswinters.co.uk www.elliswinters.co.uk