

£350,000

25 Gresley Way, March, PE15 8QA



To arrange a viewing call us now on 01354 701000

Offered with no chain this lovely bungalow sits on a fabulous plot in a cul-de-sac location. Accommodation comprises kitchen/breakfast room with central island and integral appliances, lounge/diner with vaulted ceiling and bi-fold doors, three bedrooms with ensuite to master and family bathroom. Outside there is garage and parking plus South facing garden which wraps around the side and rear. EPC D

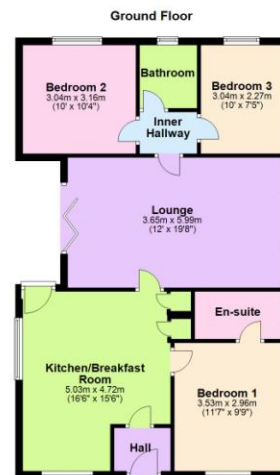

£350,000

25 Gresley Way, March, PE15 8QA



Hall
Radiator.

Kitchen/Breakfast Room
5.03m (16'6") x 4.72m (15'6")
Fitted with wall and base units with central island having breakfast bar each end, integral oven, microwave oven, hob, hood and dishwasher, one and half bowl sink unit with mixer tap, window to front and side, cupboard housing gas fired boiler, further cupboard, radiator, door to garden.

Outside

To the front of the property there is parking and garage. A gated side access leads to the South facing side and rear garden which is laid mainly to lawn.

Freehold
Council tax band C

Ellis Winters has not tested any apparatus, equipment fitting or services and so cannot verify that they are in working order. The buyer is advised to obtain verification from their solicitor or surveyor. Floor plans are for representational purposes only and are not to scale.



Lounge
5.99m (19'8") x 3.65m (12')
Vaulted ceiling, fire surround, two windows to side, two radiators, bi-fold doors to garden.



Bedroom 1
3.53m (11'7") x 2.96m (9'9")
Window to front, radiator, access to loft.

En-suite
Refitted with a three piece suite comprising walk in shower with rainfall head, vanity wash hand basin and WC, window to side, radiator.

Inner Hallway
Access to loft.



Bedroom 2
3.16m (10'4") x 3.04m (10')
Window to rear, radiator.

Bedroom 3
3.04m (10') x 2.27m (7'5")
Window to rear, radiator.

Bathroom
Refitted with a three piece suite comprising roll top bath with mixer tap shower head, wash hand basin and WC, window to rear, heated towel rail, cupboard with power and plumbing for washing machine.



Ellis Winters & Co 52 High Street, March, Cambridgeshire, PE15 9JR
Tel: 01354 701000 Email: info@elliswinters.co.uk www.elliswinters.co.uk