

£190,000

10 Haslehurst Close, March, PE15 9BB



To arrange a viewing call us now on 01354 701000

A great opportunity for a family to put their own stamp on this semi detached home offered with NO CHAIN. Accommodation comprises lounge with SEPARATE DINING ROOM, kitchen, THREE BEDROOMS and first floor bathroom. Outside there is AMPLE PARKING, carport and SOUTH FACING REAR GARDEN. EPC D

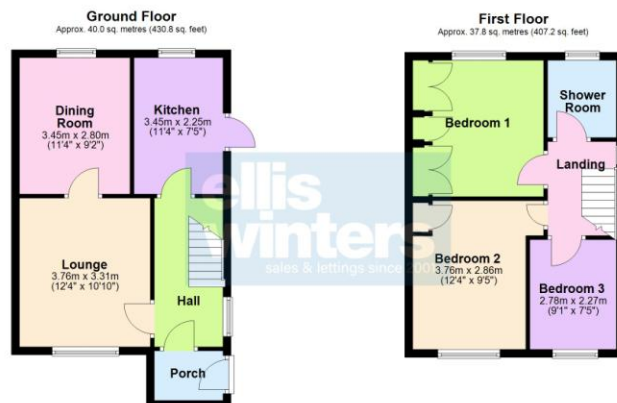

Total area: approx. 77.8 sq. metres (837.9 sq. feet)

£190,000

10 Haslehurst Close, March, PE15 9BB



Ground Floor

Porch
Door to:

Hall
Window to side, radiator, stairs to first floor and landing.

Lounge
3.76m (12'4") x 3.31m (10'10")
Window to front, radiator, door to:



Dining Room
3.45m (11'4") x 2.80m (9'2")
Window to rear, radiator.

Kitchen 3.45m (11'4") x 2.25m (7'5")
Wall and base units with integral double oven and hob, gas fired boiler, sink unit with mixer tap, plumbing for washing machine, window to rear, door to side.



First Floor & Landing
Window to side, access to loft with light and part boarded.

Bedroom 1
Fitted with wardrobes to one wall, window to rear, radiator.

Bedroom 2
3.76m (12'4") x 2.86m (9'5")
Window to front, cupboard housing hotwater tank (seller believe this is also heated via the solar power but we await paperwork on this,) radiator.



Bedroom 3
2.78m (9'1") x 2.27m (7'5")
Window to front, radiator.



Shower Room
Fitted with a three piece suite comprising shower unit, wash hand basin and WC, window to rear, radiator.

Outside

To the front of the property the brick weave driveway provides ample off road parking and leads to the carport at one side. A gated side access leads to the South facing rear garden which is laid mainly to patio with outside water supply, shed, greenhouse and two brick built stores.

Freehold
Council tax band B

Ellis Winters has not tested any apparatus, equipment fitting or services and so cannot verify that they are in working order. The buyer is advised to obtain verification from their solicitor or surveyor. Floor plans are for representational purposes only and are not to scale.

Ellis Winters & Co 52 High Street, March, Cambridgeshire, PE15 9JR
Tel: 01354 701000 Email: info@elliswinters.co.uk www.elliswinters.co.uk