

£320,000

2 Windsor Drive, March, PE15 8DF



To arrange a viewing call us now on 01354 701000

Located in a POPULAR AREA and boasting GOOD SIZE ROOMS THROUGHOUT this detached bungalow has much to offer including GENEROUS LOUNGE/DINER, kitchen plus UTILITY ROOM, three well proportioned bedrooms WETROOM PLUS FURTHER WC. Outside there is ample parking GARAGE and enclosed rear garden. EPC D

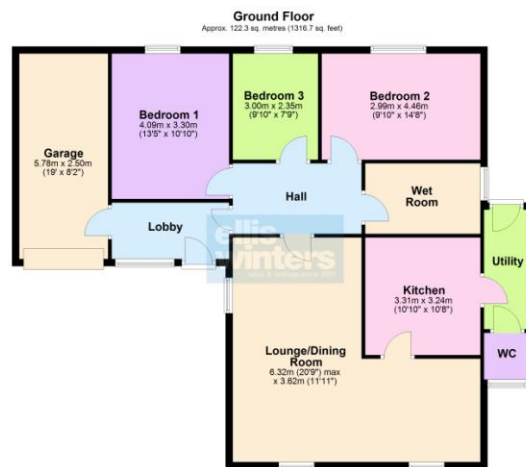

£320,000

2 Windsor Drive, March, PE15 8DF



Lobby
Window to front, door to garage.

Freehold
Council tax band D

Hall
Airing cupboard housing hot water tank.

Lounge/Dining Room
6.32m (20'9") max x 3.62m (11'11") L
Shaped Room
Two windows to front, window to side, two radiators, ornamental fireplace.

Ellis Winters has not tested any apparatus, equipment fitting or services and so cannot verify that they are in working order. The buyer is advised to obtain verification from their solicitor or surveyor. Floor plans are for representational purposes only and are not to scale.



Kitchen
3.31m (10'10") x 3.24m (10'8")
Fitted with wall and base units with electric cooker point, sink unit with mixer tap, door to:

Utility
Window to side, door to rear garden,
plumbing for washing machine.

WC
Fitted with a two piece suite comprising WC
and wash hand basin, window to front.



Bedroom 1
4.09m (13'5") x 3.30m (10'10")
Fitted with wardrobes to one wall, window to rear,
radiator.

Bedroom 2
4.46m (14'8") x 2.99m (9'10")
Window to rear, radiator.



Bedroom 3 3.00m (9'10") x 2.35m (7'9")
Window to rear, radiator.

Wet Room
Fitted with shower, wash hand basin and
WC, window to side, radiator.

Outside
To the front of the property the garden is laid
mainly to lawn with a driveway at one side
providing off road parking leading to the
garage with up and over door and houses the
gas fired boiler. The rear garden is laid to
mainly to lawn with flower and shrub borders.



Ellis Winters & Co 52 High Street, March, Cambridgeshire, PE15 9JR
Tel: 01354 701000 Email: info@elliswinters.co.uk www.elliswinters.co.uk