



Long Ridings Avenue, Hutton

Long Ridings Avenue Hutton

£610,000

Located in the sought-after Long Ridings development in Hutton, this charming four-bedroom chalet-style semi-detached bungalow is the perfect family home. Ideally located for easy access to Shenfield Broadway, the mainline railway station, and local schools (subject to acceptance), this property is an excellent choice for both families and commuters alike. Upon entering, you'll find two well-appointed bedrooms on the ground floor, accompanied by a family bathroom. The heart of the home boasts a spacious lounge that seamlessly connects to a modern fitted kitchen complete



with appliances as well as a large conservatory, overlooking the expansive garden. Upstairs there are two additional bedrooms, including a main bedroom that benefits from an en-suite bathroom. The property is further enhanced by a detached garage accessible via a shared driveway, along with parking available to the front. Offered for sale with no onward chain. EPC D.

Entrance Hall

Lounge 14' 5" x 10' 3" > 8' 7" (4.39m x 3.12m > 2.65m)

Kitchen 11' 5" x 8' 8" > 6' 8" (3.48m x 2.64m > 2.07m)

Conservatory 21' 0" x 8' 2" (6.40m x 2.49m)

Ground Floor Bedroom One 12' 1" x 10' 3" (3.68m x 3.12m)

Ground Floor Bedroom Two 8' 2" x 6' 8" (2.49m x 2.03m)

Family Bathroom

First Floor Bedroom One 13' 1" x 8' 4" to front of fitted wardrobes > 6' 6" (3.98m x 2.54m > 2m)

Ensuite Shower

First Floor Bedroom Two 11' 6" x 9' 4" > 8' 8" (3.50m x 2.84m > 2.6m)

Garage











Energy Efficiency Rating

	Current	Potential
Very energy efficient - lower running costs		
(92+) A		
(81-91) B		
(69-80) C		77
(55-68) D	67	
(39-54) E		
(21-38) F		
(1-20) G		
Not energy efficient - higher running costs		
England & Wales	EU Directive 2002/91/EC	

WWW.EPC4U.COM

Council Tax Band D

148 Hutton Road
Shenfield

Essex CM15 8NL

01277 225191

admin@wnproperties.co.uk

wnproperties.co.uk



Ground Floor

Approx. 57.6 sq. metres (620.2 sq. feet)

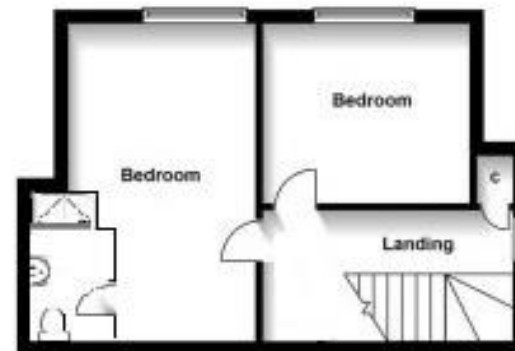

First Floor

Approx. 30.3 sq. metres (326.0 sq. feet)

Total area: approx. 87.9 sq. metres (946.2 sq. feet)

Whilst every attempt has been made to ensure the accuracy of the floor plan, measurements of doors, windows and any other items are approximate and no responsibility is taken for any error, omission, or mis-statement. This plan is for illustrative purposes only and should be used as such by any prospective purchaser. The services, systems and appliances shown have not been tested and no guarantee as to their operability or efficiency can be given.
Plan produced using PlanUp.

Every effort has been made to ensure the complete accuracy of these particulars, however they cannot be guaranteed. Always check before agreeing to purchase. This includes checking on the existence of relevant permissions, services/utilities, fixtures, fittings and appliances which have not been tested by WN Properties and there is no guarantee that they are in working order or fit for purpose. Photographs are for general information and it cannot be inferred that any items shown are included in the sale or within the ownership of the seller and therefore must be verified by your legal representative. No assumptions can be made from any description or image, relating to the type of construction, structural condition or the surroundings of the property. All measurements are approximate and any drawings/floorplans provided are for general guidance and are not to scale. WN Properties recommend ancillary service providers from time to time to assist you with your purchase. You are not under any obligation to use the services of any of the recommended providers, though should you accept our recommendation the provider may pay us a Referral Fee. The Referral Fee is separate from your obligation to pay your fees or commission.