

Councillor Street, SE5

£553 Per week

A newly refurbished two double bedroom flat located just off Camberwell New Road. The property is comprises, two double bedrooms, with a seperate office, wood flooring throughout, modern bathroom with shower over bath and a good sized open-plan kitchen reception. There property also benefits from private access to a patio garden.

Just 0.7 miles from Oval (Northern Line) and under a mile from Loughborough Junction and Denmark Hill stations, with Elephant & Castle nearby (1.6 miles). A short walk from the open green spaces of Myatt's Fields Park, offering tennis courts and a peaceful escape from city life.

Features

- Two Double Bedrooms
- Separate Office Space
- Wood Flooring
- Private Patio Garden
- Open-Plan Kitchen/Reception
- Newly Refurbished

Councillor Street,
London, SE5

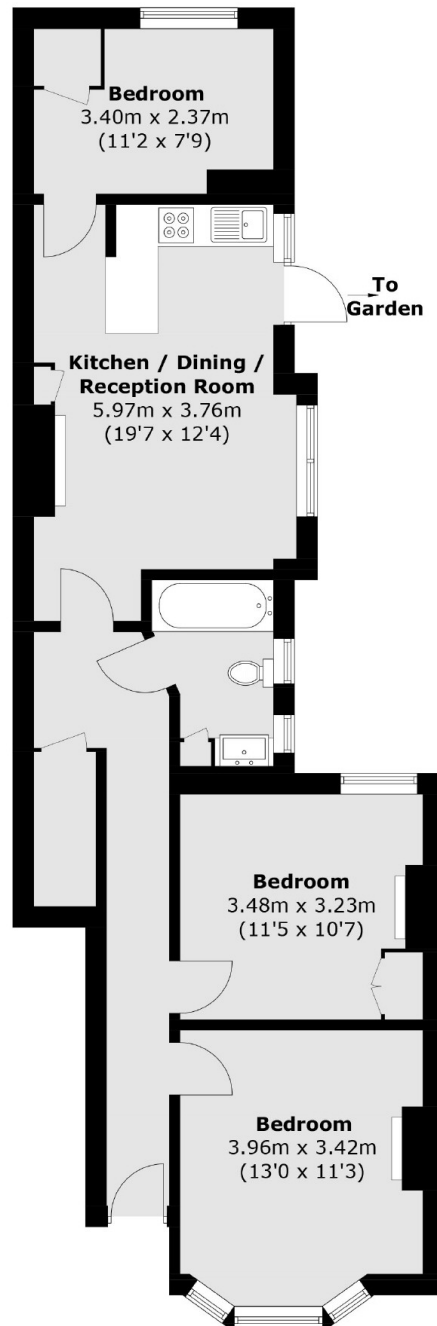

Total area (approx.): 71.3 sq. m (767.5 sq. ft)

Dexters

Vauxhall
377-379 Kennington Lane
London
SE11 5QY
Lettings
020 7793 8111

Energy Rating: D. We aim to make our particulars both accurate and reliable. However they are not guaranteed; nor do they form part of an offer or contract. If you require clarification on any points then please contact us, especially if you're traveling some distance to view. Please note that appliances and heating systems have not been tested and therefore no warranties can be given as to their good working order.

 **RICS** | Regulated
Estate Agent
and Letting Agent

[dexters.co.uk](https://www.dexters.co.uk)