



Regent Terrace, SW8

£403 Per week

A spacious one bedroom second floor flat with large living room, open plan kitchen, tiled bathroom, double bedroom and ample storage. Ideal for a single or professional couple.

Just off the popular Fentiman Road within sight of the famous Vauxhall Park, and many nearby pubs such as The Fentiman Arms and the Canton Arms.

Features

- One Double Bedroom
- Modern Kitchen
- Wood Floors Throughout
- Close to Vauxhall Park
- Private Development
- Great Location

Regent Terrace, London, SW8

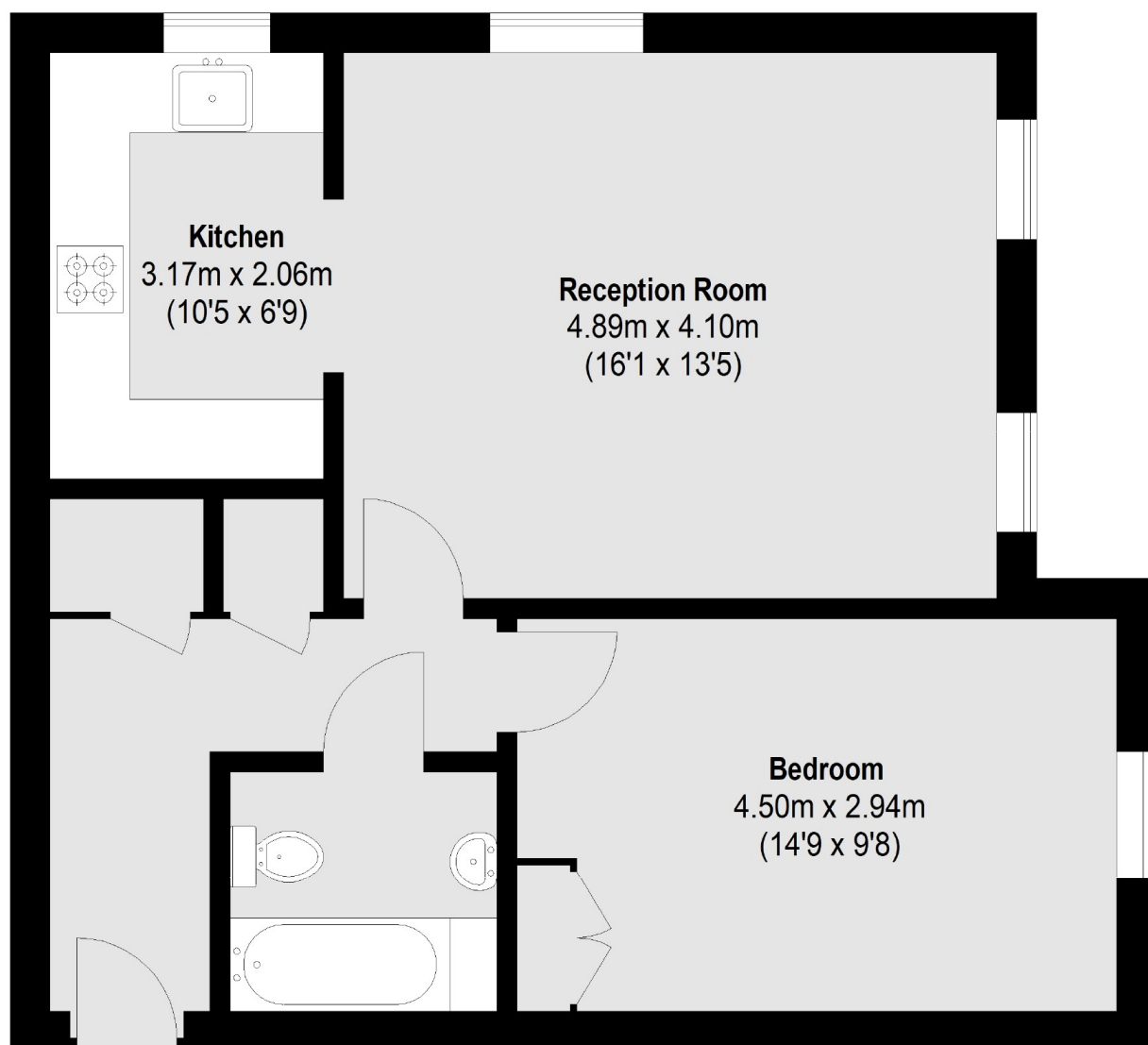

Total area (approx.): 53.94 sq. m (581 Sq. ft)