



## South Lambeth Road, SW8

£692 Per week

A three bedroom apartment set within this Victorian mansion block in Vauxhall. Great attention to detail has gone into restoring period features and the property is complete with feature fireplaces in each of the rooms and exposed brickwork. The fitted kitchen has built in appliances and a granite work surface, furthermore there are high ceilings and solid oak flooring throughout

Exceptionally well located for transport, being just moments from Vauxhall mainline station, the Victoria Line and many bus services. Residents can enjoy the amenities of Vauxhall Park and Vauxhall Conservation Area with Bonnington Square next door.

### Features

- Three Bedrooms
- One Bathroom
- Close To Transport
- High Ceilings
- Wood Flooring
- Great Condition

South Lambeth Road,  
London, SW8

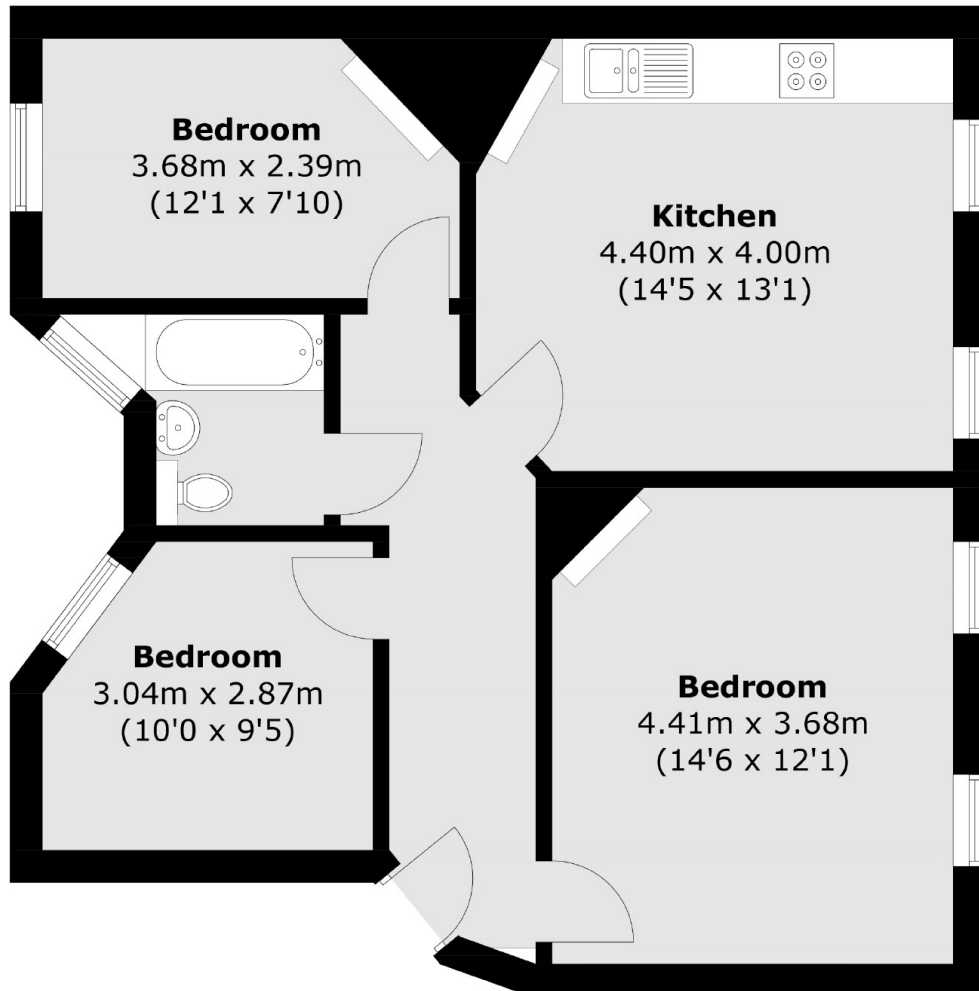

Total area (approx.): 65.5 sq. m (705.0 sq. ft)