



Clerks Croft, Bletchingley

£625,000





“

Living in Bletchingley is fantastic. The community spirit is the best and I have made many friends here. Clerks Croft is a beautiful location - hearing the church bells and the birds is a lovely asset along with my garden gate leading straight onto the field to go for a stroll and walk the dogs. The views of the countryside are breathtaking and one of many reasons I made this my home.

”



Guide Price £625,000 - £650,000

Located in the peaceful cul-de-sac of Clerks Croft, this beautifully renovated property blends historical charm with modern living. Originally part of an old workhouse, the area was redeveloped in 1983 into stunning detached and link-detached homes, many of which, like this one, retain some of the original brickwork. Upon entering, you'll find a convenient downstairs toilet to your left, while the right leads to a recently renovated kitchen, featuring quartz worktops, integrated appliances, and a striking Rangemaster oven as its centerpiece. The kitchen overlooks the quiet road, providing a sense of serenity.

The rear of the property boasts a spacious reception room, enhanced by exposed beams and a cozy log burner, creating a warm, inviting atmosphere. The room flows seamlessly into an extension that serves as the dining area, which is bathed in natural light and offers views of the beautifully landscaped garden. The garden, perfect for nature lovers, has direct access to open fields, making it ideal for dog walking and outdoor activities. The boiler, installed just a year ago, ensures modern efficiency.

Upstairs, there are three generously sized bedrooms. Two are large doubles, and the principal bedroom benefits from an en-suite shower room. The family bathroom services the remaining two bedrooms. Throughout the home, there are charming character features, all fully renovated to a high standard. Completing the property is a garage and driveway, providing ample parking. Located in the picturesque village of Bletchingley, the home is close to traditional pubs, boutique coffee shops, and a range of scenic nature walks.



Need to know

- Located in the quiet cul-de-sac of Clerks Croft, this property combines historical charm with modern updates.
- Originally part of a workhouse, it was redeveloped in 1983, preserving some original brickwork.
- The renovated kitchen features quartz worktops, fitted appliances, and a Rangemaster oven, overlooking the peaceful road.
- A large reception room with exposed beams and a log burner creates a cozy living space.
- An extension serves as a bright dining area, opening onto a beautifully landscaped garden.
- The garden has direct access to open fields, perfect for dog walkers and nature lovers.
- The property has three bedrooms, including two large doubles, with the principal bedroom featuring an en-suite shower room.
- A family bathroom services the remaining bedrooms, all well-proportioned.
- Boiler has been serviced annually
- The home includes a garage and driveway, located in the scenic village of Bletchingley with pubs, coffee shops, and nature walks nearby.



First Floor

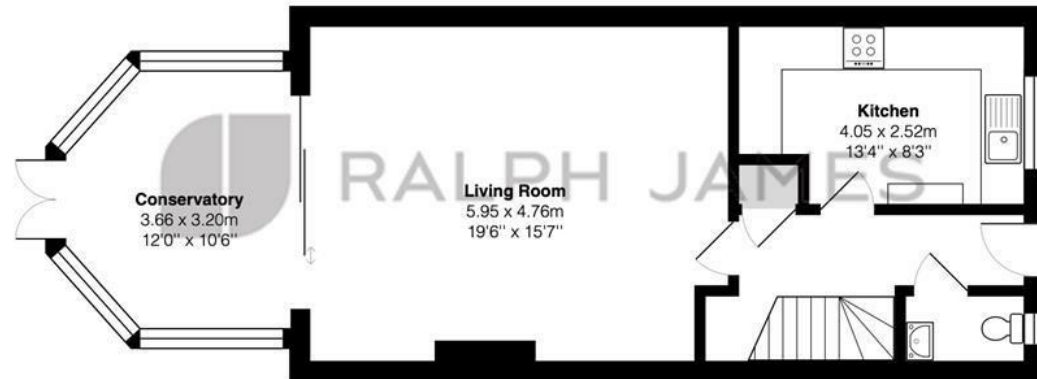

Ground Floor

Clerks Croft, Bletchingley, Redhill

Total Area: 107.6 m² ... 1158 ft²

FOR ILLUSTRATIVE PURPOSES ONLY.

Whilst every attempt has been made to ensure the accuracy of the floor plan shown, all measurements, positioning, fixtures, features, fittings and any other data shown are an approximate interpretation for illustrative purposes only and are not to scale.

No responsibility is taken for any error, omission, miss-statement or use of data shown.

The above statement applies to both 'Still Moving London LTD' and the Company or individual displaying this floor plan.

Unauthorised reproduction prohibited.

Â© Still Moving London LTD (www.stillmoving.london)



Interested?

redhill@ralphjames.co.uk
01737 765 555

ralphjames.co.uk